

**SCHOOLCRAFT COUNTY
PEER GROUP APPROVED
DATE 10/10/00 TBB**

**SURVEY &
REMONUMENTATION**

FEB 08 2001

**LAND CORNER RECORDATION CERTIFICATE
Filing Requirement of Act 74, Mich. P.A. 1970**

SECTION

For corners in

Schoolcraft
(County)

Located In:

Corner Code #

SIGRID HEDBERG 1P
SCHOOLCRAFT CO. REGISTER
Page 1 of 1 LC 4/400
JLV Date 12/19/2000 Time 11:53:37

- | | | |
|------------------------------------|---------------------------|-----------|
| 1. Public Land Survey | T <u>42N</u> R <u>14W</u> | <u>J9</u> |
| | T ___ R ___ | _____ |
| | T ___ R ___ | _____ |
| | T ___ R ___ | _____ |
| 2. Property Controlling in Section | S ___ T ___ R ___ | _____ |
| | S ___ T ___ R ___ | _____ |
| 3. Miscellaneous Property in Sec. | S ___ T ___ R ___ | _____ |
| | S ___ T ___ R ___ | _____ |

Register of Deeds Stamp & File Number

4. Lot No. _____, Recorded Plat _____
5. Private Claims _____

I, Thomas P. O'Brien, in a field survey on 11/6/00, ~~19~~ do hereby state that under requirements of P.A. 74, Michigan P.A. of 1970, the corner points mentioned in lines 1 and 2 above were in conformance with regulations and rules therefore as required in the current manual of survey instructions of the United States Department of the Interior, Bureau of Land Management or by a decree of a Court of Law and /or that the corner points mentioned in lines 3, 4 and 5 above were in conformance with the rules of the Michigan Board of Land Surveyors or by a Decree of a Court of Law; established, re-established, monumented, recovered, found as expressed below:

NOTE: Not more than 2 corners, all in the same town and range, may be recorded on this certificate.

	A	B	C	D	E	F	G	H	I	J	K	L	M
1													
2		6		5		4		3		2		1	
3													
4		7		8		9		10		11		12	
5													
6		18		17		16		15		14		13	
7													
8		19		20		21		22		23		24	
9													
10		30		29		28		27		26		25	
11													
12		31		32		33		34		35		36	
13													

A. Description of original monument and accessories and/or subsequent restoration:

April 8, 1851 Algernon Merryweather, DS set 1/4 post Birch 10 in N55E 21 links Balsam 4 in S45W 3 links.

B. Description of corner evidence found and/or method applied in restoring or reestablishing corner:

Nov.6, 2000 Thomas P. O'Brien, PS set corner at proportionate East and West distance in centerline of existing gravel road.

C. Description of monument for corner and accessories established to perpetuate locating the position of the corner:

Schoolcraft County monument stamped to identify.

Witnesses:

- Corner fence post N12°W 32.47'
- 6" Spruce S55°W 51.0'
- 4" Spruce S29°W 60.37'
- 8" Cedar S7°E 88.67'
- Carsonite post N5°E.20.0'

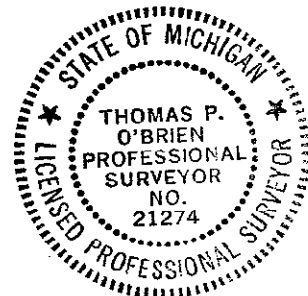

Signed by Thomas P. O'Brien
21274
Surveyor's Michigan License No. _____

Date Dec.11, 2000

LIBER 4 PAGE: 400