

**SCHOOLCRAFT COUNTY
PEER GROUP APPROVED**

DATE 10/10/00 JOB

**SURVEY &
REMONUMENTATION**

FEB 08 2001

**LAND CORNER RECORDATION CERTIFICATE
Filing Requirement of Act 74, Mich. P.A. 1970**

For corners in

Schoolcraft
(County)

Located In:

Corner Code #

SECTION

1. Public Land Survey

T 42NR14W

M5

T R

T R

T R

T R

2. Property Controlling
in Section

S T R

S T R

3. Miscellaneous
Property in Sec.

S T R

S T R

SIGRID HEDBERG

SCHOOLCRAFT CO. REGISTER

1P

Page 1 of 1

LC 4/425

JLO Date 12/28/2000

Time 11:28:17

Register of Deeds Stamp & File Number

4. Lot No. _____, Recorded Plat _____

5. Private Claims _____

1	A	B	C	D	E	F	G	H	I	J	K	L
2	6		5		4		3		2		1	
3												
4	7		8		9		10		11		12	
5												
6	18		17		16		15		14		13	
7												
8	19		20		21		22		23		24	
9												
10	30		29		28		27		26		25	
11												
12	31		32		33		34		35		36	
13												

I, Thomas P. O'Brien, in a field survey on 11/7/00 ~~x10x~~ do hereby state that under requirements of P.A. 74, Michigan P.A. of 1970, the corner points mentioned in lines 1 and 2 above were in conformance with regulations and rules therefore as required in the current manual of survey instructions of the United States Department of the Interior, Bureau of Land Management or by a decree of a Court of Law and/or Board of Land Surveyors or by a Decree of a Court of Law; established, re-established, monumented, recovered, found as expressed below:

NOTE: Not more than 2 corners, all in the same town and range, may be recorded on this certificate.

A. Description of original monument and accessories and/or subsequent restoration:

April 1851 Algernon Merryweather set section corner Section 12 and 13 Birch 10 in N60W 35 links Beech 1" S50W 52"

March 1984 William F. Bowman, LLS "set by proportionate measure on line between M3 and A7 (42-13)."

B. Description of corner evidence found and/or method applied in restoring or reestablishing corner:

Nov. 7, 2000 Thomas P. O'Brien, PS found 1" pipe with 4" Mead cap and LS 28406 stamp as set by Bowman."

C. Description of monument for corner and accessories established to perpetuate locating the position of the corner:

1" pipe with 4" Mead cap stamped to identify.

Witnesses:

8" Beech S71°W 13.08'

10" Maple S36°E 29.45'

8" Maple S73°E 16.68'

8" Maple N22°E 31.70'

Carsonite Post North 2.0'

Thomas P. O'Brien

Signed by Thomas P. O'Brien

Surveyor's Michigan License No. 21274

Date Dec. 19, 2000

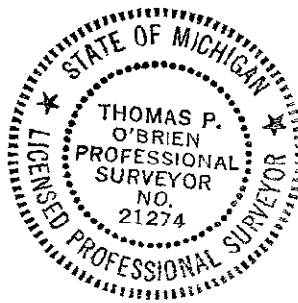

LIBER 4 PAGE: 425