

MICHIGAN  
DEPARTMENT OF CONSERVATION  
FORESTRY DIVISION

# LAND CORNER RECORD

T. 42 N.R. 15-16 W

Schoolcraft COUNTY

DESCRIPTION OF CORNER Section corner 7, 12, 13, 18

CORNER MONUMENT 2" I.D. iron pipe with 2 1/2" brass cap stamped "7, 12, 13, 18, c.s"

DATE MONUMENT PLACED AND WITNESSED Date placed unknown; rewitnessed 4/22/64

WITNESSES TO CORNER..... Cedar 7 N58E 42 1/2 links, "S7, NBT"

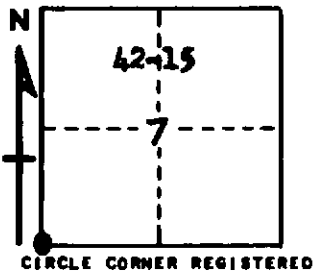

Cedar 7 S25E 30 " "S16, NBT"

do 8 S41W 60 " "S13, NBT"

AND

DESCRIPTION IN DETAIL AS TO HOW CORNER WAS LOCATED AND IDENTIFIED OR RESTORED.

Corner located and pipe set by Carl Christensen from one original bearing tree, Tamarack 6 N7W 32 links. BT present in 1964, down, in poor condition, but scribe marks "R16, T42N, 12" legible on upper face.

SURVEYOR'S SEAL

SIGNED Arthur O. Enger DATE 9-17-64  
REGISTERED LAND SURVEYOR  
Arthur O. Enger  
RLS 19581