

MICHIGAN
DEPARTMENT OF CONSERVATION
FORESTRY DIVISION

LAND CORNER RECORD

T. 42-43 N.R. 15W

Schoolcraft COUNTY

DESCRIPTION OF CORNER Section Corner for Sections 36-1, also Township Corner for
Towns 42-43 North and Range 15 West.

CORNER MONUMENT 1" Pipe with 4" Brass Cap.

DATE MONUMENT PLACED AND WITNESSED 5-23-61

WITNESSES TO CORNER..... 4" Red Pine (S 1 NBT) S62°W 33 links

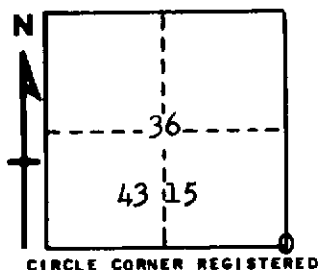

8" Red Pine (S36 NBT) N20°W 63 links

AND

DESCRIPTION IN DETAIL AS TO HOW CORNER WAS LOCATED AND IDENTIFIED OR RESTORED.

This corner was re-established using Section Corners 1 mile south; 1 mile east; 1 mile west and six miles north.

No evidence of Original Corner.

Note: Township Corner for Twps. 42-43 N R14W lies 1.65 chains North of this Corner.

SURVEYOR'S SEAL

SIGNED

Billy D. Buckler
REGISTERED LAND SURVEYOR
Billy D. Buckler

DATE December 28, 1961