

MICHIGAN  
DEPARTMENT OF CONSERVATION  
FORESTRY DIVISION

# LAND CORNER RECORD

T. 42-43 N.R. 15 W.

Schoolcraft COUNTY

DESCRIPTION OF CORNER Section corner common to Sections 1, 2, 35, 36

CORNER MONUMENT 1# Pipe with 4" Brass Cap

DATE MONUMENT PLACED AND WITNESSED 5/11/61

WITNESSES TO CORNER... 8" Red Pine (S 35 NBT) N 50 deg. W 72 Links

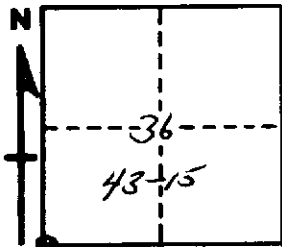

10" Red Pine (S 1 NBT) S 71 deg. E 94 Links

8" Red Pine (S 36 NBT) N 17 deg. E 58 Links

AND

CIRCLE CORNER REGISTERED

**DESCRIPTION IN DETAIL AS TO HOW CORNER WAS LOCATED AND IDENTIFIED OR RESTORED.**

This corner was replaced from one W. Pine Stump bottom bearing N 56 deg. W, 38 Links. Field notes indicate a 30" W. Pine. There are no other large W. Pine near. No evidence of 20" Red Pine Stump N 48 deg. E, 40 Links. Position checks well with good corner 1/2 mile West. Corner lies on South edge of small marsh.

**SURVEYOR'S SEAL**

SIGNED Billy D. Buckler DATE 9/15/61  
REGISTERED LAND SURVEYOR  
Billy D. Buckler