

**SCHOOLCRAFT COUNTY
PEER GROUP APPROVED**

DATE 12/7/95 ^{JAS} **LAND CORNER RECORDATION CERTIFICATE**
Filing Requirement of Act 74, Mich. P.A. 1970

SURVEY &
REMONUMENTATION

NOV 21 1995

COMMISSION

For corners in

<u>Schoolcraft</u> (County)	Located in:	Corner Code #
1. Public Land Survey	T42NR15W	E-7
	T___R___	_____
	T___R___	_____
	T___R___	_____
2. Property Controlling in Section	S___T___R___	_____
	S___T___R___	_____
3. Miscellaneous Property in Sec.	S___T___R___	_____
	S___T___R___	_____

Received & Filed this 8th day of
October 19 96 at 11:38 A M
Sigrid I. Hedberg
Schoolcraft Co. Reg. of Deeds

Register of Deeds Stamp & File Number

4. Lot No. _____, Recorded Plat _____
5. Private Claims _____

I, Thomas P. O'Brien, in a field survey on Jan. 2, 1996 do hereby state that under requirements of P.A. 74, Michigan P.A. of 1970, the corner points mentioned in lines 1 and 2 above were in conformance with regulations and rules therefore as required in the current manual of survey instructions of the United States Department of the Interior, Bureau of Land Management or by a decree of a Court of Law and /or that the corner points mentioned in lines 3, 4 and 5 above were in conformance with the rules of the Michigan Board of Land Surveyors or by a Decree of a Court of Law; established, re-established, monumented, recovered, found as expressed below:

NOTE: Not more than 2 corners, all in the same town and range, may be recorded on this certificate.

1	A	B	C	D	E	F	G	H	I	J	K	L	M
2		6		5		4		3		2		1	
3													
4		7		8		9		10		11		12	
5													
6		18		17		16		15		14		13	
7					X								
8		19		20		21		22		23		24	
9													
10		30		29		28		27		26		25	
11													
12		31		32		33		34		35		36	
13													

A. Description of original monument and accessories and/or subsequent restoration:

E-7 (Section Corner common to sections 16,17,20 and 21)
Sept 22, 1850 Algernon Merryweather D.S. set corner post. Spruce 7 in. S72E 17 links Tamarack 8" N79W 21"
SURVEY & REMONUMENTATION

DEC 15 1996

COMMISSION

B. Description of corner evidence found and/or method applied in restoring or reestablishing corner:

E-7 January 2, 1996 Thomas P. O'Brien P.S. Recovered post and two post points, accepted squared post point 6" under ground surface as corner position. Reset with Schoolcraft County monument.

C. Description of monument for corner and accessories established to perpetuate locating the position of the corner:

E-7 Set Schoolcraft County monument stamped to identify.

Witnesses: 6" Cedar - N60°E - 56.05'
8" Cedar - S63°E - 41.72'
8" Cedar - S77°W - 31.00'
6" Cedar - N77°W - 43.45'
4" Cedar post - North - 1.50'

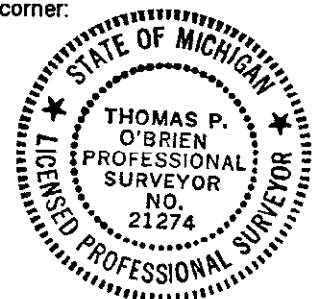

Signed by Thomas P. O'Brien

Date August 29, 1996

Surveyor's Michigan License No. 21274