

SCHOOLCRAFT COUNTY
PEER GROUP APPROVED

SURVEY &
REMONUMENTATION

JAN 21 1998

DATE 10/15/97

LAND CORNER RECORDATION CERTIFICATE
Filing Requirement of Act 74, Mich. P.A. 1970

SECTION

For corners in

Schoolcraft (County)	Located In:	Corner Code #
1. Public Land Survey	T 42N R 16W	H11
	T R	
	T R	
	T R	
2. Property Controlling in Section	S T R	
	S T R	
3. Miscellaneous Property in Sec.	S T R	
	S T R	

Received & Filed this 9 day of
Dec 1997 at 3:56 P M
Sigrid I. Hedberg
Schoolcraft Co. Reg. of Deeds

Register of Deeds Stamp & File Number

4. Lot No. _____, Recorded Plat _____
5. Private Claims _____

Thomas P. O'Brien in a field survey on Nov. 3, 1997 do hereby state that under requirements of P.A. 74, Michigan P.A. of 1970, the corner points mentioned in lines 1 and 2 above were in conformance with regulations and rules therefore as required in the current manual of survey instructions of the United States Department of the Interior, Bureau of Land Management or by a decree of a Court of Law and /or that the corner points mentioned in lines 3, 4 and 5 above were in conformance with the rules of the Michigan Board of Land Surveyors or by a Decree of a Court of Law; established, re-established, monumented, recovered, found as expressed below:

	A	B	C	D	E	F	G	H	I	J	K	L	M
1													
2		6		5		4		3		2		1	
3													
4		7		8		9		10		11		12	
5													
6		18		17		16		15		14		13	
7													
8		19		20		21		22		23		24	
9													
10		30		29		28		27		26		25	
11								X					
12		31		32		33		34		35		36	
13													

NOTE: Not more than 2 corners, all in the same town and range, may be recorded on this certificate.

A. Description of original monument and accessories and/or subsequent restoration:

H11 S1/4 corner Section 27
Aug. 13, 1850 Algernon Merryweather, DS set qr section post
Aspen 4 in S55E 21 links do 4 in N47W 16 links

June 5, 1975 Thomas P.O'Brien, PS found boat spike @ road intersection
N,S,E&W. LCRC recorded in Liber 1, Page 158.

B. Description of corner evidence found and/or method applied in restoring or reestablishing corner:

H11 Nov. 3, 1997 Thomas P.O'Brien, PS recovered boat spike @ road intersection
N,S,E&W. Found witnesses to verify corner position. Replaced spike with
iron bar and OBRIEN 21274 cap in monument box.

C. Description of monument for corner and accessories established to perpetuate locating the position of the corner:

H11 1/2" iron bar w/OBRIEN 21274 cap in monument box.

Witnesses:

- FD. 18" Maple N31°W 59.25' (dead)
- FD. 20" Red Pine N54°E 50.75'
- NBT 12" White Pine S38°E 54.44'
- NBT 10" Oak S65°W 89.0'
- NBT 14" Maple N53°W 106.45'

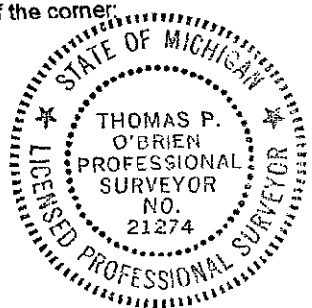

Signed by Thomas P.O'Brien, PS
Surveyor's Michigan License No. 21274

Date Dec. 9, 1997