

SCHOOLCRAFT COUNTY
PEER GROUP APPROVED

DATE 11/12/97

LAND CORNER RECORDATION CERTIFICATE
Filing Requirement of Act 74, Mich. P.A. 1970

SURVEY &
REMONUMENTATION

JAN 21 1998

For corners in

Schoolcraft (County)	Located In:	Corner Code #
1. Public Land Survey	T <u>42N</u> R <u>16W</u>	K3
	T ___ R ___	_____
	T ___ R ___	_____
	T ___ R ___	_____
2. Property Controlling in Section	S ___ T ___ R ___	_____
	S ___ T ___ R ___	_____
3. Miscellaneous Property in Sec.	S ___ T ___ R ___	_____
	S ___ T ___ R ___	_____

SECTION
Received & Filed this 9 day of
Dec. 1997 at 3:59 p M
Sigrid I. Hedberg
Schoolcraft Co. Reg. of Deeds

Register of Deeds Stamp & File Number

4. Lot No. _____, Recorded Plat _____
5. Private Claims _____

I, Thomas P.O'Brien, in a field survey on Nov. 24, 1997 do hereby state that under requirements of P.A. 74, Michigan P.A. of 1970, the corner points mentioned in lines 1 and 2 above were in conformance with regulations and rules therefore as required in the current manual of survey instructions of the United States Department of the Interior, Bureau of Land Management or by a decree of a Court of Law and for that the corner points mentioned in lines 3, 4 and 5 above were in conformance with the rules of the Michigan Board of Land Surveyors or by a Decree of a Court of Law; established, re-established, monumented, recovered, found as expressed below:

NOTE: Not more than 2 corners, all in the same town and range, may be recorded on this certificate.

	A	B	C	D	E	F	G	H	I	J	K	L	M
1													
2		6		5		4		3		2		1	
3											X		
4		7		8		9		10		11		12	
5													
6		18		17		16		15		14		13	
7													
8		19		20		21		22		23		24	
9													
10		30		29		28		27		26		25	
11													
12		31		32		33		34		35		36	
13													

A. Description of original monument and accessories and/or subsequent restoration:

K3 NW corner Section 12
August 12, 1850 Algernon Merryweather, DS set corner post
Cedar 12 S46W 25 links do 16 N60E 5 links

Sept. 19, 1985 Neil E. Hill, LS found 3" square cedar post at location of record,
Corner location related to highway alignment in M94 highway prints. Replaced square
post with 3/4" x 40" pipe and MDOT cap.

B. Description of corner evidence found and/or method applied in restoring or reestablishing corner:

K3 Nov. 24, 1997 Thomas P.O'Brien, PS recovered 3/4" pipe as set by Neil E. Hill, LS on
Sept. 19, 1985. Found witnesses verify corner location. Replaced 3/4" pipe with
Schoolcraft County monument.

C. Description of monument for corner and accessories established to perpetuate locating the position of the corner:

K3 Schoolcraft County monument stamped to identify.

Witnesses:

- (FD) 13" Cedar S10°E 23.48'
- (FD) 13" Cedar S9°W 22.17'
- (FD) 10" Cedar S18°W 12.93'
- (FD) 7" Twin Cedar S16°E 22.40'
- NBT 8" Cedar N65°W 138.30'
- NBT 6" Tamarack N66°E 96.79'
- Carsonite Post North 1.0'

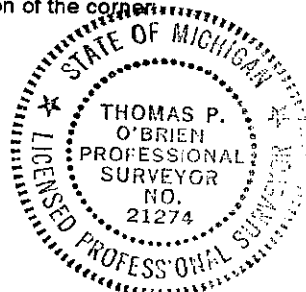

Signed by Thomas P.O'Brien, PS

Date Dec 9, 1997

Surveyor's Michigan License No. 21274