

MICHIGAN
DEPARTMENT OF CONSERVATION
FORESTRY DIVISION

LAND CORNER RECORD

T. 43N N.R. 14W

Schoolcraft COUNTY

DESCRIPTION OF CORNER Section Corner common to Sections 8-9-16-17

CORNER MONUMENT 1" Pipe with 4" Brass Cap.

DATE MONUMENT PLACED AND WITNESSED 6-14-61 with Frank J. Bray

WITNESSES TO CORNER..... 9" Red Pine (S8 NBT) N43°W 116 links

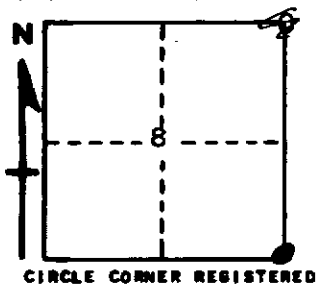

AND

DESCRIPTION IN DETAIL AS TO HOW CORNER WAS LOCATED AND IDENTIFIED OR RESTORED.

This corner was re-established by proportionate measure between Section Corner 2 miles North and 1 mile South.

Note; Corner lies in wet open marsh.

SURVEYOR'S SEAL

SIGNED

Billy D. Buckler
REGISTERED LAND SURVEYOR
Billy D. Buckler

DATE December 29, 1961