

**LAND CORNER RECORDATION CERTIFICATE**  
**Filing Requirement of Act 74, Mich. P.A. 1970 as Amended**

For corners in

<u>Schoolcraft</u> (County)	Located In:	Corner Code #
1. Public Land Survey	<u>T43N R 16W</u>	<u>I3</u>
	T <u>    </u> R <u>    </u>	<u>    </u>
	T <u>    </u> R <u>    </u>	<u>    </u>
2. Property Controlling in Section	S <u>    </u> T <u>    </u> R <u>    </u>	<u>    </u>
	S <u>    </u> T <u>    </u> R <u>    </u>	<u>    </u>
3. Miscellaneous Property in Sec.	S <u>    </u> T <u>    </u> R <u>    </u>	<u>    </u>
	S <u>    </u> T <u>    </u> R <u>    </u>	<u>    </u>
4. Lot No. <u>    </u> , Recorded Plat <u>    </u>		
5. Private Claims		

Register of Deeds Stamp & File Number

A	B	C	D	E	F	G	H	I	J	K	L	M
1												
2	6	5	4	3	2	1						
3								●				
4	7	8	9	10	11	12						
5												
6	18	17	16	15	14	13						
7												
8	19	20	21	22	23	24						
9												
10	30	29	28	27	26	25						
11												
12	31	32	33	34	35	36						
13												

I, Stephan J. Szyszkoski, in a field survey on Oct. 25, 2007 do hereby state that under requirements of P.A. 74, Michigan P.A. of 1970, the corner points mentioned in lines 1 and 2 above were in conformance with regulations and rules therefore as required in the current manual of survey instructions of the United States Department of the Interior, Bureau of Land Management or by a decree of a Court of Law and /or that the corner points mentioned in lines 3, 4 and 5 above were in conformance with the rules of the Michigan Board of Land Surveyors or by a Decree of a Court of Law; established, re-established, monumented, recovered, found as expressed below:

**NOTE: Not more than 2 corners, all in the same town and range, may be recorded on this certificate.**

A. Description of original monument and accessories and/or subsequent restoration:  
(I3) Corner common to Sections 2-3-10-11. 1850 - Established by A.Merryweather, Deputy Surveyor. No monument specified. Bearing trees: Beech 8 S35E 25 links, Sugar 14 N45W 9 links. 1975 - Recorded by Thomas P. O'Brien RLS: Set 1/2" iron bar with RLS 21274 cap by double proportionate measurement from the SE corner Section 10 to stream crossing on East line of Section 3 and from the NW corner of Section 10 and stream crossing on South line of Section 1. Bearing trees: 10" Maple N40W 21.55', 28" Birch N55E 21.25', 10" Maple S20W 20.85'. According to the Schoolcraft Co. Rd. Commission, the county road between Sections 10 and 11 (Southside Rd.) has been in use since approx. the 1930's. No survey records available.

B. Description of corner evidence found and/or method applied in restoring or reestablishing corner:  
(I3) The original post and accessories have been destroyed by road construction. Found the 1975 monument of record in good condition, undisturbed, which I did not accept as marking the position for the corner. I accepted the northing of the 1975 monument as a careful and faithful determination of the northing of the original corner. I reestablished the easting for the corner on the northerly extension of the C/L of the county road which runs along the line between Sections 10 and 11. From this position, I find that the reestablished J3 (based on local evidence) is 2637.4' east, the east shore of Ashford Lake (noted in the GLO record on the line between Sections 3 and 10) is 3603' west (14' longer than GLO record), and the westerly six of ten stream bank calls noted in the GLO record along the line between Sections 1 and 12 all check extremely well with the GLO record (I note that the Stutts creek appears to have shifted in position through avulsion action since the original survey. The GLO calls to the westerly-most four stream banks now check to the banks of a slough). Since this position for I3 conforms so well with both the original record and with the existing local evidence (road construction and local development), I accept the county road centerline as the best available evidence of the easting of the original corner and monument the corner on its extension to the north and at the northing of the 1975 monument. The actual physical centerline of the county road is 15 feet west of the corner monument: The road deflects somewhat to the west 300'-400' south of the corner position. The corner position falls on the top of the road bank cut.

NOTE: in a meeting held on Nov. 7 2007, the Schoolcraft County Remonumentation Program Peer Review Group approved, in accordance with P.A. 345 of 1990, the previous 1975 position of record.

C. Description of monument for corner and accessories established to perpetuate locating the position of the corner:  
(I3) Set 1"IDx36" I.pipe with 4" alum. MDNR cap:  
Set measuring nail with MDNR tag in the side of:  
6" Maple S50E 11.78' mrkd "S11 NBT"  
14" Maple N50E 18.53' "S2 NBT"  
11" Maple N45W 45.0' "S3 NBT"  
11" Maple S75W 44.87' "S10 NBT"  
Set carsonite post 1.0' south.  
1/2" iron (1975 mon. of record) is N85W 77.01'.  
Bearings are magnetic.

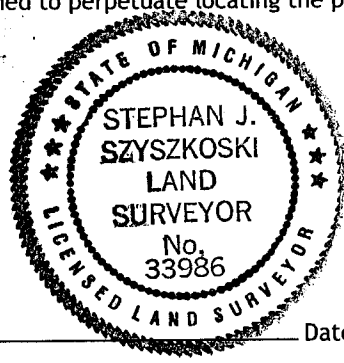

Signed by Stephan J. Szyszkoski Date 11/13/07

Surveyor's Michigan License No. 33986