

**LAND CORNER RECORDATION CERTIFICATE**  
**Filing Requirement of Act 74, Mich. P.A. 1970 as Amended**

For corners in

<u>Schoolcraft</u> (County)	Located In:	Corner Code #
1. Public Land Survey	T <u>43N</u> R <u>16W</u>	<u>K4</u>
	T _____ R _____	_____
	T _____ R _____	_____
2. Property Controlling in Section	S _____ T _____ R _____	_____
	S _____ T _____ R _____	_____
3. Miscellaneous Property in Sec.	S _____ T _____ R _____	_____
	S _____ T _____ R _____	_____
4. Lot No. _____, Recorded Plat _____		
5. Private Claims		

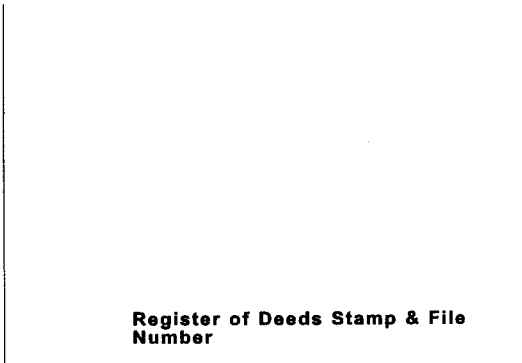

	A	B	C	D	E	F	G	H	I	J	K	L	M
1													
2	6		5		4		3		2		1		
3													
4	7		8		9		10		11	●	12		
5													
6	18		17		16		15		14		13		
7													
8	19		20		21		22		23		24		
9													
10	30		29		28		27		26		25		
11													
12	31		32		33		34		35		36		
13													

I, Stephan J. Szyszkoski, in a field survey on Oct. 25, 2007 do hereby state that under requirements of P.A. 74, Michigan P.A. of 1970, the corner points mentioned in lines 1 and 2 above were in conformance with regulations and rules therefore as required in the current manual of survey instructions of the United States Department of the Interior, Bureau of Land Management or by a decree of a Court of Law and /or that the corner points mentioned in lines 3, 4 and 5 above were in conformance with the rules of the Michigan Board of Land Surveyors or by a Decree of a Court of Law; established, re-established, monumented, recovered, found as expressed below:

**NOTE: Not more than 2 corners, all in the same town and range, may be recorded on this certificate.**

A. Description of original monument and accessories and/or subsequent restoration:  
 (K4) Quarter corner common to Sections 11 and 12. 1850 - Established by A.Merryweather, Deputy Surveyor, midway and on the Section line between Section corners 40.00 chains north and south. Set post. Bearing trees: Birch 26 S75E 33 links, Hemlock 9 N72W 22 links. Found no subsequent record.

B. Description of corner evidence found and/or method applied in restoring or reestablishing corner:  
 (K4) The original post and accessories were not recovered. Found no evidence of the original GLO line trees along the Section line between Sections 11 and 12. Found no acceptable evidence of the position of the original corner on the ground. Reestablished the corner midway and on the Section line between Section corners 2635.33' north and south.

C. Description of monument for corner and accessories established to perpetuate locating the position of the corner:  
 (K4) Set 1"IDx36" I.pipe with 4" alum. MDNR cap. Set measuring nail with MDNR tag in the side of:  
 9" W.Birch S77W 16.53' mrkd "1/4S NBT"  
 12" W.Birch S70E 13.59' do  
 6" Maple N22E 40.04' do  
 6" Balsam S17W 4.59' do  
 Set carsonite post 1.0' north.  
 Bearings are magnetic.

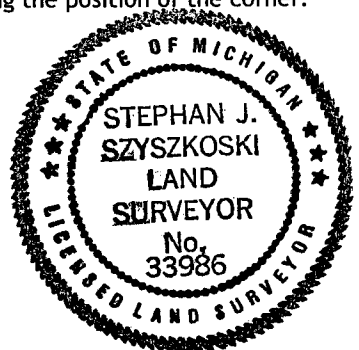

Signed by Stephan J. Szyszkoski Date 11/1/07

Surveyor's Michigan License No. 33986