

LAND CORNER RECORDATION CERTIFICATE
Filing Requirement of Act 74, Mich. P.A. 1970 as Amended

For corners in

<u>Schoolcraft</u> (County)	Located In:	Corner Code #
1. Public Land Survey	T _____ R _____ T _____ R _____ T _____ R _____	_____
2. Property Controlling in Section	S _____ T _____ R _____ S <u>26</u> T <u>43N</u> R <u>16W</u> S <u>26</u> T <u>43N</u> R <u>16W</u>	<u>3</u> <u>4</u>
3. Miscellaneous Property in Sec.	S _____ T _____ R _____ S _____ T _____ R _____	_____
4. Lot No. _____, Recorded Plat _____		
5. Private Claims		

Register of Deeds Stamp & File Number

	A	B	C	D	E	F	G	H	I	J	K	L	M
1													
2	6		5		4		3		2		1		
3													
4	7		8		9		10		11		12		
5													
6	18		17		16		15		14		13		
7													
8	19		20		21		22		23		24		
9													
10	30		29		28		27		26		25		
11													
12	31		32		33		34		35		36		
13													

Dec 19 2005

I, Stephan J. Szyszkoski, in a field survey on _____, 20____ do hereby state that under requirements of P.A. 74, Michigan P.A. of 1970, the corner points mentioned in lines 1 and 2 above were in conformance with regulations and rules therefore as required in the current manual of survey instructions of the United States Department of the Interior, Bureau of Land Management or by a decree of a Court of Law and /or that the corner points mentioned in lines 3, 4 and 5 above were in conformance with the rules of the Michigan Board of Land Surveyors or by a Decree of a Court of Law; established, re-established, monumented, recovered, found as expressed below:

NOTE: Not more than 2 corners, all in the same town and range, may be recorded on this certificate.

A. Description of original monument and accessories and/or subsequent restoration:

- (3-Sec. 26) North 1/16 corner between Sections 26 and 27. Not established in the original survey.
- (4-Sec. 26) Northwest 1/16 corner, Section 26. Not established in the original survey.

B. Description of corner evidence found and/or method applied in restoring or reestablishing corner:

- (3-Sec. 26) Established the corner midway and on the Section line between Quarter corner 1325.71' south and Section corner 1325.71' north.
- (4-Sec. 26) Established the corner at the intersection of straight lines connecting opposite 1/16 corners.

C. Description of monument for corner and accessories established to perpetuate locating the position of the corner:

- | | |
|--|---|
| (3) Set 1"IDx36" I.pipe with 4" alum. MDNR cap. Set measuring nails in:
16" W.Pine S85W 12.7' mrkd "N1/16 BT"
9" R.Pine N39W 17.85' do
14" R.Pine S41W 18.73' do
12" W.Pine N31E 58.65' do | (4) Set 1"IDx36" I.pipe with 4" alum. MDNR cap. Set measuring nails in:
10" Maple N14E 5.9' mrkd "NW1/16 BT"
6" Balsam N58W 27.0' do
11" Maple S62E 36.45' do
7" Maple S22E 26.47' do |
| Bearings are magnetic. Distances are to nail with tag. | Bearings are magnetic. Distances are to nail with tag. |

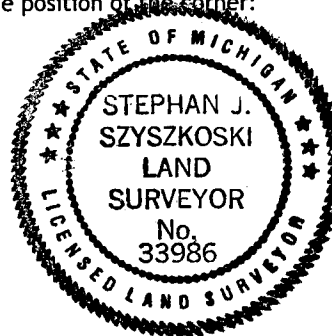

Signed by Stephan J. Szyszkoski
 Surveyor's Michigan License No. 33986

Date 12/6/06

For the Michigan Department of Natural Resources, Office of Land and Facilities