

LAND CORNER RECORDATION CERTIFICATE
Filing Requirement of Act 74, Mich. P.A. 1970 as Amended

For corners in

<u>Schoolcraft</u> (County)	Located In:	Corner Code #
1. Public Land Survey	<u>T44N R 16W</u>	<u>A7</u>
	<u>T44N R 16W</u>	<u>E7</u>
	<u>T</u>	<u>R</u>
2. Property Controlling in Section	S <u>T</u>	<u>R</u>
	S <u>T</u>	<u>R</u>
3. Miscellaneous Property in Sec.	S <u>T</u>	<u>R</u>
	S <u>T</u>	<u>R</u>
4. Lot No. _____, Recorded Plat _____		
5. Private Claims	E7 Dec 06 2006	
	A7 Mar 02 2006	

Register of Deeds Stamp & File
Number

1	A	B	C	D	E	F	G	H	I	J	K	L	M
2		6		5		4		3		2		1	
3													
4		7		8		9		10		11		12	
5													
6		18		17		16		15		14		13	
7													
8		19		20		21		22		23		24	
9													
10		30		29		28		27		26		25	
11													
12		31		32		33		34		35		36	
13													

I, Stephan J. Szyszkoski, in a field survey on _____, 20____ do hereby state that under requirements of P.A. 74, Michigan P.A. of 1970, the corner points mentioned in lines 1 and 2 above were in conformance with regulations and rules therefore as required in the current manual of survey instructions of the United States Department of the Interior, Bureau of Land Management or by a decree of a Court of Law and /or that the corner points mentioned in lines 3, 4 and 5 above were in conformance with the rules of the Michigan Board of Land Surveyors or by a Decree of a Court of Law; established, re-established, monumented, recovered, found as expressed below:

NOTE: Not more than 2 corners, all in the same town and range, may be recorded on this certificate.

A. Description of original monument and accessories and/or subsequent restoration:

- (A7) Corner common to Sections 18 and 19 T44N-R16W and Sections 13 and 24 T44N-R17W. 1981 - Reestablished by proportionate measurement by D.B.Babbitt RLS. Set 1" pipe with 4" aluminum cap. 4" R.Pine N01W 38.85', 9" J.Pine S04E 4.9', 10" J.Pine N46W 21.25', 9" J.Pine N70E 25.8'.
- (E7) Corner common to Sections 16-17-20-21. 1965 - Remonumented by F.J.Bray RLS in the original position as found from an original W.Pine BT. Set 1" I.pipe with 4" aluminum cap. 8" W.Pine S53W 12 links, 6" W.Pine S50E 30.5 links, 6" Y.Pine N55E 58 links.

B. Description of corner evidence found and/or method applied in restoring or reestablishing corner:

- (A7) Recovered the 1981 monument in good condition and at record bearing and distance from two of the 1981 NBTs. Left the monument in place and made additional witnesses as described below.
- (E7) Recovered the 1965 monument in good condition and at record bearing and distance from the 1964 witnesses, all in good condition.

C. Description of monument for corner and accessories established to perpetuate locating the position of the corner:

- | | |
|---|---|
| (A7) Found 1" ID I.pipe with 4" alum. MDNR cap. Set measuring nails in:
10" J.Pine S01W 5.35' open blazes *
7" R.Pine N07E 39.00' "S18 NBT" *
12" J.Pine S85E 75.75' "S19 NBT"
8" J. Pine S23E 69.35' "S19 NBT"
Bearings are magnetic. Distances are to nail with tag. * denotes 1981 NBTs | (E7) Found 1" I.pipe with 4" aluminum MI Dept. of Conservation cap. Set measuring nails in:
17" R.Pine N59E 38.52' wrkd "S16" *
17" W.Pine S45E 20.75' "S21" *
20" W.Pine S52W 8.32' "S20" *
10" W.Birch N16W 18.55' wrkd "S17 NBT"
Bearings are magnetic. Distances are to nail with tag. * denotes 1964 NBT. |
|---|---|

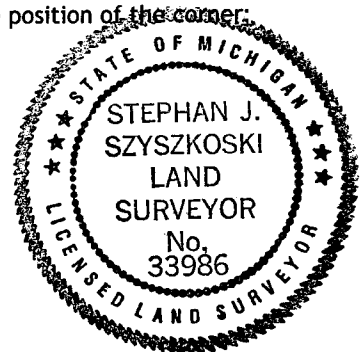

Signed by Stephan J. Szyszkoski
 Surveyor's Michigan License No. 33986

Date 1/17/07

For the Michigan Department of Natural Resources, Office of Land and Facilities