

MICHIGAN  
DEPARTMENT OF CONSERVATION  
FORESTRY DIVISION

# LAND CORNER RECORD

T. 46N N.R. 13W

Schoolcraft COUNTY

DESCRIPTION OF CORNER Sec. Cor. common to Secs. 29-30-31-32

CORNER MONUMENT 1" pipe with 4" aluminum cap

DATE MONUMENT PLACED AND WITNESSED 10-7-70

WITNESSES TO CORNER..... 18" Red Pine, S20°E, 19.05'

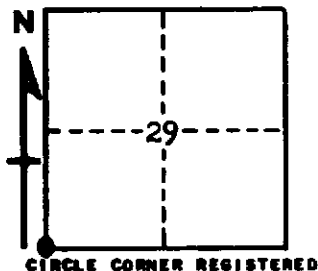

AND

**DESCRIPTION IN DETAIL AS TO HOW CORNER WAS LOCATED AND IDENTIFIED OR RESTORED.**

Marked by Biological Survey U.S.D.A.

East corner, of the Seney Sub Station, an electrical installation of the Upper Peninsula Power Co. bearing West, 70.1'

This corner replaced from the Red Pine witness noted. Found where the former monument had been removed by a tractor.

Corner is replaced in the original position.

**SURVEYOR'S SEAL**

SIGNED

*Billy D. Buckler*  
Billy D. Buckler

REGISTERED LAND SURVEYOR

DATE

10-19-70