

LAND CORNER RECORDATION CERTIFICATE
Filing Requirement of Act 74, Mich. P.A. 1970 as Amended

For corners in

Schoolcraft	Located In:	Corner Code #
(County)		
1. Public Land Survey	T <u>46N</u> R <u>15W</u>	<u>16</u>
	T _____ R _____	_____
	T _____ R _____	_____
2. Property Controlling in Section	S _____ T _____ R _____	_____
	S <u>3</u> T <u>46N</u> R <u>15W</u>	<u>1</u>
	S _____ T _____ R _____	_____
3. Miscellaneous Property in Sec.	S _____ T _____ R _____	_____
	S _____ T _____ R _____	_____

4. Lot No. _____, Recorded Plat _____

5. Private Claims

1 Mar 15 2006
 16 Jan 24 2006

I, Stephan J. Szyszkoski, in a field survey on _____, 20__ do hereby state that under requirements of P.A. 74, Michigan P.A. of 1970, the corner points mentioned in lines 1 and 2 above were in conformance with regulations and rules therefore as required in the current manual of survey instructions of the United States Department of the Interior, Bureau of Land Management or by a decree of a Court of Law and /or that the corner points mentioned in lines 3, 4 and 5 above were in conformance with the rules of the Michigan Board of Land Surveyors or by a Decree of a Court of Law; established, re-established, monumented, recovered, found as expressed below:

NOTE: Not more than 2 corners, all in the same town and range, may be recorded on this certificate.

A. Description of original monument and accessories and/or subsequent restoration:

(16) Quarter corner common to Sections 14 and 15. 1957 - Remonumented by Billy D. Buckler RLS from the two original Cedar BTs (Cedar 8 N41E 11 links and Cedar 8 S64W 19 links). Set 1" iron pipe with 4" brass cap. 15" W.Pine S84E 47 links, 7" Cedar S33W 43 links.
 (1-Sec. 3) West 1/16 corner between Sec. 3 T46N-R15W and Section 34 T47N-R15W. Established in 1964 by Frank J. Bray RLS. Set 1" Iron pipe with 4" aluminum cap. 14" W.Pine S29E 32 links, 14" W.Pine S55W 43.5 links.

B. Description of corner evidence found and/or method applied in restoring or reestablishing corner:

(16) Recovered the 1957 monument in good condition and at record bearing and distance from the original Cedar BTs, now both dead with notches visible, and at record bearing and distance from the 1957 NBTs. The W.Pine SE is dead and down, the Cedar SW is in good condition.
 (1-Sec. 3) Recovered the 1964 monument in good condition and at substantial record bearing and distance from the 1964 witnesses. Both trees are in good condition. My measurements show that this monument is located 1.13' from the midpoint position between adjacent Section and Quarter corners and I accept the monument as a careful and faithful determination of the position of the corner.

C. Description of monument for corner and accessories established to perpetuate locating the position of the corner:

(16) Fd. 1" ID I.pipe with 4" brass MI Dept. of Conservation cap. Set measuring nails in: 9" Hemlock N01E 7.75' mrkd "1/4S NBT" 9" Cedar S28W 29.6' mrkd "1/4S" * 7" Cedar S17W 28.8' "1/4S NBT" 4" Cedar S25E 24.1' do Bearings are magnetic. Distances are to nail with tag. * denotes 1957 NBT.	(1) Fd. 1" ID I.pipe with 4" alum. MI Dept. of Conservation cap. Set measuring nails in: 16" W.Pine S26E 20.8' mrkd "W1/16" * 18" W.Pine S61W 29.05' do * 8" Tamarack N77E 25.2' "W1/16 BT" 7" W.Pine N11E 30.35' do Bearings are magnetic. Distances are to nail with tag. * denotes 1964 NBT.
--	---

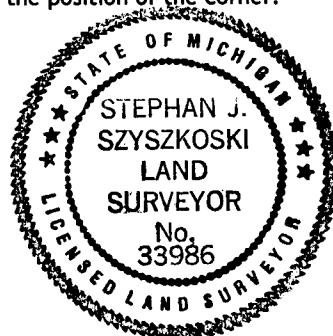

Signed by Stephan J. Szyszkoski Date 8/15/06
 Surveyor's Michigan License No. 33986

Register of Deeds Stamp & File
 Number

	A	B	C	D	E	F	G	H	I	J	K	L	M
1													
2	6	5	4	3	2	1							
3													
4	7	8	9	10	11	12							
5													
6	18	17	16	15	14	13							
7													
8	19	20	21	22	23	24							
9													
10	30	29	28	27	26	25							
11													
12	31	32	33	34	35	36							
13													