

SURVEY & REMONUMENTATION

MAY 28 1997

COMMISSION

REMONUMENTATION

LAND CORNER RECORDATION CERTIFICATE
Filing Requirement of Act 74, Mich. P.A. 1970

RECORDED

95 AUG 16 PM 2:38

REGISTER OF DEEDS

Kay's Shultz
SHIAWASSEE COUNTY, MICH.

For corners in <u>Shiawassee</u> (County)	Located In:	Corner Code #
1. Public Land Survey	T 7N R 1E	D-09 (NW 29)
	T _____ R _____	_____
	T _____ R _____	_____
	T _____ R _____	_____
2. Property Controlling in Section	S _____ T _____ R _____	_____
	S _____ T _____ R _____	_____
3. Miscellaneous Property in Sec.	S _____ T _____ R _____	_____
	S _____ T _____ R _____	_____
4. Lot No. _____, Recorded Plat _____		
5. Private Claims _____		

Register of Deeds Stamp & File Number

I, Norman C. Caldwell, in a field survey on April 1996, do hereby certify that under requirements of P.A. 74, Michigan P.A. of 1970, the corner points mentioned in lines 1 and 2 above were in conformance with regulations and rules therefore as required in the current manual of survey instructions of the United States Department of the Interior, Bureau of Land Management or by a decree of a Court of Law and/or that the corner points mentioned in lines 3, 4 and 5 above were in conformance with the rules of the Michigan Board of Land Surveyors or by a Decree of a Court of Law; established, re-established, monumented, re-monumented, recovered, found as expressed below:

NOTE: Not more than 4 corners, all in the same town and range, may be recorded on this certificate.

A. Description of original monument and accessories and/or subsequent restoration:

D-09 Closing Section Corner of Sections 20 & 29, T 7 N, R 1 E, Middlebury Township.

Post placed by Robinson Thomas on 24 January 1831
References:
S 59 E 33 lks (21.78') 10" Maple
N 75 E 25 lks (16.50') 8" Oak

Jan S. Fokens, P.S. #21567, on a survey dated 18 August 1981 recorded in Liber 3 at page 579 and L.C.R.C. dated 22 February 1982 recorded in Liber 2 at page 318 found a railroad spike 6" deep in the centerline of Krouse Road and marked the following references: South 31.33' 60" Walnut, North 20.52' top center of 12" culvert, N 20 E 28.63' top center of 12" culvert, N45 W 43.24' top center of telephone riser.

Norman C. Caldwell, P.S. #12018, on a survey dated 31 August 1990 and recorded in Liber 6 at page 1, found the record railroad spike and recites the same references as Jan Fokens except that mention is made of the dimension of "West 6.58' to a 1/2" bar w/12018 cap on the Michigan Meridian".

B. Description of corner evidence found and/or method applied in restoring or reestablishing corner:

D-09 Closing Section Corner of Sections 20 & 29, T 7 N, R 1 E, Middlebury Township.

There is no record as to the origin of the found railroad spike.

The 1/2" bar is located on the Michigan Meridian and on the extension of the Section Line between Sections 20 & 29 as monumented by the Fokens survey. There are no apparent surveys of record which would be adversely affected by monumentation of the true intersection point.

A standard Harrison monument in a monument box has been placed at the true intersection and is accepted as a careful and faithful re-establishment of the position of the original corner.

Approved by the joint Clinton/Shiawassee County Remonumentation peer group 22 May 1996.

C. Description of monument for corner and accessories established to perpetuate locating the position of the corner:

D-09 Closing Section Corner of Sections 20 & 29, T 7 N, R 1 E, Middlebury Township.

Found 1/2" Bar w/12018 cap on the Michigan Meridian, replaced with a standard Harrison monument in a monument box in the physical centerline of Krouse Road.

References:

N 45 W 55.34' 12018 cap in 10" Maple
S 50 W 79.52' N.E. corner of well house
S 15 W 75.87' 12018 tag in 40" W. Oak
East 6.58' 1/2" bar w/12018 cap over Railroad spike

APPROVED
5/22/96 MLV
County Remonumentation
Peer Review Group

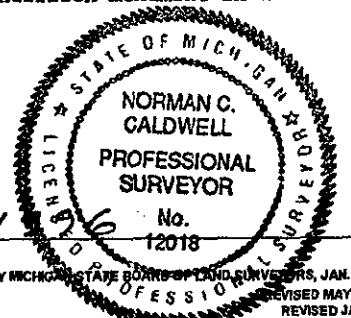

Signed by Norman C. Caldwell Date 31 MAY 1996

Surveyor's Michigan License No. 12018

FORM APPROVED BY MICHIGAN STATE BOARD OF LAND SURVEYORS, JAN. 28, 1971
REVISED MAY 14, 1975
REVISED JAN., 1983
ADAPTED FOR WORD PROCESSING MARCH, 1993

LIBER 1 R PG 158