

NOV 10 1997

COMMISSION

LAND CORNER RECORDATION CERTIFICATE  
Filing Requirement of Act 74, Mich. P.A. 1970

RECORDED

97 OCT 15 PM 12:14

REGISTER OF DEEDS

*Kaye Shultz*  
SHIAWASSEE COUNTY, MICH.

For corners in <u>Shiawassee</u> (County)	Located In: <u>Fairfield Twp</u>	Corner Code #
1. Public Land Survey	T 8N R 1E	D-4
	T R	
	T R	
	T R	
2. Property Controlling in Section	S T R	
	S T R	
3. Miscellaneous Property in Sec.	S T R	
	S T R	

Register of Deeds Stamp & File Number

4. Lot No. \_\_\_\_\_, Recorded Plat \_\_\_\_\_  
5. Private Claims \_\_\_\_\_

I, Wendy A. Papineau, in a field survey on June 1997, do hereby certify that under requirements of P.A. 74, Michigan P.A. of 1970, the corner points mentioned in lines 1 and 2 above were in conformance with regulations and rules therefore as required in the current manual of survey instructions of the United States Department of the Interior, Bureau of Land Management or by a decree of a Court of Law and/or that the corner points mentioned in lines 3, 4 and 5 above were in conformance with the rules of the Michigan Board of Land Surveyors or by a Decree of a Court of Law; established, re-established, monumented, re-monumented, recovered, found as expressed below:

1	A	B	C	D	E	F	G	H	I	J	K	L	M
2		6		5		4		3		2		1	
3													
4		7		8		9		10		11		12	
5													
6		18		17		16		15		14		13	
7													
8		19		20		21		22		23		24	
9													
10		30		29		28		27		26		25	
11													
12		31		32		33		34		35		36	
13													

NOTE: Not more than 4 corners, all in the same town and range, may be recorded on this certificate.

A. Description of original monument and accessories and/or subsequent restoration:

D-4 Closing 1/4 Corner, Section 8, T8N-R1E

This position was not established by original government survey.

Shiawassee County survey by Lyman Mason, Feb. 1878, Recorded in Book C, Pgs 156-157 & Book D, Pgs. 170-171, S.C.D.R.  
No monument or witnesses given

Clinton County Survey by Allen Beach, March 1921  
No monument or witnesses given

B. Description of corner evidence found and/or method applied in restoring or reestablishing corner:

D-4 Closing 1/4 Corner, Section 8, T8N-R1E

Found no evidence of a monument representing this corner position. Established the corner position on the Michigan Meridian at a midpoint between the Closing Section corners of Section 8.

There appears to be no conflicting evidence and this position is accepted as a careful and faithful determination of the position of the corner.

Approved by the Shiawassee County Remonumentation Peer Review Group.

C. Description of monument for corner and accessories established to perpetuate locating the position of the corner:

D-4 Closing 1/4 Corner, Section 8, T8N-R1E

Placed a Standard Harrison monument on the Michigan Meridian, falls in cl gravel road

N35E 69.27' Set PK w/tag #39096 in SW root of 20" Maple  
N80E 77.85' SW cor. of conc. hse fndn hse #7494  
S75E 35.54' Set PK w/tag #39096 N. fc P/P  
S30W 67.72' Set PK w/tag #39096 E. fc P/P

APPROVED

County Remonumentation  
Peer Review Group

*NCC*  
*10 OCT 97*



Signed by Wendy A. Papineau

Date 10-09-97

Surveyor's Michigan License No. 41919

LIBER 1R PG 196

# A PORTION OF THE MICHIGAN MERIDIAN

RETRACEMENT AND REMONUMENTATION PROJECT  
FOR  
CLINTON AND SHIAWASSEE COUNTIES, MICHIGAN  
MARCH - SEPTEMBER 1997

BY  
**ROWE ENGINEERING, INC.**  
112 E. MCARTHUR STREET  
CORUNNA, MI 48807

SURVEY &  
REMONUMENTATION

NOV 10 1997

COMMISSION

BEARINGS ARE BASED ON A PREVIOUS REMONUMENTATION PROJECT JANUARY THROUGH MAY, 1996 BY ROWE ENGINEERING, INC. JOB NO. S-4830 AND ALSO A SOLAR OBSERVATION AT THE NORTH END OF THE 1997 REMONUMENTATION PROJECT



SHEET 2 OF 2 SHEETS

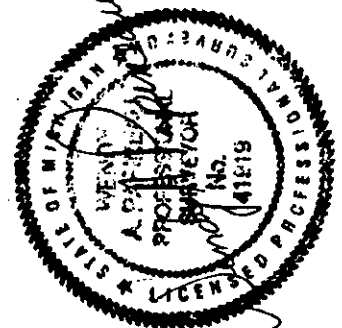

**LIBER** 1R PG 197

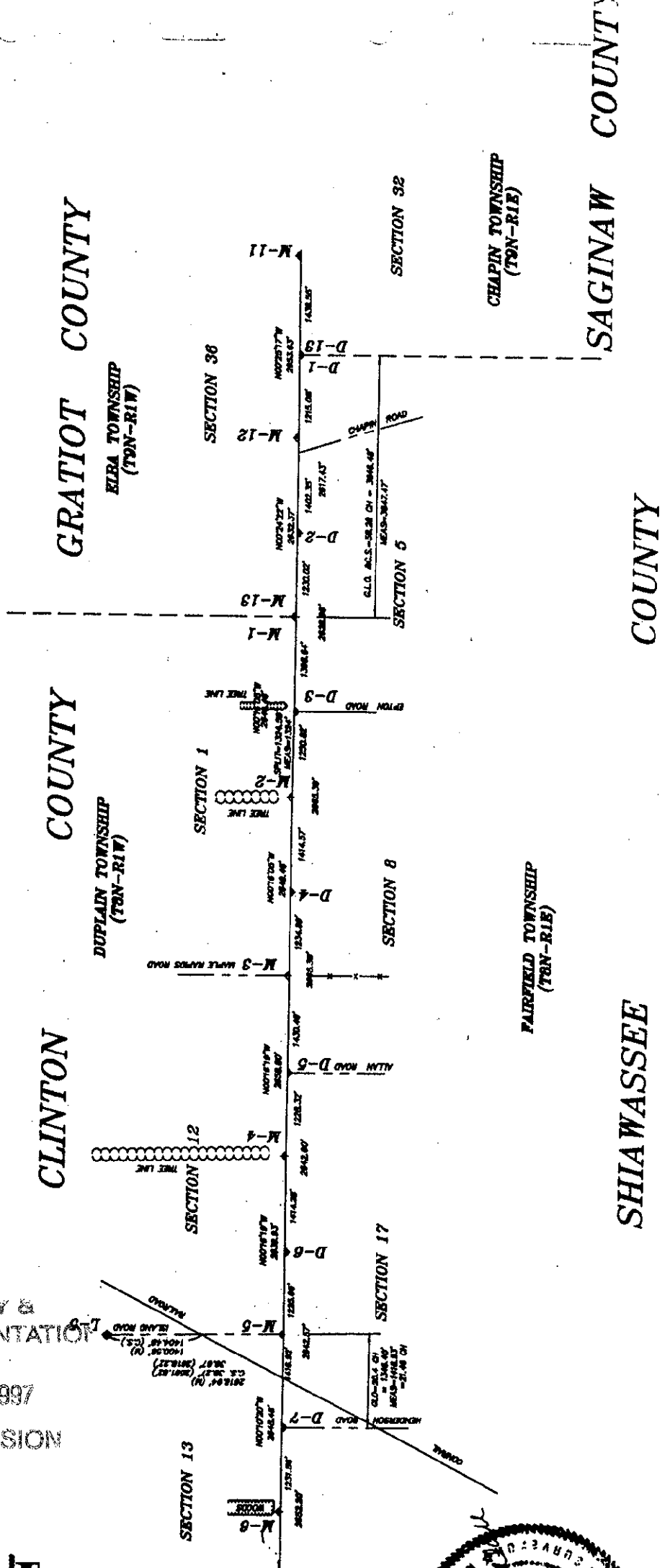

CLINTON COUNTY

GRATIOT COUNTY

SHIAWASSEE COUNTY

SAGINAW COUNTY

DUPLAIN TOWNSHIP (T9N-R1W)

ELBA TOWNSHIP (T9N-R1W)

CHAPIN TOWNSHIP (T9N-R1E)

FAIRFIELD TOWNSHIP (T8N-R1E)