

**SURVEY & REMONUMENTATION**

NOV 10 1997

**LAND CORNER RECORDATION CERTIFICATE**

Filing Requirement of Act 74, Mich. P.A. 1970

COMMISSION

RECORDED

97 OCT 15 PM 12:14

REGISTER OF DEEDS

*Kaye Shubert*  
SHIAWASSEE COUNTY, MICH.

For corners in

Shiawassee  
(County)

Located In:

Fairfield Twp

Corner Code #

1. Public Land Survey	T	8N	R	1E	D-7
	T		R		
	T		R		
	T		R		
2. Property Controlling in Section	S	T	R		
	S	T	R		
3. Miscellaneous Property in Sec.	S	T	R		
	S	T	R		

Register of Deeds Stamp & File Number

4. Lot No. \_\_\_\_\_, Recorded Plat \_\_\_\_\_  
5. Private Claims \_\_\_\_\_

I, Wendy A. Papineau, in a field survey on June 1997, do hereby certify that under requirements of P.A. 74, Michigan P.A. of 1970, the corner points mentioned in lines 1 and 2 above were in conformance with regulations and rules therefore as required in the current manual of survey instructions of the United States Department of the Interior, Bureau of Land Management or by a decree of a Court of Law and/or that the corner points mentioned in lines 3, 4 and 5 above were in conformance with the rules of the Michigan Board of Land Surveyors or by a Decree of a Court of Law, established, re-established, monumented, re-monumented, recovered, found as expressed below:

	A	B	C	D	E	F	G	H	I	J	K	L	M
1													
2	6		5		4		3		2		1		
3													
4	7		8		9		10		11		12		
5													
6	18		17		16		15		14		13		
7													
8	19		20		21		22		23		24		
9													
10	30		29		28		27		26		25		
11													
12	31		32		33		34		35		36		
13													

NOTE: Not more than 4 corners, all in the same town and range, may be recorded on this certificate.

A. Description of original monument and accessories and/or subsequent restoration:

D-7 Closing Corner, Section 17 and Section 20, T8N-R1E

Wood post placed by R. Thomas, D.S., March 16, 1831  
Intersected the Meridian 20.40 chs S. of post  
S57 1/2E 25 lks (16.50') 12" Sugar  
N75E 44 lks (29.04') 29" Oak

**APPROVED**  
County Remonumentation  
Peer Review Group

*NCC*  
*10 OCT 97*

B. Description of corner evidence found and/or method applied in restoring or reestablishing corner:

D-7 Closing Corner, Section 17 and Section 20, T8N-R1E

Found pk nail 3.86' W. of the Michigan Meridian and 2.5' E. of the centerline of Meridian Road, origin unknown. The distance North to M-5, T8N-R1W, does not fit well. It appears that the deputy surveyor dropped a chain (G.L.O. 20.40ch = 1346.40' Meas. = 1416.93' = 21.46ch) in its call to the falling with the Michigan Meridian.

Calculated a position at the true intersection (per Sec. 5-41, Manual of Instructions, 1973) of the Michigan Meridian and a line Due East of the existing pk nail and this position is accepted as the best available evidence of the position of the corner.

Approved by the Shiawassee County Remonumentation Peer Review Group September 4, 1997.

C. Description of monument for corner and accessories established to perpetuate locating the position of the corner:

D-7 Closing Corner, Section 17 and Section 20, T8N-R1E

Placed a standard Harrison Monument on the Michigan Meridian and a monument box.

West 3.86' Fnd pk nail  
S50W 42.28' Set N&T #39096 SE fc P/P  
S35E 127.05' Set N&T #39096 W. fc P/P  
N25E 56.28' Set N&T #39096 SE fc phone riser pole  
West 23.44' South leg of <-> sign post



Signed by Wendy A. Papineau  
Surveyor's Michigan License No. 41919

Date 10-09-97

FORM APPROVED BY MICHIGAN STATE BOARD OF LAND SURVEYORS, JAN. 28, 1971

REVISED MAY 14, 1976  
REVISED JAN., 1983  
ADAPTED FOR WORD PROCESSING MARCH, 1983

**LIBER** 1R **PG** 202

BEARINGS ARE BASED ON A  
 PREVIOUS RECONSTRUCTION  
 PROJECT JANUARY THROUGH  
 MAY 1988 BY ROWE ENGINEERING, INC.  
 JOB NO. S-4830 AND ALSO A SOLAR  
 OBSERVATION AT THE NORTH END OF  
 THE 1887 RECONSTRUCTION PROJECT

A PORTION OF

# THE MICHIGAN MERIDIAN

RETACEMENT AND REMONUMENTATION PROJECT  
 FOR  
 CLINTON AND SHAWASSEE COUNTIES, MICHIGAN  
 MARCH - SEPTEMBER 1997

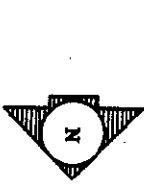

SHEET 1 OF 2 SHEETS



MIDDLEBURY TOWNSHIP  
 (77N-11E)

SECTION 5

M-12  
 (FROM 1888)

SECTION 36

D-13  
 (FROM 1888)

COLONY ROAD

M-11  
 (FROM 1888)

SECTION 32

D-12

SECTION 25

M-10

CLINTON

JEDVILLE ROAD

D-11

FRENCH ROAD

DUPLAIN TOWNSHIP  
 (77N-11W)

M-9

D-10

SECTION 24

M-8

FAIRFIELD TOWNSHIP  
 (77N-11E)

SHAWASSEE & CLINTON DRAIN No. 1

SECTION 28  
 COUNTY ACQUISITION BY  
 DEN WISSE AND

SECTION 29

MEY ROAD

D-9

M-7

SECTION 20

M-6

SHAWASSEE & CLINTON DRAIN No. 2

D-8

SECTION 13

M-5

MENDOCINO ROAD

D-7

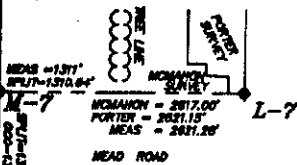

COUNTY

SHAWASSEE

COUNTY

BY  
**ROWE ENGINEERING, INC.**  
 112 E. MCARTHUR STREET  
 CORUNNA, MI 48837

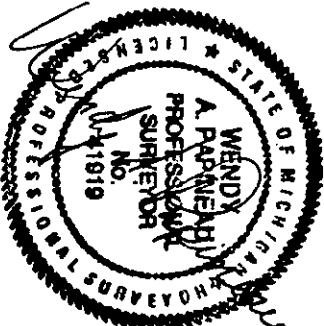

SURVEY &  
 REMONUMENTATION

NOV 10 1997

COMMISSION