

SURVEY & REMONUMENTATION

NOV 10 1997

COMMISSION

LAND CORNER RECORDATION CERTIFICATE

Filing Requirement of Act 74, Mich. P.A. 1970

RECORDED

97 OCT 15 PM 12:14

REGISTER OF DEEDS

Kaye Shultz
SHIAWASSEE COUNTY, MICH.

For corners in

Shiawassee
(County)

Located In:

Fairfield Twp

Corner Code #

1. Public Land Survey	T	8N	R	1E	D-8
	T		R		
	T		R		
	T		R		
2. Property Controlling in Section	S	T	R		
	S	T	R		
3. Miscellaneous Property in Sec.	S	T	R		
	S	T	R		

Register of Deeds Stamp & File Number

4. Lot No. _____, Recorded Plat _____
5. Private Claims _____

I, Wendy A. Papineau, in a field survey on June 1997 do hereby certify that under requirements of P.A. 74, Michigan P.A. of 1970, the corner points mentioned in lines 1 and 2 above were in conformance with regulations and rules therefore as required in the current manual of survey instructions of the United States Department of the Interior, Bureau of Land Management or by a decree of a Court of Law and/or that the corner points mentioned in lines 3, 4 and 5 above were in conformance with the rules of the Michigan Board of Land Surveyors or by a Decree of a Court of Law, established, re-established, monumented, re-monumented, recovered, found as expressed below:

NOTE: Not more than 4 corners, all in the same town and range, may be recorded on this certificate.

A. Description of original monument and accessories and/or subsequent restoration:

D-8 Closing 1/4 Corner, Section 20, T8N-R1E

This position was not established by original government survey.

There are no records that indicate subsequent establishment or use of this position.

B. Description of corner evidence found and/or method applied in restoring or reestablishing corner:

D-8 Closing 1/4 Corner, Section 20, T8N-R1E

Found no evidence of a monument representing this position; therefore, it was established on the Michigan Meridian at a midpoint between the Closing Section corners of Section 20.

There appears to be no conflicting evidence and this position is accepted as a careful and faithful determination of the position of the corner.

Approved by the Shiawassee County Remonumentation Peer Review Group September 4, 1997.

APPROVED

County Remonumentation Peer Review Group

NCC
10 OCT 97

C. Description of monument for corner and accessories established to perpetuate locating the position of the corner:

D-8 Closing 1/4 Corner, Section 20, T8N-R1E

Placed a standard Harrison monument in a monument box
N45E 37.78' Set PK w/tag #39096 SE fc P/P
S75E 25.52' Set N&T #39096 S. fc 20" Maple
S35W 43.67' Set N&T #39096 SE fc 6" Ash
N40W 55.40' Set pk w/tag #39096 NE fc P/P



Signed by Wendy A. Papineau

Date 10-9-97

Surveyor's Michigan License No. 41919

FORM APPROVED BY MICHIGAN STATE BOARD OF LAND SURVEYORS, JAN. 26, 1971
REVISED MAY 14, 1975
REVISED JAN., 1983
ADAPTED FOR WORD PROCESSING MARCH, 1983

LIBER 1R PG 204

BEARINGS ARE BASED ON A
 PREVIOUS REMONUMENTATION
 PROJECT JANUARY THROUGH
 MAY, 1986 BY ROWE ENGINEERING, INC.
 JOB NO. S-4830 AND ALSO A SOLAR
 OBSERVATION AT THE NORTH END OF
 THE 1987 REMONUMENTATION PROJECT

MICHIGAN THE MERIDIAN

A PORTION OF

RETACEMENT AND REMONUMENTATION PROJECT
 FOR
 CLINTON AND SHIAWASSEE COUNTIES, MICHIGAN
 MARCH - SEPTEMBER 1997

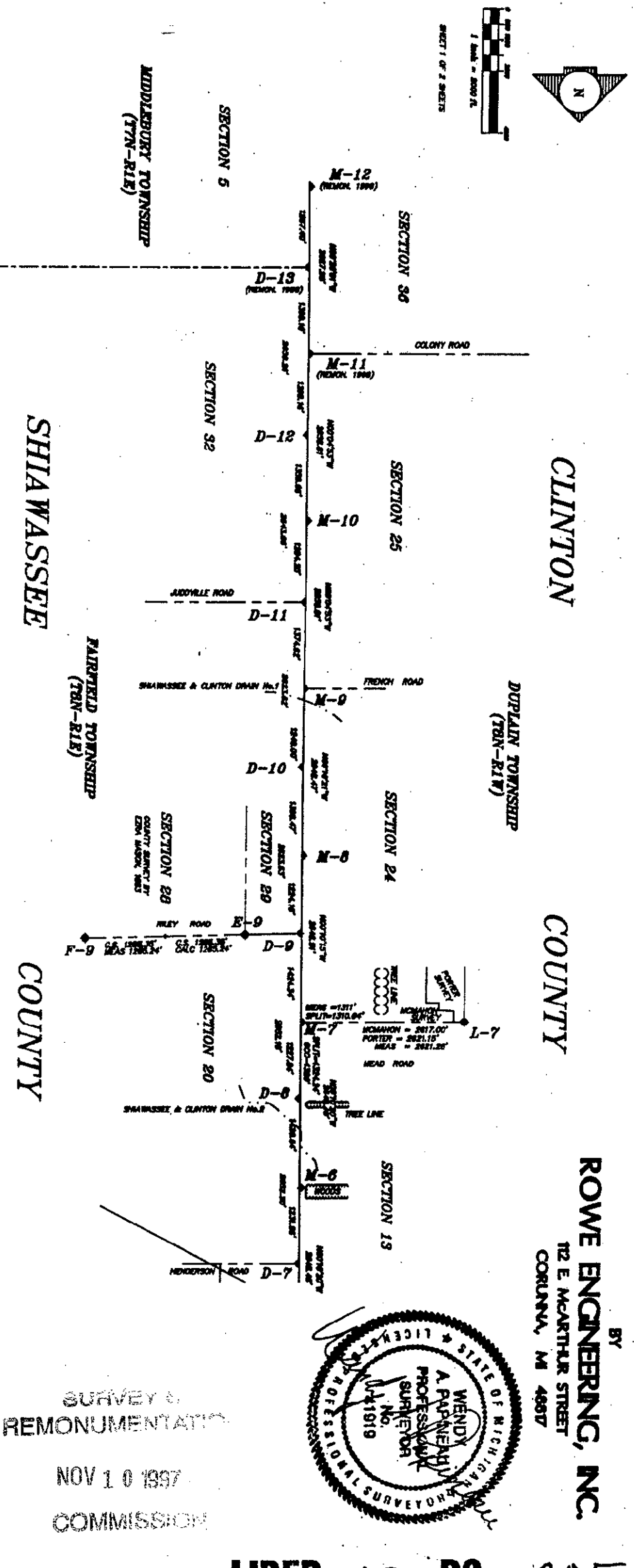

BY
ROWE ENGINEERING, INC.
 112 E. McARTHUR STREET
 CORUNNA, MI 48937

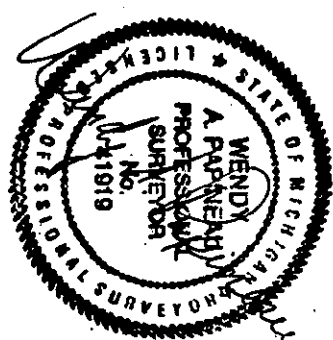

SURVEY &
 REMONUMENTATION
 NOV 10 1997
 COMMISSION