

NOV 10 1997

LAND CORNER RECORDATION CERTIFICATE
Filing Requirement of Act 74, Mich. P.A. 1970

RECORDED

97 OCT 15 PM 12:14

REGISTER OF DEEDS

Kaye Smith
SHIAWASSEE COUNTY, MICH.

For corners in

Shiawassee
(County)

Located In:

Fairfield Twp

Corner Code #

1. Public Land Survey	T	8N	R	1E	D-11
	T		R		
	T		R		
	T		R		
2. Property Controlling in Section	S	T	R		
	S	T	R		
3. Miscellaneous Property in Sec.	S	T	R		
	S	T	R		

Register of Deeds Stamp & File Number

4. Lot No. _____, Recorded Plat _____
5. Private Claims _____

I, Wendy A. Papineau, in a field survey on June 1997, do hereby certify that under requirements of P.A. 74, Michigan P.A. of 1970, the corner points mentioned in lines 1 and 2 above were in conformance with regulations and rules therefore as required in the current manual of survey instructions of the United States Department of the Interior, Bureau of Land Management or by a decree of a Court of Law and/or that the corner points mentioned in lines 3, 4 and 5 above were in conformance with the rules of the Michigan Board of Land Surveyors or by a Decree of a Court of Law; established, re-established, monumented, re-monumented, recovered, found as expressed below.

NOTE: Not more than 4 corners, all in the same town and range, may be recorded on this certificate.

A. Description of original monument and accessories and/or subsequent restoration:

D-11 Closing Corner, Section 29 and Section 32, T8N-R1E

Wood post placed by R. Thomas, D.S., March 16, 1831
S67E 3 lks (1.98') 8" Birch
N25E 2 lks (1.32') 6" Sugar

County Surveys by O.M. Elliot, C.S. Recorded in Elliot's Field Book, Book 27, P.65, 1958
"Old resident reports old stone corner removed by Road Department- is at NE corner of intersection"
SE 98.5' NW Cor. hse
NE 42.0' Road sign post

L.C.R.C. by M.L. Vanraemdonck, Sept. 1984,
Recorded in L. 2, P. 399, S.C.R.
Set reroed & cap #24622 using ties from the Shiawassee County Drain Office
S45E 98.50' NW Cor. hse fndn
N45E 42.00' Road sign post
West 2.6' Physical cl asphalt
South 4.0' Physical cl Juddville Rd

APPROVED
County Remonumentation
Peer Review Group

NCC
10 OCT 97

B. Description of corner evidence found and/or method applied in restoring or reestablishing corner:

D-11 Closing Corner, Section 29 and Section 32, T8N-R1E

Found record 1/2" rod 3' E. of centerline of Meridian Road and 6' N. of centerline of Juddville Road. This position falls 2.37' East of the Michigan Meridian.

Calculated a position at the true intersection (per Sec.5-41, Manual of Instructions, 1973) of the Michigan Meridian and a line Due West of the existing 1/2" iron (Amended Corner).

This position is accepted as a careful and faithful determination of the true position of the corner.

Approved by the Shiawassee County Remonumentation Peer Review Group September 4, 1997.

C. Description of monument for corner and accessories established to perpetuate locating the position of the corner:

D-11 Closing Corner, Section 29 and Section 32, T8N-R1E

Placed a standard Harrison monument in a monument box at the true point of intersection

East 2.37' End 1/2" rod w/cap #12018 (Amended Corner)
S45E 100.15' NW cor hse #3720 foundation
S89W 25.06' North edge of N.leg <-> sign post
N60E 41.62' South edge of Stop sign post
S20W 116.40' East edge of sign post (Welcome to Clinton County)

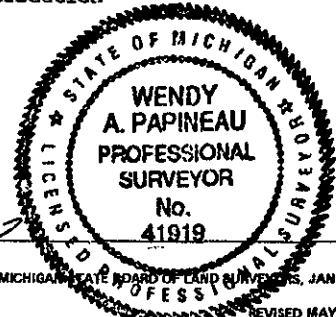

Signed by Wendy A. Papineau

Date 10-09-97

Surveyor's Michigan License No. 41919

FORM APPROVED BY MICHIGAN STATE BOARD OF LAND SURVEYORS, JAN. 28, 1971

REVISED MAY 14, 1975
REVISED JAN., 1983
ADAPTED FOR WORD PROCESSING MARCH, 1993

LIBER IR PG 210

BEARINGS ARE BASED ON A PREVIOUS REMONUMENTATION PROJECT JANUARY THROUGH MAY, 1986 BY ROWE ENGINEERING, INC. JOB NO. S-4830 AND ALSO A SOLAR OBSERVATION AT THE NORTH END OF THE 1987 REMONUMENTATION PROJECT



SHEET 1 OF 2 SHEETS



MICHIGAN MERIDIAN

A PORTION OF

THE

A

RETRACEMENT AND REMONUMENTATION PROJECT

FOR

CLINTON AND SHAWASSEE COUNTIES, MICHIGAN

MARCH - SEPTEMBER 1997

CLINTON

COUNTY

ROWE ENGINEERING, INC.

112 E MCARTHUR STREET
CORUNNA, MI 48837

DUPLAIN TOWNSHIP
(78N-R1W)

MIDDLEBURY TOWNSHIP
(77N-R1E)

FAIRFIELD TOWNSHIP
(78N-R1E)

SHIAWASSEE

COUNTY

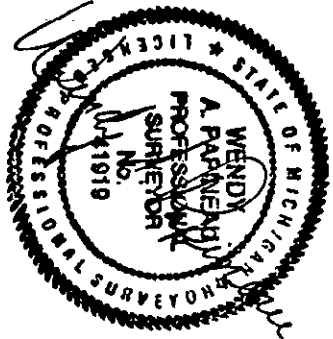
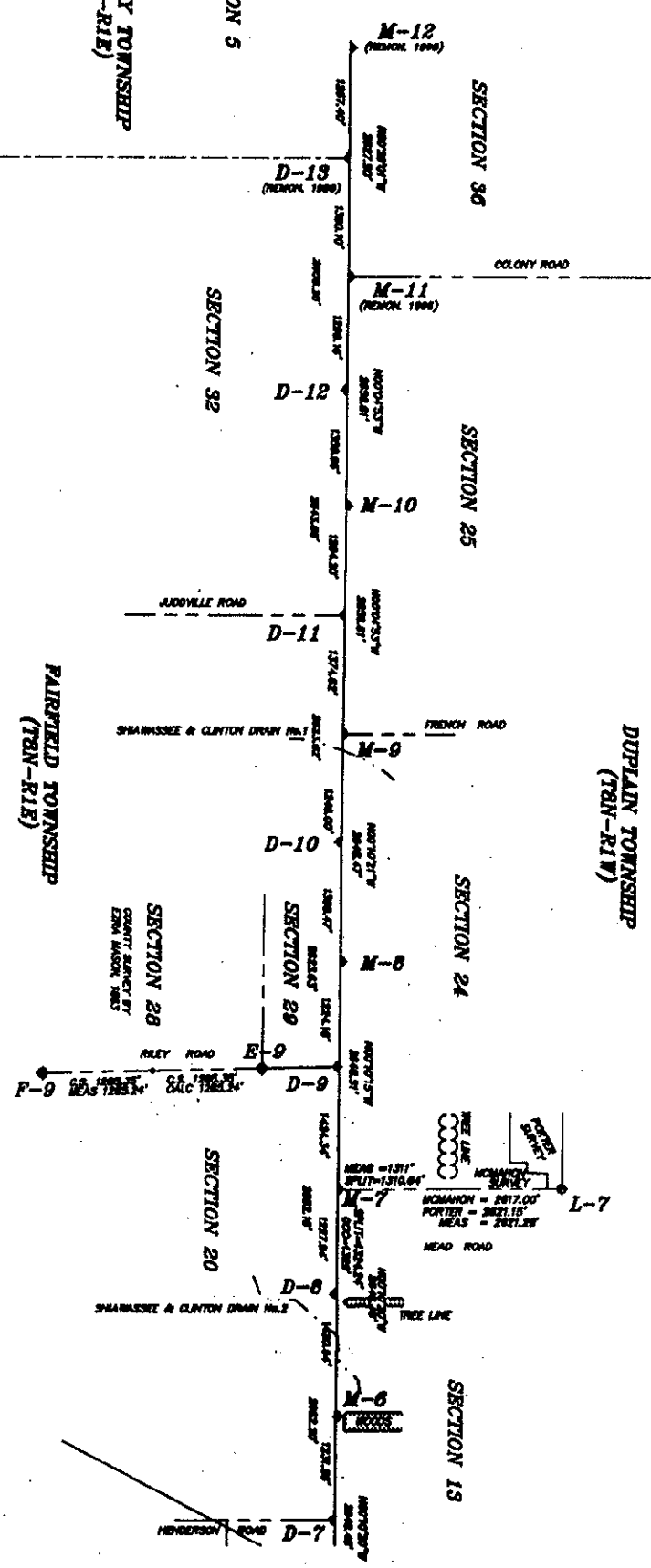

SURVEY & REMONUMENTATION
NOV 10 1997
COMMISSION

LAND CORNER RECORDATION CERTIFICATE

Filing Requirement of Act 74, Mich. P.A. 1970

SURVEY & REMONUMENTATION

For corners in

Shiawassee (County)

Located In:

Fairfield Twp

Corner Code #

- 1. Public Land Survey T 8N R 1E D-11 (Amended)
2. Property Controlling in Section S T R
3. Miscellaneous Property in Sec. S T R

NOV 10 1997

COMMISSION

Register of Deeds Stamp & File Number

- 4. Lot No. Recorded Plat
5. Private Claims

I, Wendy A. Papineau, in a field survey on June 1997 do hereby certify that under requirements of P.A. 74, Michigan P.A. of 1970, the corner points mentioned in lines 1 and 2 above were in conformance with regulations and rules therefore as required in the current manual of survey instructions of the United States Department of the Interior, Bureau of Land Management or by a decree of a Court of Law and/or that the corner points mentioned in lines 3, 4 and 5 above were in conformance with the rules of the Michigan Board of Land Surveyors or by a Decree of a Court of Law, established, re-established, monumented, re-monumented, recovered, found as expressed below.

Table with 13 rows and 12 columns (A-L) containing numbers 1-36.

NOTE: Not more than 4 corners, all in the same town and range, may be recorded on this certificate.

A. Description of original monument and accessories and/or subsequent restoration:

D-11 Amended Closing Corner, Section 29 and Section 32, T8N-R1E

Wood post placed by R. Thomas, D.S., March 16, 1831. S67E 3 lks (1.98') 8" Birch N25E 2 lks (1.32') 6" Sugar

County Surveys by O.M. Elliot, C.S. Recorded in Elliot's Field Book, Book 27, P.65, 1958 "Old resident reports old stone corner removed by Road Department- is at NE corner of intersection" SE 98.5' NW Cor. hse NE 42.0' Road sign post

I.C.R.C. by M.L. Vanraendonck, Sept. 1984, Recorded in L. 2, P. 399, S.C.R. Set rerod & cap #24622 using ties from the Shiawassee County Drain Office S45E 98.50' NW Cor. hse fndn N45E 42.00' Road sign post West 2.6' Physical cl asphalt South 4.0' Physical cl Juddville Rd

B. Description of corner evidence found and/or method applied in restoring or reestablishing corner:

D-11 Amended Closing Corner, Section 29 and Section 32, T8N-R1E

Found record 1/2" rod 3' E. of centerline of Meridian Road and 6' N. of centerline of Juddville Road. This position falls 2.37' East of the Michigan Meridian.

This position is accepted as an amended corner and approved by the Shiawassee County Remonumentation Peer Review Group September 4, 1997.

APPROVED

NCL 10 OCT 97

County Remonumentation Peer Review Group

C. Description of monument for corner and accessories established to perpetuate locating the position of the corner:

D-11 Amended Closing Corner, Section 29 and Section 32, T8N-R1E

Found record 1/2" rod West 2.37' Set a Standard Harrison monument in a mon. box on the Michigan Meridian S45E 98.50' NW cor hse #3720 foundation S89W 27.45' North edge of N.leg <-> sign post N60E 39.43' South edge of Stop sign post S20W 116.80' East edge of sign post (Welcome to Clinton County)



Signed by Wendy A. Papineau

Date 10-09-97

Surveyor's Michigan License No. 41919

FORM APPROVED BY MICHIGAN STATE BOARD OF LAND SURVEYORS, JAN. 28, 1971

LIBER 1R PG 212

BEARINGS ARE BASED ON A PREVIOUS REMONUMENTATION PROJECT JANUARY THROUGH MAY, 1988 BY ROWE ENGINEERING, INC. JOB NO. S-4830, AND ALSO A SOLAR OBSERVATION AT THE NORTH END OF THE 1997 REMONUMENTATION PROJECT

A PORTION OF

THE MICHIGAN MERIDIAN

RETRACEMENT AND REMONUMENTATION PROJECT
FOR
CLINTON AND SHAWASSEE COUNTIES, MICHIGAN
MARCH - SEPTEMBER 1997



SHEET 1 OF 2 SHEETS

PAGE 4 OF 4

MIDDLEBURY TOWNSHIP
(T7N-R1E)

SECTION 6

M-12
(RECON. 1988)

SECTION 36

D-13
(RECON. 1988)

COLONY ROAD

M-11
(RECON. 1988)

SECTION 25

D-12

CLINTON

M-10

SECTION 32

JUDOVILLE ROAD

D-11

FRENCH ROAD

DUPLAIN TOWNSHIP
(T7N-R1W)

M-9

D-10

FAIRFIELD TOWNSHIP
(T7N-R1E)

SECTION 24

M-8

SECTION 28
COUNTY SURVEY BY
EDM. WILSON 1883

SECTION 29

RILEY ROAD

D-9

M-7

F-9
224.51± 138.23±
52c 138.23±

SECTION 20

SECTION 20

M-6

SHAWASSEE & CLINTON DRAIN No. 2

D-8

SECTION 13

M-5

HENDERSON ROAD

D-7

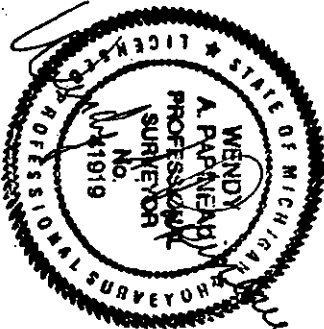

BY
ROWE ENGINEERING, INC.
112 E. MCARTHUR STREET
CORUNNA, MI 48837

SURVEY &
REMONUMENTATION

NOV 10 1997

COMMISSION