

1999
 REMONUMENTATION PROGRAM
LAND CORNER RECORDATION CERTIFICATE
 Filing Requirement of Act 74, Mich. P.A. 1970

COPY

RECEIVED FOR RECORD
 NUMBER NO. _____ PAGE NO. _____
 FILE NO. ARBELA TWP. #108
 99 DEC -7 PM 3:31
 TUSCOLA COUNTY
 REGISTER OF DEEDS

For corners in Arbela Twp.

<u>Tuscola</u> (County)	Located In:	Corner Code #
1. Public Land Survey	T10N R7E	L-11
	T___ R___	_____
	T___ R___	_____
	T___ R___	_____
2. Property Controlling in Section	S___ T___ R___	_____
	S___ T___ R___	_____
3. Miscellaneous Property in Sec.	S___ T___ R___	_____
	S___ T___ R___	_____

Register of Deeds Stamp & File Number

4. Lot No. _____, Recorded Plat _____
 5. Private Claims _____

I, Kenneth D. Dunton, in a field survey on July 18, 1999 do hereby state that under requirements of P.A. 74, Michigan P.A. of 1970, the corner points mentioned in lines 1 and 2 above were in conformance with regulations and rules therefore as required in the current manual of survey instructions of the United States Department of the Interior, Bureau of Land Management or by a decree of a Court of Law and/or that the corner points mentioned in lines 3, 4 and 5 above were in conformance with the rules of the Michigan Board of Land Surveyors or by a Decree of a Court of Law; established, re-established, monumented, recovered, found as expressed below:

NOTE: Not more than 2 corners, all in the same town and range, may be recorded on this certificate.

A	B	C	D	E	F	G	H	I	J	K	L	M
1												
2	6	5	4	3	2	1						
3												
4	7	8	9	10	11	12						
5												
6	18	17	16	15	14	13						
7												
8	19	20	21	22	23	24						
9												
10	30	29	28	27	26	25						
11												
12	31	32	33	34	35	36						
13												

A. Description of original monument and accessories and/or subsequent restoration:

June, 1822, Joseph Fletcher, D.S. Set 1/4 corner to Secs. 25 & 36, T10N-R7E, W. Ash 20" S19°W 37 links, Elm 20" N74°W 27 links. Aug. 27, 1888 Survey of Sec. 36 by John A. Teskey, Co. Surveyor, proportional distances, stone & crockery at corner. April 11, 1973 L.C.R.C. Page 26 by David T. Rowe, P.S. #11192, fnd. "T" iron, South 24.06' nail in 15" Maple, S65°W 65.86' nail in 12" Maple, N55°W 60.64' nail in 10" Maple. June 17, 1974 L.C.R.C. Page 65 by Bernard Griggs, Jr., P.S. #14763, corner form labeled L-11 but in fact, the object & accessories match corner K-11, T10N-R7E. July 1, 1996 Survey L-707, Page 1147 by John M. Juras, P.S. #33980, "T" iron, S 24.06' nail in 15" Maple, N65°W 65.86' nail in 12" Maple, N55°W 60.64' nail in 10" Maple.

B. Description of corner evidence found and/or method applied in restoring or reestablishing corner:

1999 L-11 Found 18" x 3/4" pipe (bent) at SW face pointed stone, found 18" x 3/4" pipe surrounded by crockery below bent pipe. Accepted pipes, stone & crockery as the best evidence of the original corner position.

C. Description of monument for corner and accessories established to perpetuate locating the position of the corner:

L-11 Removed pipes, stone & crockery and perpetuated with standard monument with brass cap stamped L-11, T10N-R7E. Replaced crockery around monument.
 N68°W 65.95' set remon. tag & spike in S. face 20" Hickory.
 N57°W 61.20' set remon. tag & spike in SW face 15" Hickory.
 N24°E 33.00' set remon. tag & spike in SE face 12" Ash.
 S13°W 27.05' set remon. tag & spike in E. face cor. post.

Signed by [Signature]
 Surveyor's Michigan License No. 23503

Date 12-1-1999

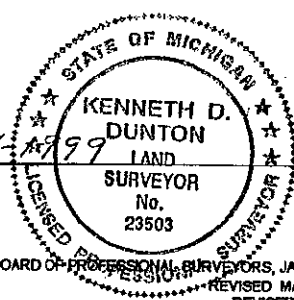

APPROVED
12-1-1999
 [Signatures]

Section 25

ARBELA ROAD

1822 Fletcher 2633.40'
1888 Teskey 2610.96'
1999 Dunton 2614.62'

1822 Fletcher 2633.40'
1888 Teskey 2610.96'
1999 Dunton 2614.64'

K-11

M-11

1999 Dunton
90°03'55"

L-11
1999 Dunton
180°00'05"

Section Line

1999 Dunton
90°22'45"

1822 Fletcher 2640'
1888 Teskey 2650.56'
1999 Dunton 2655.02'

Section Line

1994 Dunton
180°24'26"
1999 Dunton
180°23'20"
Note 1994 error.

1994 Dunton 2629.87'
1999 Dunton 2629.82'

Township Line

ROAD

MILLINGTON TOWNSHIP T10N-R8E

SECTION 36, T10N-R7E

Unadjusted error of closure = 1/50,616.
Adjusted compass rule method.

1994 & 1999
Dunton
179°50'10"

M-12

SECTION 35

BELSAY ROAD

1822 Fletcher 2640'
1888 Teskey 2650.56'
1999 Dunton 2654.81'

K-13

1999 Dunton
89°23'35"

Township Line

1999 Dunton
179°59'05"

L-13

No angles measured
1993 & 1994 by
Rowe or Dunton

1999 Dunton
90°19'55"

1994 Dunton 2630.45'
1999 Dunton 2630.40'

VASSAR ROAD

1994 Dunton
1999 Dunton

M-13

1993 Rowe 2633.12'
1999 Dunton 2633.23'

1993 Rowe 2630.28'
1999 Dunton 2630.20'

WILLARD ROAD

GENESEE COUNTY