

1993

1993 REMONUMENTATION PROGRAM
LAND CORNER RECORDATION CERTIFICATE

Filing Requirement of Act 74, Mich. P.A. 1970

COMMISSION

RECEIVED FOR RECORD
LIBER NO. PAGE NO. 79
FILING NO. Millington
93 NOV 19 PM 1:25
VIRGINIA G. JOHNSON
TUSCOLA COUNTY
REGISTER OF DEEDS

For corners in TUSCOLA (County) Located In: MILLINGTON TOWNSHIP Corner Code # J-13

1. Public Land Survey	T	10	N	R	8	E	
	T			R			
	T			R			
	T			R			
2. Property Controlling in Section	S			T		R	
	S			T		R	
3. Miscellaneous Property in Sec.	S			T		R	
	S			T		R	

Register of Deeds Stamp & File Number

4. Lot No. _____, Recorded Plat _____
5. Private Claims _____

I, JONATHAN M. FIELD, in a field survey on OCTOBER 19 93, do hereby certify that under requirements of P.A. 74, Michigan P.A. of 1970, the corner points mentioned in lines 1 and 2 above were in conformance with regulations and rules therefore as required in the current manual of survey instructions of the United States Department of the Interior, Bureau of Land Management or by a decree of a Court of Law and/or that the corner points mentioned in lines 3, 4 and 5 above were in conformance with the rules of the Michigan Board of Land Surveyors or by a Decree of a Court of Law; established, re-established, monumented, re-monumented, recovered, found as expressed below:

NOTE: Not more than 4 corners, all in the same town and range, may be recorded on this certificate.

	A	B	C	D	E	F	G	H	I	J	K	L	M
1													
2	6		5		4		3		2		1		
3													
4	7		8		9		10		11		12		
5													
6	18		17		16		15		14		13		
7													
8	19		20		21		22		23		24		
9													
10	30		29		28		27		26		25		
11													
12	31		32		33		34		35		36		
13													

A. Description of original monument and accessories and/or subsequent restoration:
 1821 GLO - WAMPLER, D.S.; SET 1/2 MILE POST; SUGAR 12" S89E 39LKS., SUGAR 11" N83W 38LKS.
 1975 TUSCOLA CO. RD. COM.; WIT CARD - FND 5/8" X 30" ROD; S. 39.3' P-K NAIL 4" ASH, N45E 39.0' P-K NAIL FENCE POST, S30E 103.2' P-K NAIL 8" ASH
 1976 AMERICAN CIVIL ENG. - PIOTROWSKI, P.S.#9685; SURVEY L.511, PG.166-168 - FND 1/2" ROD W/CAP; N05W 34.6' FENCE POST, N60W 62.3' FENCE POST, WEST 163.53' N1/4 COR SEC.2, T9N-R8E
 1977 MILLER, P.S.#12024; LCRC PG.47 - SET 1/2" ROD W/CAP BY SPLITTING MILE FOR DISTANCE AND HOLDING NORTH LINE OF T9N-R8E FOR LINE; WITS SAME AS 1976 AM. CIVIL ENG. SURVEY

B. Description of corner evidence found and/or method applied in restoring or reestablishing corner:
 1993 ROWE ENG. - FIELD, P.S. #37276; FND 1/2" ROD; 1' N C/L OF GRAV. ROAD E-W; FND NO OTHER EVIDENCE
 ACCEPTED 1/2" ROD AS BEST EVIDENCE OF ORIGINAL CORNER LOCATION

COPY

SEE ALSO BACK OF THIS FORM

C. Description of monument for corner and accessories established to perpetuate locating the position of the corner:
 J-13 REMOVED 1/2" ROD, SET STANDARD MONUMENT (5/8" X 36" ROD W/ BRASS CAP IN CONC)
 NORTH, 18.02' SET 1/2" ROD W/CAP #37276
 S60°E, 27.36' SET 1/2" ROD W/CAP #37276
 S48°W, 26.94' SET 1/2" ROD W/CAP #37276
 N50°W, 89.05' SET NAIL W/REMON TAG ABOVE FND NAIL W/TAG #12024 IN SW FACE P. POLE
 N60°W, 62.22' SET NAIL W/REMON TAG ABOVE FND P-K NAIL W/FLAG. IN S. FACE FENCE POST
 WEST, 163.06' FND 3/4" ROD

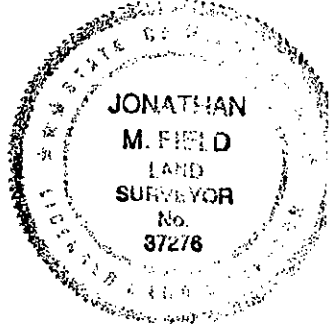

Signed by Jonathan M. Field Date 10-27-93
 Surveyor's Michigan License No. 37276

APPROVED
 10-25-93

1500
 J.M.F.
 J.M.F.

COPY

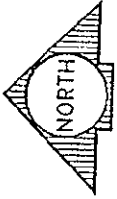

SECTION 35
T10N-R8E

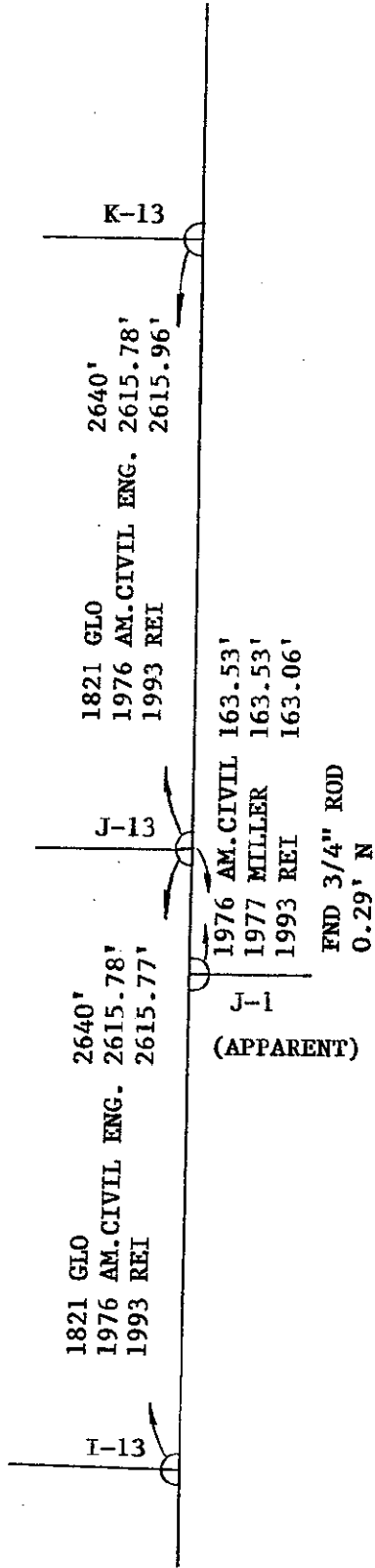

SECTION 2
T9N-R8E