

SURVEY & REMONUMENTATION

MAY 05 1997

1996 REMONUMENTATION PROGRAM

COMMISSION

LAND CORNER RECORDATION CERTIFICATE
Filing Requirement of Act 74, Mich. P.A. 1970

For corners in Millington Twp.

TUSCOLA
(County)

Located In:

Corner Code 77

- | | | |
|---------------------------------------|--------------------------|--------------|
| 1. Public Land Survey | T <u>10N</u> R <u>8E</u> | <u>M-1</u> ✓ |
| | T _____ R _____ | |
| | T <u>11N</u> R <u>8E</u> | <u>M-13</u> |
| | T _____ R _____ | |
| 2. Property Controlling in Section | S _____ T _____ R _____ | |
| | S _____ T _____ R _____ | |
| 3. Miscellaneous Property in Sec. | S _____ T _____ R _____ | |
| | S _____ T _____ R _____ | |
| 4. Lot No. _____, Recorded Plat _____ | | |
| 5. Private Claims _____ | | |

RECEIVED FOR RECORD
LIBER NO. _____ PAGE NO. _____
FILE NO. #07 Millington
95 OCT 31 AM 10:40
Joseph Wampler
TUSCOLA COUNTY RECORDS

Register of Deeds Stamp & File Number

A	B	C	D	E	F	G	H	I	J	K	L	M
2	6	5	4	3	2	1						
3												
4	7	8	9	10	11	12						
5												
6	18	17	16	15	14	13						
7												
8	19	20	21	22	23	24						
9												
10	30	29	28	27	26	25						
11												
12	31	32	33	34	35	36						
13												

I, Kenneth D. Dunton, in a field survey on September 19, 19 93, do hereby certify that under requirements of P.A. 74, Michigan P.A. of 1970, the corner points mentioned in lines 1 and 2 above were in conformance with regulations and rules therefore as required in the current manual of survey instructions of the United States Department of the Interior, Bureau of Land Management or by a decree of a Court of Law and/or that the corner points mentioned in lines 3, 4 and 5 above were in conformance with the rules of the Michigan Board of Land Surveyors or by a Decree of a Court of Law; established, re-established, monumented, re-monumented, recovered, found as expressed below:

NOTE: Not more than 4 corners, all in the same town and range, may be recorded on this certificate.

A. Description of original monument and accessories and/or subsequent restoration:

1821 G.L.O. Notes
Joseph Wampler, D.S.
Set post cor. section
T10 & 11N - R8E
Spruce 8" N3°E 1.32'
Spruce 6" N78°E 3.96'
South 990' entered swamp
North 264' left swamp

Sept. 11, 1978 Survey Liber 491, Pages 989 & 990 by David T. Rowe, RLS 11192. Accessories same as shown on Act 74, Page 53, Vassar Twp.

Sept. 25, 1978 Act 74, Vassar Twp. 11-8 Page 53 by David T. Rowe, RLS #11192. Set 1/2" re-rod w/cap at proportionate distance between NE cor. Sec. 36, Vassar and SW cor. Sec. 6, Watertown Twp.

Note: A review of Rowe Eng. records does not indicate any field work to back up statement re: proportion between corners to establish SE corner Sec. 36, 11-8. N45°W 38.13 RLS tag 11192 in 12" ash. S30°W 59.10 RLS tag 11192 in 24" maple. West 26.71' RLS tag 11192 in 10" ash.

ec. A con't. on back of form.
B. Description of corner evidence found and/or method applied in restoring or reestablishing corner:

Found 1/2" rod per accessories Act 74 - Page 53, Vassar Township. Measured from 1/2" re-rod found, North to corner M-12, T11N-R8E, a distance of 2667.78'. Additional measurements along township line indicate Wampler's chain measured short, (65.2' per chain - approximate). Also measured North-South distance through swamp area and proportioned to Wampler. All measurements indicate GLO corner should be 60'+ Northerly of 1/2" re-rod found. Dug 5' x 8' trench 60' North and found remains of cedar post leaning Southeasterly. Hack marks indicate it had been cut (not a windfall tree). Straightened cedar post and set temporary corner - 1/2" x 24" re-rod in center of cedar post. See sketch of measurements on back of this form.

C. Description of monument for corner and accessories established to perpetuate locating the position of the corner:

Sept. 25, 1993 - removed temporary 1/2" rod and cedar post.
Set 4" x 36" concrete monument with 36" x 5/8" rod through center and 2" standard brass cap stamped corner M-13, T11N-R8E and corner M-1, T10N-R8E. Placed remains of cedar post around monument. Set 10-2-93.
S30°52'W 35.00' fnd 11192 tag & spike in NE face 12" ash.
S85°02'W 31.20' set T.C. Remon. tag & spike in South face 6" ash.
N56°47'W 36.74' set T.C. Remon. tag & spike in SW face 10" ash.
N50°28'W 59.35' set T.C. Remon. tag & spike in NE face 10" oak.
S04°26'E 60.67' fnd 1/2" rod per Act 74, Vassar Township, Page 53.
S34°23'W 5.07' fnd metal strap-placed 1/2" x 12" threaded rod at NE end.

Note: This corner is common with M-13, T11N-R8E. ✓

Signed by *[Signature]*

Date 10-23-96

Surveyor's Michigan License No. 23503

APPROVED

10-23-96



FORM APPROVED BY MICHIGAN STATE BOARD OF LAND SURVEYORS, JAN. 28, 1971
REVISED MAY 14, 1975
REVISED JAN., 1983

COPY

Feb. 16, 1979 Survey Liber 496, Pages 074 & 075 by David T. Rowe, R.L.S. #11192. No statement or object found or set. No accessories. Note: A witness card on file with Rowe Engineering, Caro, MI and dated Sept. 8, 1978 and updated Jan. 29, 1979 indicate the same accessories shown on Act 74, Page 53, Vassar Township.

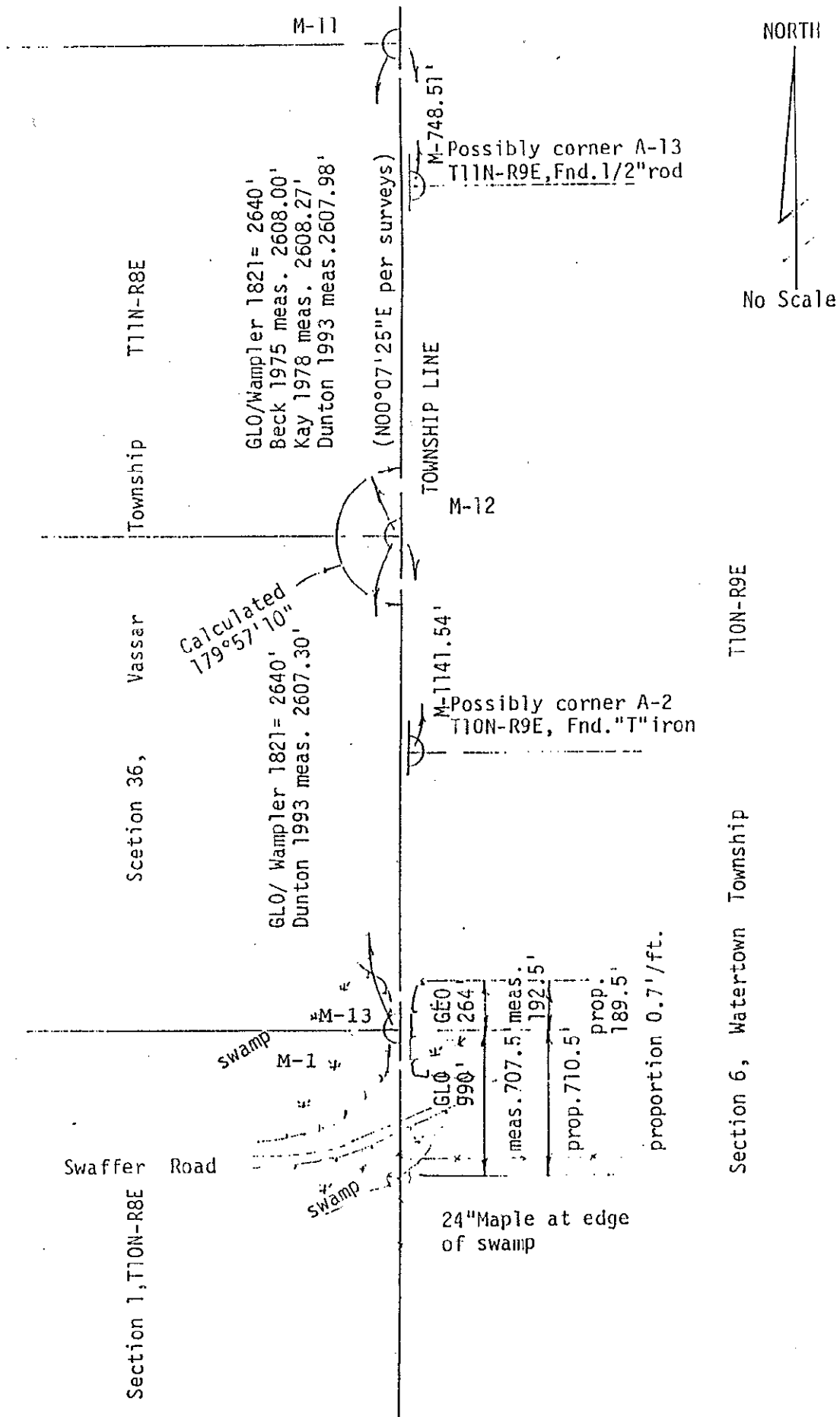

COPY