

1993

1993 REMONUMENTATION PROGRAM  
LAND CORNER RECORDATION CERTIFICATE

COMMISSION

Filing Requirement of Act 74, Mich. P.A. 1970

MILLINGTON TOWNSHIP

For corners in  
TUSCOLA

(County)

Located In:

Corner Code #

- 1. Public Land Survey T 10 N R 8 E M-10  
T R  
T R  
T R
- 2. Property Controlling S T R  
in Section S T R
- 3. Miscellaneous S T R  
Property in Sec. S T R

- 4. Lot No. \_\_\_\_\_, Recorded Plat \_\_\_\_\_
- 5. Private Claims \_\_\_\_\_

RECEIVED FOR RECORD  
 LIBER NO. \_\_\_\_\_ PAGE NO. 15  
 FILING NO. Millington  
 93 DEC 15 AM 10:32  
 VIRGINIA H. KALLAGER  
 TUSCOLA COUNTY  
 REGISTER OF DEEDS

Register of Deeds Stamp & File Number

I, JONATHAN M. FIELD, in a field survey on OCTOBER 19 93, do hereby certify that under requirements of P.A. 74, Michigan P.A. of 1970, the corner points mentioned in lines 1 and 2 above were in conformance with regulations and rules therefore as required in the current manual of survey instructions of the United States Department of the Interior, Bureau of Land Management or by a decree of a Court of Law and/or that the corner points mentioned in lines 3, 4 and 5 above were in conformance with the rules of the Michigan Board of Land Surveyors or by a Decree of a Court of Law; established, re-established, monumented, re-monumented, recovered, found as expressed below:

NOTE: Not more than 4 corners, all in the same town and range, may be recorded on this certificate.

	A	B	C	D	E	F	G	H	I	J	K	L	M
2	6	5	4	3	2	1							
3													
4	7	8	9	10	11	12							
5													
6	18	17	16	15	14	13							
7													
8	19	20	21	22	23	24							
9													
10	30	29	28	27	26	25							
11													
12	31	32	33	34	35	36							
13													

A. Description of original monument and accessories and/or subsequent restoration:  
 1821 GLO - WAMPLER, D.S. - SET 1/2 MILE POST; BEECH 18" N9E 11 LKS., BEECH 12" S17W 40LKS.

NO SUBSEQUENT RECORD

B. Description of corner evidence found and/or method applied in restoring or reestablishing corner:  
 1993 ROWE ENG. - FIELD, P.S.#37276; FND REMAINS OF CORNER FENCE POST AND REMNANTS OF OLD FENCE LINE RUNNING N-S-W FROM POST LOCATION

ACCEPTED OLD CORNER POST LOCATION AS BEST EVIDENCE OF ORIGINAL CORNER POSITION

COPY

SEE ALSO BACK OF THIS FORM

C. Description of monument for corner and accessories established to perpetuate locating the position of the corner:

- M-10 SET STANDARD MONUMENT (5/8" ROD W/ BRASS CAP IN CONC.)
- N47°E, 48.16' SET NAIL W/REMON TAG IN W. FACE 16" MAPLE
- S43°E, 7.39' SET NAIL W/REMON TAG IN S. FACE 20" OAK
- S06°W, 40.42' SET NAIL W/REMON TAG IN E. FACE 20" OAK
- S58°W, 26.49' SET NAIL W/REMON TAG IN SE FACE 14" MAPLE
- N26°W, 17.10' SET NAIL W/REMON TAG IN SW FACE 8" OAK

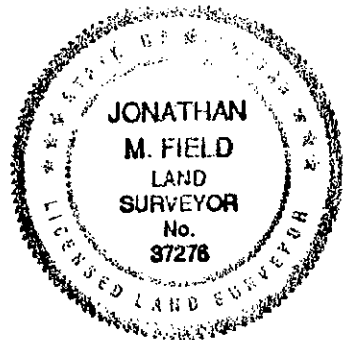

Signed by Jonathan M. Field Date 12-6-93  
 Surveyor's Michigan License No. 37276

APPROVED  
 12-6-93  
 J.M.F.

COPY



SECTION 25  
TION-R8E

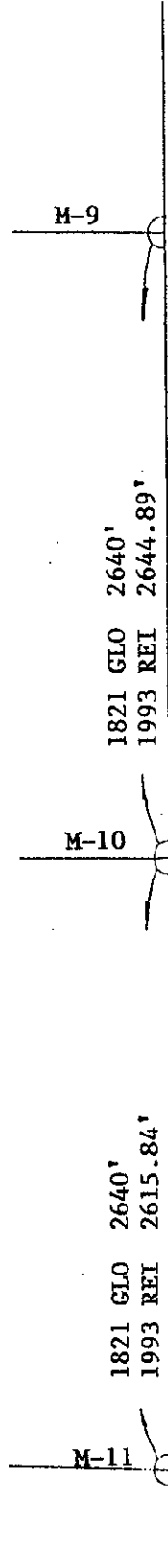

M-9

1821 GLO 2640'  
1993 REI 2644.89'

M-10

1821 GLO 2640'  
1993 REI 2615.84'

M-11