

1993

1993 REMONUMENTATION PROGRAM  
LAND CORNER RECORDATION CERTIFICATE

COMMISSION

Filing Requirement of Act 74, Mich. P.A. 1970

For corners in  
TUSCOLA  
(County)

Located In: MILLINGTON TOWNSHIP  
Corner Code #

RECEIVED & FILED  
LIBER NO. \_\_\_\_\_ PAGE NO. 8  
FILING NO. Millington  
93 DEC 15 AM 10:32  
VIRGINIA D. J. LAMEN  
TUSCOLA COUNTY  
REGISTER OF DEEDS

Register of Deeds Stamp & File Number

- 1. Public Land Survey T 10 NR 8 E M-11  
T \_\_\_\_\_ R \_\_\_\_\_  
T \_\_\_\_\_ R \_\_\_\_\_  
T \_\_\_\_\_ R \_\_\_\_\_
- 2. Property Controlling S \_\_\_\_\_ T \_\_\_\_\_ R \_\_\_\_\_  
in Section S \_\_\_\_\_ T \_\_\_\_\_ R \_\_\_\_\_
- 3. Miscellaneous S \_\_\_\_\_ T \_\_\_\_\_ R \_\_\_\_\_  
Property in Sec. S \_\_\_\_\_ T \_\_\_\_\_ R \_\_\_\_\_

- 4. Lot No. \_\_\_\_\_, Recorded Plat \_\_\_\_\_
- 5. Private Claims \_\_\_\_\_

	A	B	C	D	E	F	G	H	I	J	K	L	M
1													
2	6	5	4	3	2	1							
3													
4	7	8	9	10	11	12							
5													
6	18	17	16	15	14	13							
7													
8	19	20	21	22	23	24							
9													
10	30	29	28	27	26	25							
11													
12	31	32	33	34	35	36							
13													

I, JONATHAN M. FIELD, in a field survey on OCTOBER 19 93, do hereby certify that under requirements of P.A. 74, Michigan P.A. of 1970, the corner points mentioned in lines 1 and 2 above were in conformance with regulations and rules therefore as required in the current manual of survey instructions of the United States Department of the Interior, Bureau of Land Management or by a decree of a Court of Law and/or that the corner points mentioned in lines 3, 4 and 5 above were in conformance with the rules of the Michigan Board of Land Surveyors or by a Decree of a Court of Law; established, re-established, monumented, re-monumented, recovered, found as expressed below:

NOTE: Not more than 4 corners, all in the same town and range, may be recorded on this certificate.

A. Description of original monument and accessories and/or subsequent restoration:  
1821 GLO - WAMPLER, D.S. - SET POST; BEECH 6" S18E 18 LKS., BEECH 26" N55W 34LKS.  
1900 FELTON, C.S. - SET FROM B.T.'S IN 1879; OAK POST STONE AND CROCKERY; PINE 34" S26E 31 FT, PINE 30" N11W 13.8 FT

NO SUBSEQUENT RECORD

B. Description of corner evidence found and/or method applied in restoring or reestablishing corner:  
1993 ROWE ENG. - FIELD, P.S.#37276; FND FRAGMENTS OF OAK POST AT INTERSECTION OF OLD FENCE LINE RUNNING N-S AND CENTERLINE OF 2-TRACK TRAIL RUNNING W-NE'LY; DID NOT FIND STONE OR CROCKERY (TRAIL GRADE IS 1'-2' BELOW SURROUNDING GRADE)

ACCEPTED FRAGMENTS OF OAK POST AS BEST EVIDENCE OF ORIGINAL CORNER POSITION

**COPY**

SEE ALSO BACK OF THIS FORM

C. Description of monument for corner and accessories established to perpetuate locating the position of the corner:  
M-11 SET STANDARD MONUMENT (5/8" ROD W/ BRASS CAP IN CONC.)

- N04°E, 12.12' SET NAIL W/REMON TAG IN E. FACE 6" POPLAR
- S27°E, 42.96' SET NAIL W/REMON TAG IN W. FACE 6" APPLE
- S72°W, 37.03' SET NAIL W/REMON TAG IN SE FACE TWIN 6" POPLAR
- N47°W, 30.10' SET NAIL W/REMON TAG IN SW FACE 6" POPLAR
- N12°W, 25.80' SET NAIL W/REMON TAG IN W. FACE 8" POPLAR

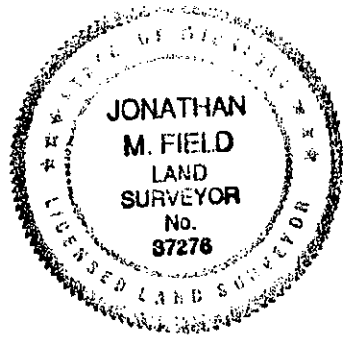

Signed by Jonathan M. Field  
Surveyor's Michigan License No. 37276

Date 12-6-93

APPROVED  
12-6-93  
*J.M.F.*  
*Q.M.T.*

COPY



SECTION 25  
TION-R8E

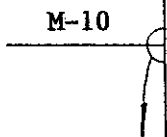

1821 GLO 2640'  
1993 REI 2615.84'

M-11

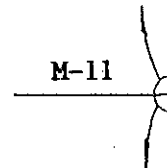

1821 GLO 2640'  
1900 FELTON 2600'  
1993 REI 2591.78'

SECTION 36  
TION-R8E

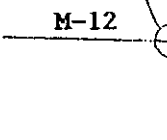

M-12