

REMONUMENTATION

MAY 28 1997

1996 REMONUMENTATION PROGRAM

LAND CORNER RECORDATION CERTIFICATE
Filing Requirement of Act 74, Mich. P.A. 1970

COMMISSION

For corners in Vassar Township

TUSCOLA
(County)

Located In:

Corner Code #

1. Public Land Survey

T11N R8E
T R
T R
T11N R7E

A-1
amended

2. Property Controlling
in Section

S T R
S T R

M-1
amended

3. Miscellaneous
Property in Sec.

S T R
S T R

RECEIVED FOR RECORD
LIBER NO. Vassar PAGE NO. 102
FILE NO. Vassar
95 OCT 31 AM 10:40
TUSCOLA COUNTY
REGISTER OF DEEDS

Register of Deeds Stamp & File Number

4. Lot No. _____, Recorded Plat _____

5. Private Claims _____

I, Kenneth D. Dunton, in a field survey on Aug. 12, 1995 do hereby state that under requirements of P.A. 74, Michigan P.A. of 1970, the corner points mentioned in lines 1 and 2 above were in conformance with regulations and rules therefore as required in the current manual of survey instructions of the United States Department of the Interior, Bureau of Land Management or by a decree of a Court of Law and/or that the corner points mentioned in lines 3, 4 and 5 above were in conformance with the rules of the Michigan Board of Land Surveyors or by a Decree of a Court of Law; established, re-established, monumented, recovered, found as expressed below:

NOTE: Not more than 2 corners, all in the same town and range, may be recorded on this certificate.

	A	B	C	D	E	F	G	H	I	J	K	L	M		
1															
2	6			5			4			3			2	1	
3															
4	7				8			9			10			11	12
5															
6	18				17			16			15			14	13
7															
8	19				20			21			22			23	24
9															
10	30				29			28			27			26	25
11															
12	31				32			33			34			35	36
13															

A. Description of original monument and accessories and/or subsequent restoration:

1821 G.L.O. Notes
Joseph Wampler, D.S.
Intersected township line
15.00 West.
Beech 10 S75W 9
Sugar 9 N26E 47
Corner M-1, T11N-R7E

Nov., 1973 Act 74 form filed by John W. Martin,
L.S. #4699 on Page 22, Vassar Township. 1 1/2"
iron pipe.
N.W. 100.00' to S.E. cor. stone found., hse.
S.W. 59.10' to fee. t. pole.

Section A continued on back of this form.

B. Description of corner evidence found and/or method applied in restoring or reestablishing corner:

Found and accepted 5/8" re-rod in monument box as the proper location of corner A-1 amended.

C. Description of monument for corner and accessories established to perpetuate locating the position of the corner:

Placed standard brass cap stamped corner M-1 amended, T11N-R7E over 5/8" re-rod found in mon. box. Encased cap & rod in concrete in mon. box. Set 10-3-95.
S27°10'W 59.20 fnd. #11192 tag & nail in N.W. face t. pole, set T.C. Remon. tag & spike above.
N44°07'W 99.70' SE corner footings house #6108. (stones covered)
N14°46'W 77.85' set T.C. Remon. tag & spike in East root 30" tree.
S36°56'E 105.25' fnd. P.K. nail in W. face p. pole, set T.C. Remon. tag & spike above.
East 1115.43' fnd. iron stake in mon. box at apparent cor. M-13, T12N-R7E

Note: This corner is common with M-1 amended, T11N-R7E.

Signed by [Signature]
Surveyor's Michigan License No. 23503

Date 10-23-96

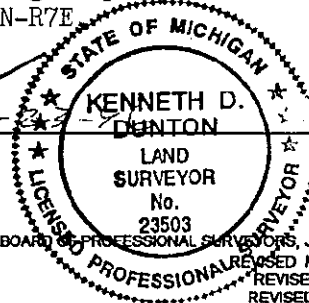

APPROVED
10-23-96

FORM APPROVED BY MICHIGAN STATE BOARD OF PROFESSIONAL SURVEYORS, JAN. 28, 1971
REVISED MAY 14, 1975
REVISED JAN., 1983
REVISED OCT., 1995

COPY

Section A continued from front of form:

April 3, 1985 Survey by Earl E. Gravlin, L.S. #23510, recorded in Liber 553 on Page 062, Tuscola County records. Fnd. 1/2" iron and cap. S30°W 59.15' t.p., N20°W 77.85' 30" maple, N15°E 21.20' E. end 12" C.M.P.

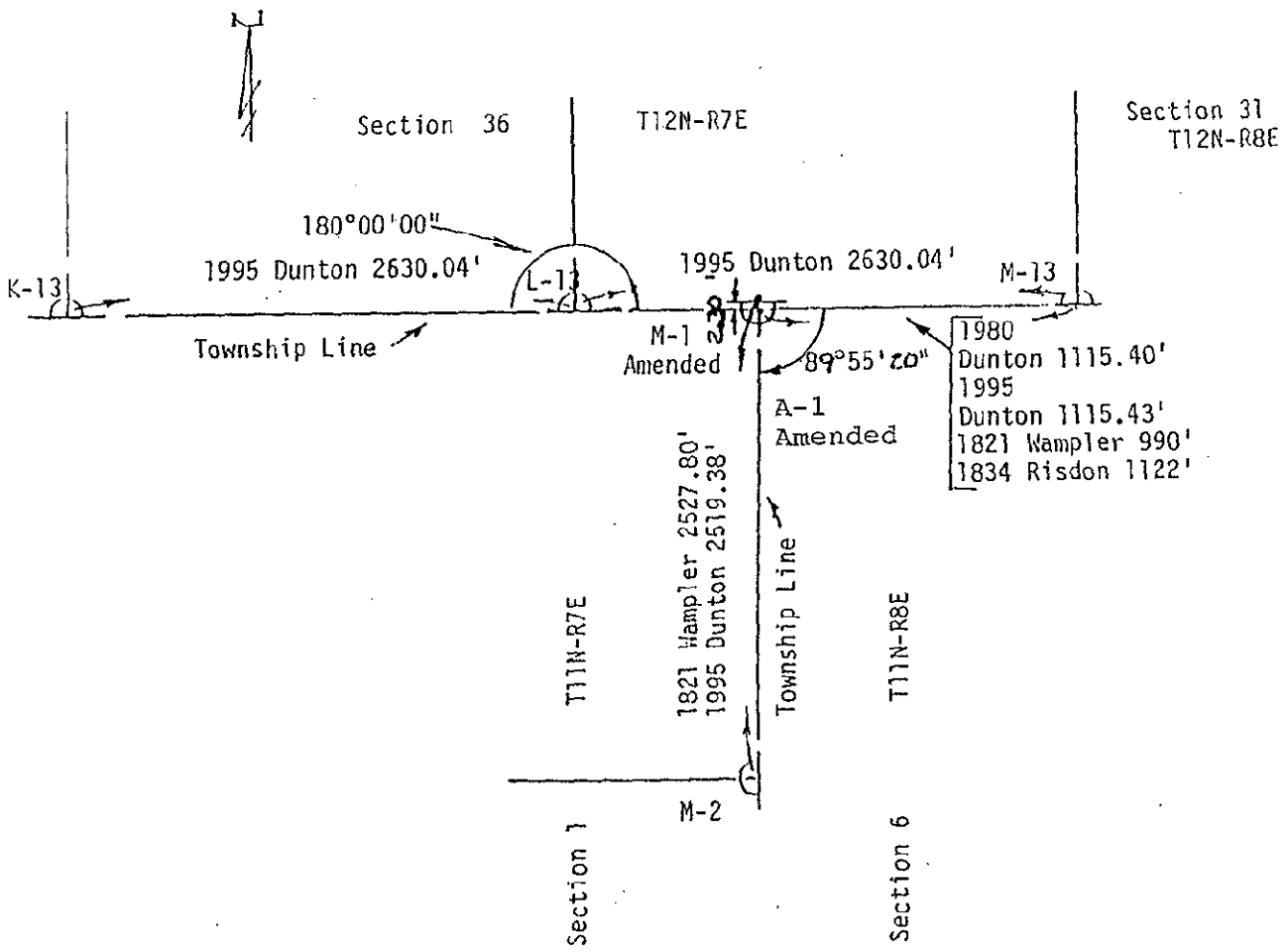

COPY