

**SURVEY & REMONUMENTATION**

MAY 05 1997

1996 REMONUMENTATION PROGRAM

**LAND CORNER RECORDATION CERTIFICATE**  
Filing Requirement of Act 74, Mich. P.A. 1970

For corners in **COMMISSION** Vassar Township

RECEIVED FOR RECORD  
LIBER NO. \_\_\_\_\_ PAGE NO. 101  
FILE NO. Vassar  
95 OCT 31 AM 10:40  
*John J. Beck*  
TUSCOLA COUNTY  
REGISTER OF DEEDS

TUSCOLA (County) Located In: Corner Code: #

1. Public Land Survey	T <u>11N</u> R <u>8E</u>	<u>M-1</u> ✓
	T _____ R _____	_____
	T _____ R _____	_____
	T <u>12N</u> R <u>8E</u>	<u>M-13</u>
2. Property Controlling in Section	S _____ T _____ R _____	_____
	S _____ T _____ R _____	_____
3. Miscellaneous Property in Sec.	S _____ T _____ R _____	_____

Register of Deeds Stamp & File Number

4. Lot No. \_\_\_\_\_, Recorded Plat \_\_\_\_\_  
5. Private Claims \_\_\_\_\_

A	B	C	D	E	F	G	H	I	J	K	L	M
2	6	5	4	3	2	1						
3												
4	7	8	9	10	11	12						
5												
6	18	17	16	15	14	13						
7												
8	19	20	21	22	23	24						
9												
10	30	29	28	27	26	25						
11												
12	31	32	33	34	35	36						
13												

I, Kenneth D. Dunton, in a field survey on June 12, 19 93, do hereby certify that under requirements of P.A. 74, Michigan P.A. of 1970, the corner points mentioned in lines 1 and 2 above were in conformance with regulations and rules therefore as required in the current manual of survey instructions of the United States Department of the Interior, Bureau of Land Management or by a decree of a Court of Law and/or that the corner points mentioned in lines 3, 4 and 5 above were in conformance with the rules of the Michigan Board of Land Surveyors or by a Decree of a Court of Law; established, re-established, monumented, re-monumented, recovered, found as expressed below:

**NOTE: Not more than 4 corners, all in the same town and range, may be recorded on this certificate.**

A. Description of original monument and accessories and/or subsequent restoration:

1821 G.L.O. Notes Joseph Wampler, D.S. Set post cor. Town 11 & 12 Hemlock 7" S7°E 10.56' Hemlock 32" N73°W 9.90'	Feb. 13, 1892 G. B. Felton, County Surveyor. Survey of Section 30, T12N-R9E, under remarks states: SE cor. Sec. 36, T12N-R8E, maple 20" N14 1/2°E 90.42'. Aug. 26, 1895 Edward Teskey, County Surveyor. Gas pipe at corner. No accessories given. March 15, 1976 Survey Liber 461, Page 175 by James A Beck, R.L.S. #21559. No statement of object found or set. No accessories given.
--	--

Note: Section A continued on back of form.

B. Description of corner evidence found and/or method applied in restoring or reestablishing corner:  
Found & accepted 5/8" iron rod 30" long.

C. Description of monument for corner and accessories established to perpetuate locating the position of the corner:  
Set standard monument with 2" brass cap stamped corner M-13, T12N-R8E & M-1, T11N-R8E. Set 10-9-93. S89°24'E 33.00' set 1/2" x 18" rod & cap #23503. S00°49'40"E 373.41' found 1/2" rod at apparent cor. A-3, T11N-R9E. S45°12'W 46.74' found 1/2" rod & cap #24588. S52°25'W 66.90' set T. C. Remon. tag & spike in NW face power pole.

Note: This corner is common with M-13, T12N-R8E. ✓

Signed by *Kenneth D. Dunton* Date 10-9-93  
Surveyor's Michigan License No. 23503

APPROVED  
10-23-96  
*J.P.C.*  
*D.M.T.*  
*J.R.B.*

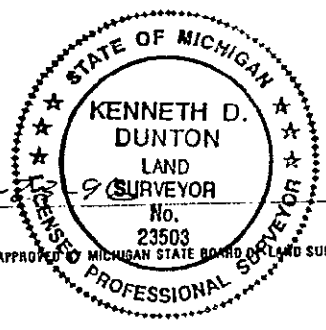

FORM APPROVED BY MICHIGAN STATE BOARD OF LAND SURVEYORS, JAN. 28, 1971  
REVISED MAY 14, 1975  
REVISED JAN., 1983

COPY

Con't. from Section A on front of this form:

July 8, 1977 Act 74, Vassar Twp. 11-8, Page 41 corner M-1 by Kenneth D. Dunton, R.L.S. #23503. Found 5/8" iron rod. Also found by Rowe Engineering on 4-5-74.

S35°E 51.56' R.L.S. 11192 tag in p.p.

South 42.2' centerline o. h. power line E & W.

N85°E 21.30' road sign post.

South 373.50' to SW cor., Sec. 6, T11N-R9E.

October 20, 1981 Survey Liber 520, Page 986 by Kenneth D. Dunton, R.L.S. #23503.

Found 5/8" rod.

S50°W 35.0' stop sign post.

S35°E 51.6' tag in p.p.

South 42.0' centerline o.h. power line.

October 20, 1981 Act 74, Juniata Township, 12-8 page 43 by Kenneth D. Dunton, R.L.S. #23503

Found 5/8" rod. Accessories same as on Survey Liber 520, Page 986 shown above.

December 22, 1983 Act 74, Vassar Township, 11-8 page 67 by Lionel Emery, R.L.S. #24593.

Shows corner M-1 (no mention of object found) and statement that M-1 was used for direction control of portion of range line. Reference to range line between M-1 & M-3 of T11N-R8E.

January 16, 1984 Survey Liber 538, Page 487 by Lionel Emery, R.L.S. #24593. Northeast corner of Section 1, T11N-R8E. Found iron rod. Accessories same as on Act 74, Page 41, Vassar Township, shown above.

January 24, 1984 Survey Liber 538, Page 949, by Lionel Emery, R.L.S. #24593. Northeast corner Section 1, T11N-R8E. Found iron rod.

Accessories same as on Survey Liber 538, Page 487, shown above.

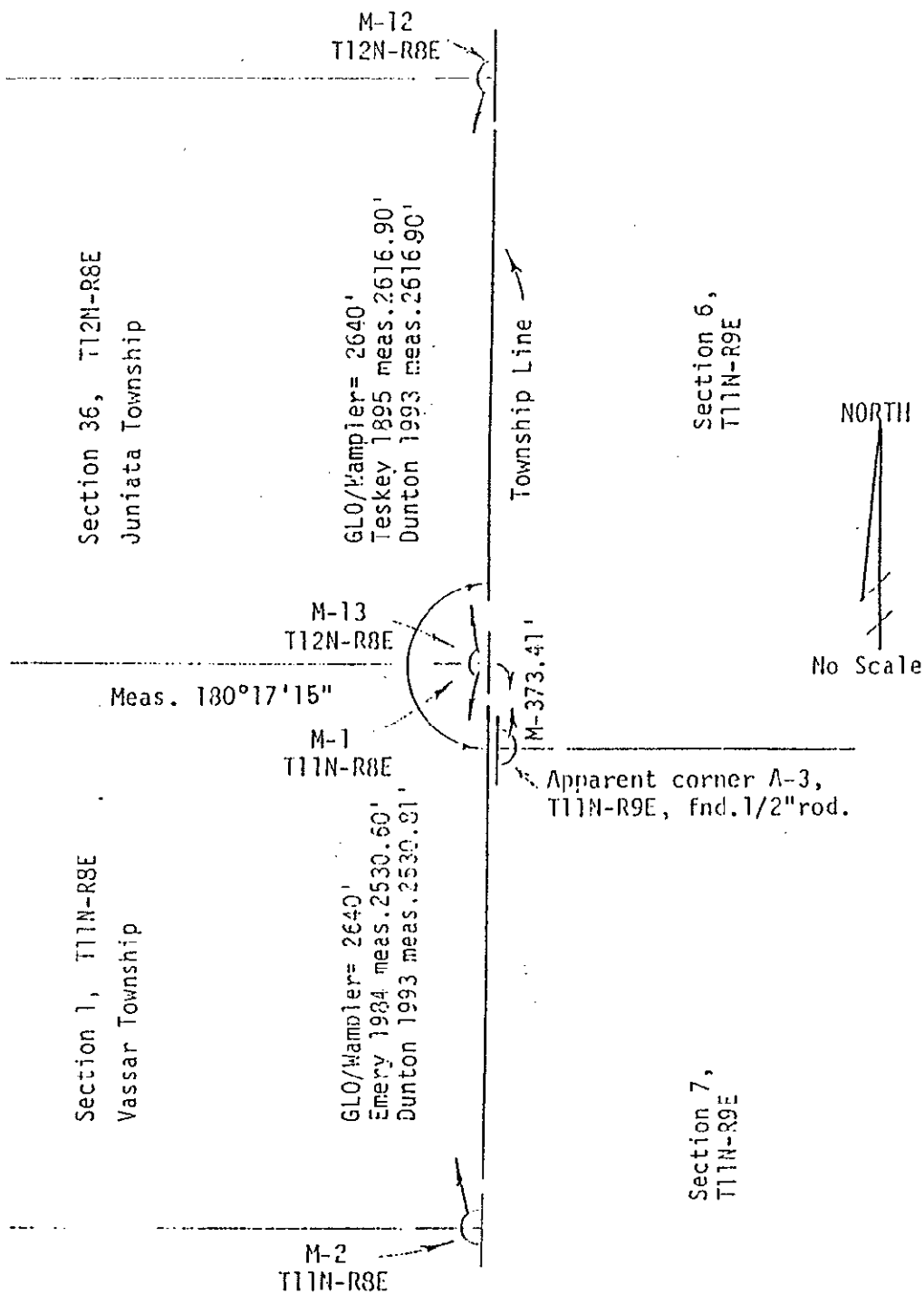

COPY