

**SURVEY & REMONUMENTATION**

DEC 02 1993

1993 REMONUMENTATION PROGRAM  
**LAND CORNER RECORDATION CERTIFICATE**  
 Filing Requirement of Act 74, Mich. P.A. 1970  
 VASSAR TOWNSHIP

RECEIVED FOR RECORD  
 VASSAR TOWNSHIP  
 LIBER NO. \_\_\_\_\_ PAGE NO. \_\_\_\_\_  
 FILING NO. #85  
 93 OCT 22 PM 2:43  
 VIRGINIA M. WILSON  
 TUSCOLA COUNTY  
 REGISTER OF DEEDS

For corners in MISSION

TUSCOLA  
 (County)

Located In: Corner Code #

- |                                       |                            |       |
|---------------------------------------|----------------------------|-------|
| 1. Public Land Survey                 | T <u>11</u> N R <u>8</u> E | M-6   |
|                                       | T _____ R _____            | _____ |
|                                       | T _____ R _____            | _____ |
|                                       | T _____ R _____            | _____ |
| 2. Property Controlling in Section    | S _____ T _____ R _____    | _____ |
|                                       | S _____ T _____ R _____    | _____ |
| 3. Miscellaneous Property in Sec.     | S _____ T _____ R _____    | _____ |
|                                       | S _____ T _____ R _____    | _____ |
| 4. Lot No. _____, Recorded Plat _____ |                            |       |
| 5. Private Claims _____               |                            |       |

Register of Deeds Stamp & File Number

I, Kenneth D. Dunton, in a field survey on July 31, 19 93, do hereby certify that under requirements of P.A. 74, Michigan P.A. of 1970, the corner points mentioned in lines 1 and 2 above were in conformance with regulations and rules therefore as required in the current manual of survey instructions of the United States Department of the Interior, Bureau of Land Management or by a decree of a Court of Law and/or that the corner points mentioned in lines 3, 4 and 5 above were in conformance with the rules of the Michigan Board of Land Surveyors or by a Decree of a Court of Law; established, re-established, monumented, re-monumented, recovered, found as expressed below:

	A	B	C	D	E	F	G	H	I	J	K	L	M
2	6	5	4	3	2	1							
3													
4	7	8	9	10	11	12							
5													
6	18	17	16	15	14	13							
7													
8	19	20	21	22	23	24							
9													
10	30	29	28	27	26	25							
11													
12	31	32	33	34	35	36							
13													

**NOTE: Not more than 4 corners, all in the same town and range, may be recorded on this certificate.**

A. Description of original monument and accessories and/or subsequent restoration:

1821 G.L.O. Notes	January 15, 1898
Joseph Wampler, D.S.	G. B. Felton, County Surveyor
Set 1/2 m. post	Set from measure
Hemlock 26" N10°W 13.20'	Gas pipe & crockery at corner
Hemlock 18" N45°E 2.64'	No accessories given. No measurements shown.

B. Description of corner evidence found and/or method applied in restoring or reestablishing corner: & accepted

Found 3/8" iron rod & white crockery at South side of rod. Dug 8' x 4' trench and found nothing at split of measured mile. Did not find gas pipe by Felton.

C. Description of monument for corner and accessories established to perpetuate locating the position of the corner:

Set 4" x 36" concrete monument with 36" x 5/8" rod through center and 2" standard brass cap stamped corner M-6, T11N-R8E.  
 S00°00'30"W 532.12' found 1/2" rod & cap #23510  
 S62°39'W 35.31' found double headed nail in East face triple 12" maple.  
 S84°49'W 29.86' found double headed nail in South face corner post.  
 N54°00'W 39.76' set T.C. Re-mon. tag & spike in NE face 28" elm.  
 S75°40'E 30.81' found double headed nail in North face of twin 10" pin cherry. Nail in westerly tree.

**COPY**

Signed by [Signature] Date September 27, 1993  
 Surveyor's Michigan License No. 23503

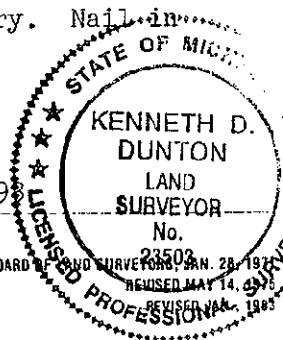

**APPROVED**

9-27-93

[Signature]

NORTH

No Scale

COPY

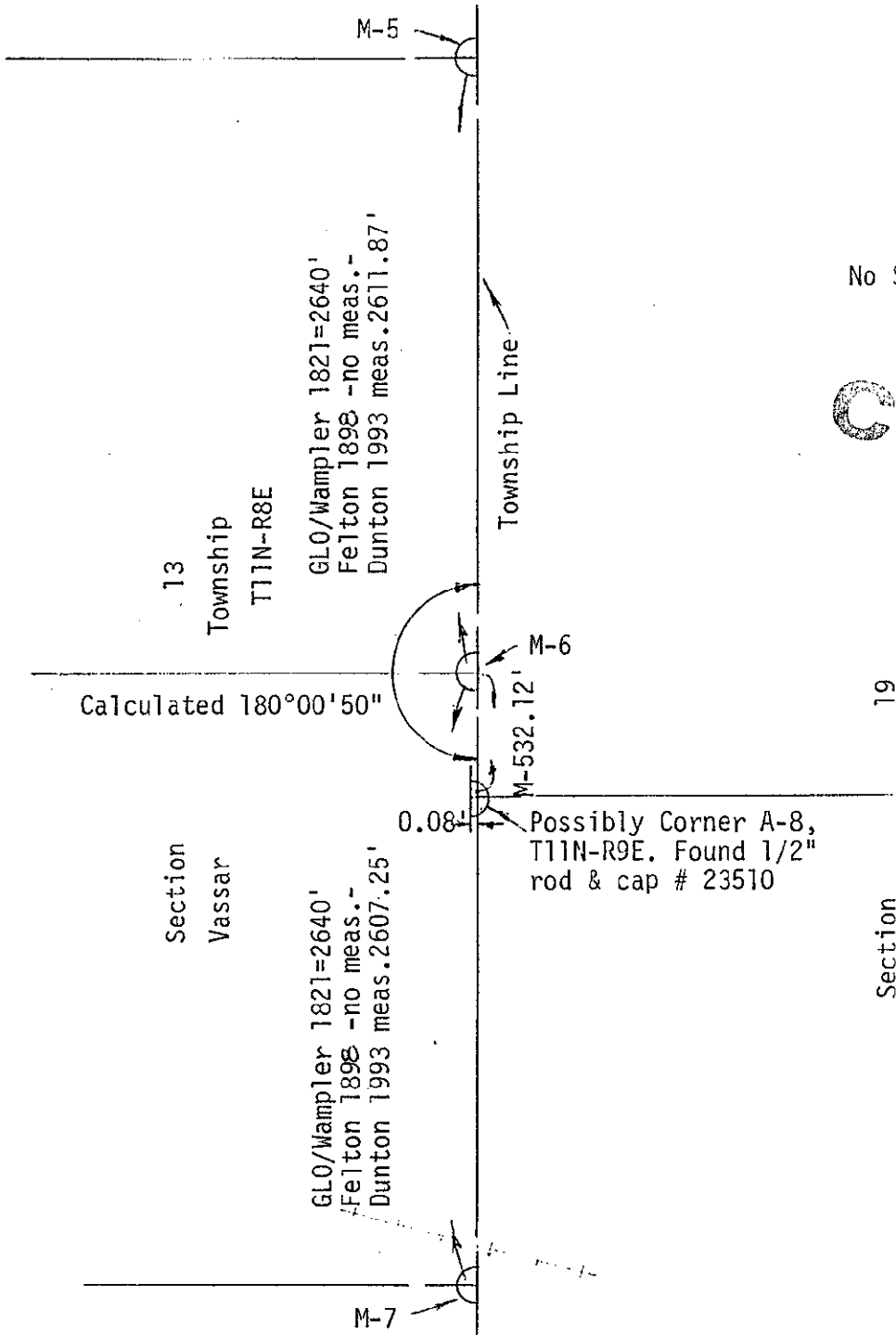

M-5

GLO/Wampler 1821=2640'  
Felton 1898 -no meas.  
Dunton 1993 meas. 2611.87'

Township Line

13

Township

T11N-R8E

Calculated 180°00'50"

M-6

M-532.12'

19

0.081'

Possibly Corner A-8,  
T11N-R9E. Found 1/2"  
rod & cap # 23510

T11N-R9E

Section

Vassar

GLO/Wampler 1821=2640'  
Felton 1898 -no meas.  
Dunton 1993 meas. 2607.25'

Section

M-7