

1996 REMONUMENTATION PROGRAM

LAND CORNER RECORDATION CERTIFICATE  
Filing Requirement of Act 74, Mich. P.A. 1970

For corners in Fremont Twp.

<u>Tuscola</u> (County)	Located In:	Corner Code #
1. Public Land Survey	T11N R 9E	M-11 ✓
	T R	A-11
	T11N R10E	
	T R	
2. Property Controlling in Section	S T R	
	S T R	
3. Miscellaneous Property in Sec.	S T R	
	S T R	

RECEIVED FOR RECORD  
LIBER NO. \_\_\_\_\_ PAGE NO. 90  
FILE NO. Fremont  
95 DEC 10 PM 4:48  
TUSCOLA COUNTY REGISTER OF DEEDS  
Register of Deeds Stamp & File Number

4. Lot No. \_\_\_\_\_, Recorded Plat \_\_\_\_\_  
5. Private Claims \_\_\_\_\_

I, Kenneth D. Dunton in a field survey on Apr. 20, 1996 do hereby state that under requirements of P.A. 74, Michigan P.A. of 1970, the corner points mentioned in lines 1 and 2 above were in conformance with regulations and rules therefore as required in the current manual of survey instructions of the United States Department of the Interior, Bureau of Land Management or by a decree of a Court of Law and/or that the corner points mentioned in lines 3, 4 and 5 above were in conformance with the rules of the Michigan Board of Land Surveyors or by a Decree of a Court of Law, established, re-established, monumented, recovered, found as expressed below:

NOTE: Not more than 2 corners, all in the same town and range, may be recorded on this certificate.

A	B	C	D	E	F	G	H	I	J	K	L	M
1												
2	6		5		4		3		2		1	
3												
4	7		8		9		10		11		12	
5												
6	18		17		16		15		14		13	
7												
8	19		20		21		22		23		24	
9												
10	30		29		28		27		26		25	
11												
12	31		32		33		34		35		36	
13												

A. Description of original monument and accessories and/or subsequent restoration:

G.L.O. Notes 1834	April 10, 1891.	August 19, 1893
Harvey Parke, D.S.	G. B. Felton, County Surveyor	G. B. Felton, Co. Surveyor
Set post corner	Survey of Sec. 30, T11N-R10E	Survey of Sec. 25, T11N-R9E
Sections 25 & 36	Set from measurements	No mention of evidence found
Beech 28 N51W 21	Sugar 8 S29 1/2W 67 1/2	or set or accessories.
Beech 10 S50W 31	Sugar 8 N47E 82	

Note: Section A continued on back of form.

B. Description of corner evidence found and/or method applied in restoring or reestablishing corner:

Found 5/8" rod in mon. box. Held rod as best evidence of the original corner.

C. Description of monument for corner and accessories established to perpetuate locating the position of the corner:

Placed standard brass cap over 5/8" rod and encased cap & rod in concrete in mon. box stamped cap M-11, T11N-R9E.  
S18°E 25.86' set 1/2" rod in road shoulder.  
S06°W 55.62' set remon. tag in E. face wood sign post.  
N33°W 45.19' set remon. tag in SW face 14" ash.  
N11°W 40.00' fnd. #11192 tag in E. face 25" ash.  
N60°E 51.06' fnd. #11192 tag atop wood guard rail post.  
S45°E 31.59' fnd. #11192 tag atop wood guard rail post.

Note: This corner is common with A-11, T11N-R10E.

Signed by [Signature]  
Surveyor's Michigan License No. 23503

Date 11-6-96

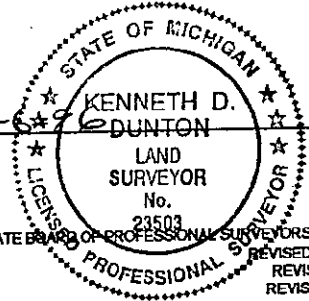

APPROVED  
11-6-96  
[Signatures]

FORM APPROVED BY MICHIGAN STATE BOARD OF PROFESSIONAL SURVEYORS, JAN. 28, 1971  
REVISED MAY 14, 1975  
REVISED JAN., 1983  
REVISED OCT., 1985

REMONUMENT  
MAY 20 1997

2007/11

April 20, 1897  
G. B. Felton, County Surveyor  
Survey of Section 31, T11N-R10E  
Previously set.  
Sugar 8 S29 1/2W 67 1/2 Post & crockery corner.

August 19, 1971  
Survey by David T. Rowe, RLS #11192, L-2, P-356  
Set "T" iron.  
N50°W 55.59' nail & cap in 36" maple.  
S30°W 38.57' road sign post.  
N45°E 51.64' nail & cap in 24" maple.  
S50°E 86.01' nail & cap in P.P.

March 13, 1973  
Survey by David T. Rowe, RLS #11192, L-2, P-352  
Fnd. P.K. nail  
North 0.6' ± to centerline of M-24.  
South 36.34' RLS #11192 tag in corner post.  
N05°W 39.80' RLS #11192 tag in 14" hickory.

March, 1973 L.C.R.C. form filed by D. T. Rowe, RLS #11192 on Page 12, Cor. A-11, T11N-R10E. Accessories same as Survey L-2, P-352.

July 6, 1974  
Survey by Robert G. Kay, RLS #14096, L-444, P-193  
North 0.65' to centerline M-24.  
South 36.34' tag cor. post.  
N05°W 39.80' tag 14" hickory.  
Fnd. P.K. nail.

May 28, 1975  
Survey by James A. Beck, RLS #21559, L-452, P-640 thru 642  
P. K. Nail  
South 36.64' RLS #11192 tag in cor. post.  
N05°W, 39.80' RLS #11192 tag in 14" hickory.  
N40°W, 33.62' South edge of S. leg village limit sign.

Dec. 2, 1976  
Survey by David T. Rowe, RLS #11192, L-469, P-960  
Iron in monument box.  
South 36.64' RLS #11192 tag in cor. post.  
N05°W 39.80' RLS #11192 tag in 14" hickory.  
N83°35'53"E 5.65' to P.K.  
N40°W 33.62' S. edge of S. leg of village limit sign.

July 25, 1977  
Survey by Robert G. Kay, RLS #14096, L-476, P-946 & 947  
Fnd. mon. box.  
South 36.64' RLS #11192 tag cor. post.  
N05°W 40.55' RLS #11192 tag 14" hickory.  
N40°W 27.65' S. edge of S. leg village limit sign.

Aug. 11, 1977  
Survey by Earl E. Gravlin, RLS #23510, L-478, P-484 thru 486  
No mention of evidence found or set, no accessories.

Oct. 5, 1978  
Survey by Earl E. Gravlin, RLS #23510, L-496, P-1482 & 1483  
No mention of object found.  
North 0.65' to centerline of M-24.  
South 36.34' tag cor. post.  
N05°W 39.80' tag 14" hickory.

Dec. 4, 1978  
Survey by Bernard R. Feldhauser, Land Surveyor #10685, L-492, P-1099 thru 1106  
No mention of evidence found or set or accessories.

Aug. 30, 1989  
Survey by ~~Stephan~~ J. Szyskoski LLS #33986, L-597, P-936 & 937  
Fnd. 1/2" smooth rod in mon. box.  
N83°E 6.78' P.K. nail in centerline.  
South 36.64' RLS #11192 tag in cor. post.  
N05°W 40.55' RLS #11192 tag in 14" hickory.

Aug. 30, 1989  
L.C.R.C. form filed by Stephan J. Szyskoski L.S. 33986  
Fnd. rod in mon. box.  
N05°W 40.57' fnd. flag/tag E. face 15" hickory.  
South 32.50' fnd. REI rod.  
S45°E 31.55' set nail/tag #11192 top guard rail post.  
N45°E 52.04' set nail/tag #11192 top guard rail post.

M-11

Sheet 2 of 3

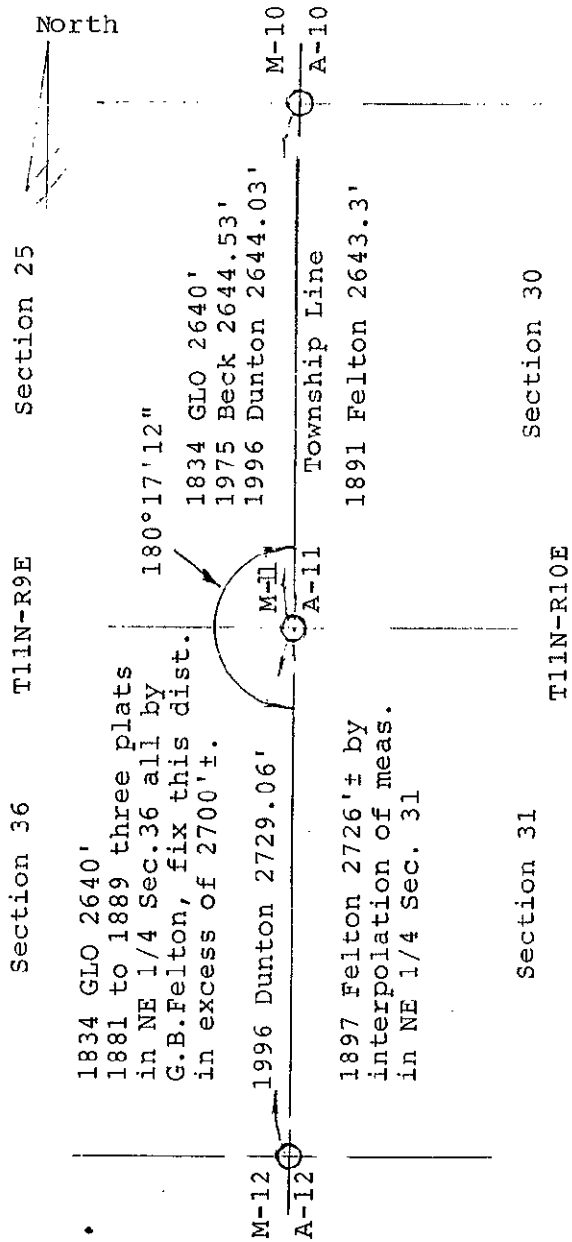

APPROVED

11-6-96

*K.D.*  
*Feb*  
*J.M.T.*

Sheet 3 of 3

M-11