

1996 REMONUMENTATION PROGRAM
 LAND CORNER RECORDATION CERTIFICATE
 Filing Requirement of Act 74, Mich. P.A. 1970

For corners in Dayton Twp.

Tuscola Located In: Corner Code #
 (County)

1. Public Land Survey T11N R10E A-11
 T R
 T11N R9E M-11
 T R

2. Property Controlling S T R
 in Section S T R

3. Miscellaneous S T R
 Property in Sec. S T R

RECEIVED FOR RECORD
 LIBER NO. PAGE NO. 69
 FILE NO. Dayton
 96 DEC 10 PM 4:49
 TUSCOLA COUNTY
 REGISTER OF DEEDS
 Register of Deeds Stamp & File Number

4. Lot No. _____, Recorded Plat _____
 5. Private Claims _____

I, Kenneth D. Dunton in a field survey on Apr. 20, 1996 do hereby state that under requirements of P.A. 74, Michigan P.A. of 1970, the corner points mentioned in lines 1 and 2 above were in conformance with regulations and rules therefore as required in the current manual of survey instructions of the United States Department of the Interior, Bureau of Land Management or by a decree of a Court of Law and /or that the corner points mentioned in lines 3, 4 and 5 above were in conformance with the rules of the Michigan Board of Land Surveyors or by a Decree of a Court of Law; established, re-established, monumented, recovered, found as expressed below:

NOTE: Not more than 2 corners, all in the same town and range, may be recorded on this certificate.

	A	B	C	D	E	F	G	H	I	J	K	L	M
1													
2	6	5	4	3	2	1							
3													
4	7	8	9	10	11	12							
5													
6	18	17	16	15	14	13							
7													
8	19	20	21	22	23	24							
9													
10	30	29	28	27	26	25							
11													
12	31	32	33	34	35	36							
13													

A. Description of original monument and accessories and/or subsequent restoration:

G.L.O. Notes 1834 Harvey Parke, D.S. Set post corner Sections 25 & 36 Beech 28 N51W 21 Beech 10 S50W 31 Corner M-11, T11N-R9E	April 10, 1891 G. B. Felton, County Surveyor Survey of Sec. 30, T11N-R10E Set from measurements Sugar 8 S29 1/2W 67 1/2 Sugar 8 N47E 82	August 19, 1893 G. B. Felton, Co. Surveyor Survey of Sec. 25, T11N-R9E No mention of evidence found or set or accessories.
---	--	--

Note: Section A continued on back of form.
 B. Description of corner evidence found and/or method applied in restoring or reestablishing corner:

Found 5/8" rod in mon. box. Held rod as best evidence of the original corner.

C. Description of monument for corner and accessories established to perpetuate locating the position of the corner:

Placed standard brass cap over 5/8" rod and encased cap & rod in concrete in mon. box stamped cap M-11, T11N-R9E.
 S18°E 25.86' set 1/2" rod in road shoulder.
 S06°W 55.62' set remon. tag in E. face wood sign post.
 N33°W 45.19' set remon. tag in SW face 14" ash.
 N11°W 40.00' fnd. #11192 tag in E. face 25" ash.
 N60°E 51.06' fnd. #11192 tag atop wood guard rail post.
 S45°E 31.59' fnd. #11192 tag atop wood guard rail post.

Note: This corner is common with M-11, T11N-R9E.

Signed by [Signature] Date 11-6-96
 Surveyor's Michigan License No. 23503

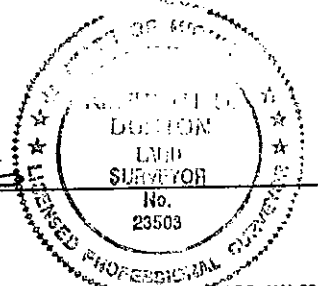

APPROVED
11-6-96
[Signature]

MAY 20 1997

2/11

April 20, 1897
G. B. Felton, County Surveyor
Survey of Section 31, T11N-R10E
Previously set.
Sugar 8 S29 1/2W 67 1/2 Post & crockery corner.

August 19, 1971
Survey by David T. Rowe, RLS #11192, L-2, P-356
Set "T" iron.
N50°W 55.59' nail & cap in 36" maple.
S30°W 38.57' road sign post.
N45°E 51.64' nail & cap in 24" maple.
S50°E 86.01' nail & cap in P.P.

March 13, 1973
Survey by David T. Rowe, RLS #11192, L-2, P-352
Fnd. P.K. nail
North 0.6' ± to centerline of M-24.
South 36.34' RLS #11192 tag in corner post.
N05°W 39.80' RLS #11192 tag in 14" hickory.

March, 1973 L.C.R.C. form filed by D. T. Rowe, RLS #11192 on Page 12, Cor. A-11,
T11N-R10E. Accessories same as Survey L-2, P-352.

July 6, 1974
Survey by Robert G. Kay, RLS #14096, L-444, P-193
North 0.65' to centerline M-24.
South 36.34' tag cor. post.
N05°W 39.80' tag 14" hickory.
Fnd. P.K. nail.

May 28, 1975
Survey by James A. Beck, RLS #21559, L-452, P-640 thru 642
P. K. Nail
South 36.64' RLS #11192 tag in cor. post.
N05°W, 39.80' RLS #11192 tag in 14" hickory.
N40°W, 33.62' South edge of S. leg village limit sign.

Dec. 2, 1976
Survey by David T. Rowe, RLS #11192, L-469, P-960
Iron in monument box.
South 36.64' RLS #11192 tag in cor. post.
N05°W 39.80' RLS #11192 tag in 14" hickory.
N83°35'53"E 5.65' to P.K.
N40°W 33.62' S. edge of S. leg of village limit sign.

July 25, 1977
Survey by Robert G. Kay, RLS #14096, L-476, P-946 & 947
Fnd. mon. box.
South 36.64' RLS #11192 tag cor. post.
N05°W 40.55' RLS #11192 tag 14" hickory.
N40°W 27.65' S. edge of S. leg village limit sign.

Aug. 11, 1977
Survey by Earl E. Gravlin, RLS #23510, L-478, P-484 thru 486
No mention of evidence found or set, no accessories.

Oct. 5, 1978
Survey by Earl E. Gravlin, RLS #23510, L-496, P-1482 & 1483
No mention of object found.
North 0.65' to centerline of M-24.
South 36.34' tag cor. post.
N05°W 39.80' tag 14" hickory.

Dec. 4, 1978
Survey by Bernard R. Feldhauser, Land Surveyor #10685, L-492, P-1099 thru 1106
No mention of evidence found or set or accessories.

Aug. 30, 1989
Survey by Stephan J. Szyszkoski, LLS #33986, L-597, P-936 & 937
Fnd. 1/2" smooth rod in mon. box.
N83°E 6.78' P.K. nail in centerline.
South 36.64' RLS #11192 tag in cor. post.
N05°W 40.55' RLS #11192 tag in 14" hickory.

Aug. 30, 1989
L.C.R.C. form filed by Stephan J. Szyszkoski L.S. 33986
Fnd. rod in mon. box.
N05°W 40.57' fnd. flag/tag E. face 15" hickory.
South 32.50' fnd. REI rod.
S45°E 31.55' set nail/tag #11192 top guard rail post.
N45°E 52.04' set nail/tag #11192 top guard rail post.

A-11

Sheet 2 of 3

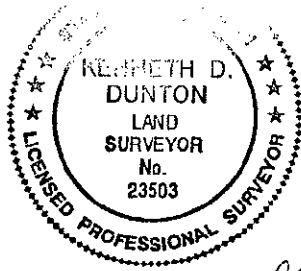
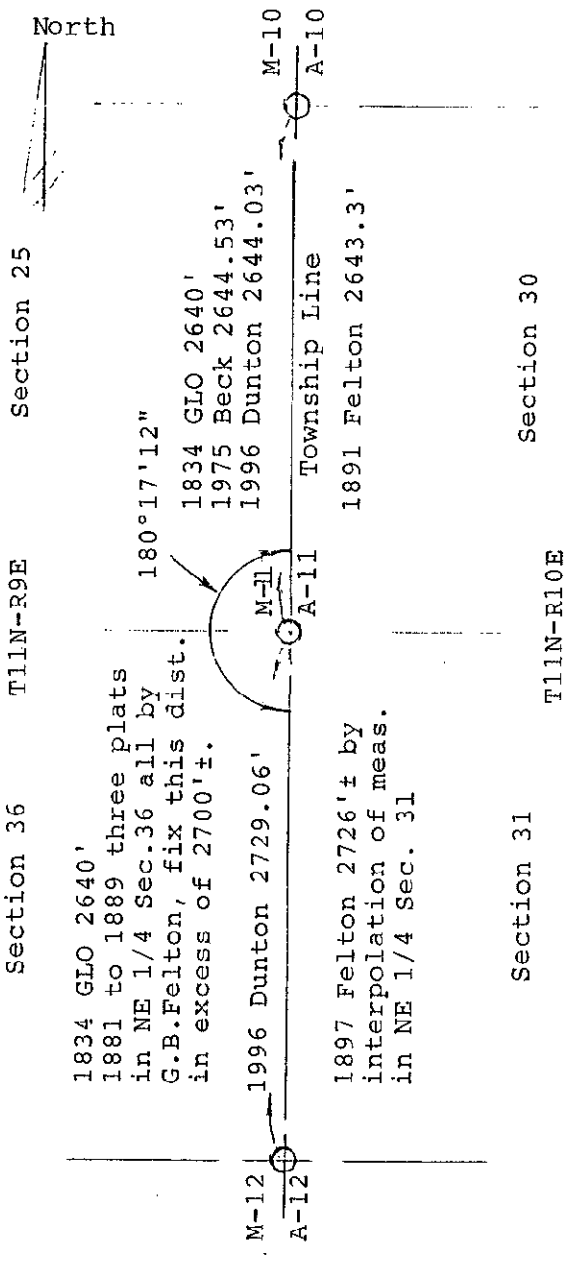

APPROVED
11-6-96
[Signature]

Sheet 3 of 3

A-11

MAY 2 1997