

SURVEY &
REMONUMENTATION

OCT 20 1994

COMMISSION

1994 REMONUMENTATION PROGRAM
LAND CORNER RECORDATION CERTIFICATE
Filing Requirement of Act 74, Mich. P.A. 1970

For corners in DAYTON TOWNSHIP

RECEIVED FOR RECORD
LIBER NO. _____ PAGE NO. _____
FILING NO. # 64
DAYTON TOWNSHIP
94 OCT -4 AM 10:32
VIRGINIA H. McLAUGHLIN
TUSCOLA COUNTY
REGISTER OF DEEDS

TUSCOLA (County)	Located In:	Corner Code #
1. Public Land Survey	T <u>11N</u> R <u>10E</u>	<u>E-13</u>
	T _____ R _____	_____
	T _____ R _____	_____
	T _____ R _____	_____
2. Property Controlling in Section	S _____ T _____ R _____	_____
	S _____ T _____ R _____	_____
3. Miscellaneous Property in Sec.	S _____ T _____ R _____	_____
	S _____ T _____ R _____	_____

Register of Deeds Stamp & File Number

4. Lot No. _____, Recorded Plat _____
5. Private Claims _____

	A	B	C	D	E	F	G	H	I	J	K	L	M
2	6		5		4		3		2		1		
3													
4	7		8		9		10		11		12		
5													
6	18		17		16		15		14		13		
7													
8	19		20		21		22		23		24		
9													
10	30		29		28		27		26		25		
11													
12	31		32		33		34		35		36		
13													

I, Lionel Roy Emery, in a field survey on May 24, 1994, do hereby certify that under requirements of P.A. 74, Michigan P.A. of 1970, the corner points mentioned in lines 1 and 2 above were in conformance with regulations and rules therefore as required in the current manual of survey instructions of the United States Department of the Interior, Bureau of Land Management or by a decree of a Court of Law and/or that the corner points mentioned in lines 3, 4 and 5 above were in conformance with the rules of the Michigan Board of Land Surveyors or by a Decree of a Court of Law; established, re-established, monumented, re-monumented, recovered, found as expressed below:

NOTE: Not more than 4 corners, all in the same town and range, may be recorded on this certificate.

A. Description of original monument and accessories and/or subsequent restoration:

- 1834 (Gov't. Land Office Notes) Harvey Parke, D.S. -Set post Cor. Sections 32,33- Sugar 14 N28 1/2° E 5; Beech 7 N65 1/2° E 37
- 1973 (Survey -Liber 432, page 223) Robert G. Kay, P.S. #14096 -shows SW Cor, Sec 33, T11N-R10E no object given witnesses: N50°E 44.47' -Nail in T.P.; South 14.58' E. Leg Sign; N60°W 41.93' Sign Post
- 1973 (Survey -Liber 432, page 222) Robert G. Kay, P.S. #14096 -shows same information as above
- 1974 (Survey -Liber 444, page 195) " " " " " " " " " "
- 1977 (Survey for Lakehill Development Co.) Feldhauser & Associates -Fnd. 1/2" Rod- no further info
- 1981 (Survey -Liber 519, page 357) Earl E. Gravlin, P.S. #23510 -Found 1/2" Iron- N50°E 48.57' nail in T.P.

B. Description of corner evidence found and/or method applied in restoring or reestablishing corner:

Found 1/2" reinforcing rod and remaining accessories from 1981 and subsequent surveys. Accessories from Kay's 1973 and 1974 surveys obliterated, measured from found marker 1324.5 feet Easterly to "Old Existing Fence Line" as shown on Kay's 1974 survey. The sum of Kay's distances to fence line is 1324.75 feet. Determined found marker to be object Kay was using as the Southwest corner marker of Section 33 for his 1973-'74 surveys. Accepted found marker as marking location of original corner.

C. Description of monument for corner and accessories established to perpetuate locating the position of the corner:

Removed reinforcing rod and replaced with Standard Tuscola County Concrete Monument w/2" Brass Cap stamped E13 T11N R10E
N50°E, 49.00' -T.C. Remon. tag over found P.K. nail in Southeast face of power pole
N65°E, 80.92' -T.C. Remon. tag in Southeast face of 10" Ash
S80°W, 124.88' -T.C. Remon. tag over found P.K. nail in South face of 6" Wood post
N70°W, 129.65' -T.C. Remon. tag in Northeast face of telephone stub

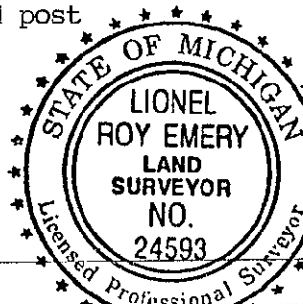

Signed by Lionel Roy Emery Date October 4, 1994
Surveyor's Michigan License No. 24593

APPROVED
E-31-94

S20°W 17.00' West leg sign post; N60°W 39.55' Sign post
 1990 (Land Corner Recordation Certificate) Kenneth D. Dunton, P.S. #23503 Found ½" rod.-
 N45°E 48.7' nail & Sq. tag in P.P.; N50°E 52.3' nail in 6" sq. corner post; N70°E 80.8' na
 in South face of 8" Ash; N45°W 36.0' Road sign post
 1993 (Survey for Dwight Bell) Jonathan Field, P.S. #37278 -Fnd ½" Rod- N45°E, 48.85' Fnd. P-K n
 in SE face P.pole; N50°E, 52.3' Fnd. Dbl. head nail in fence post; N70°E, 80.8' Fnd. Dbl.
 head nail in S. face 8" Ash; S15°W, 16.60' W. Leg of Directional sign post; N50°W, 36.10'
 Center of road sign post

