

SURVEY &  
REMONUMENTATION

MAY 05 1997

1996 REMONUMENTATION PROGRAM

COMMISSION

LAND CORNER RECORDATION CERTIFICATE  
Filing Requirement of Act 74, Mich. P.A. 1970

For corners in Juniata Township

TUSCOLA  
(County)

Located In:

Corner Code #

- |                                    |  |              |
|------------------------------------|--|--------------|
| 1. Public Land Survey              | T <u>12</u> N R <u>8</u> E             | ✓ <u>A-2</u> |
|                                    | T <u>   </u> R <u>   </u>              |              |
|                                    | T <u>12</u> N R <u>7</u> E             | <u>M-2</u>   |
|                                    | T <u>   </u> R <u>   </u>              |              |
| 2. Property Controlling in Section | S <u>   </u> T <u>   </u> R <u>   </u> |              |
|                                    | S <u>   </u> T <u>   </u> R <u>   </u> |              |
| 3. Miscellaneous Property in Sec.  | S <u>   </u> T <u>   </u> R <u>   </u> |              |
|                                    | S <u>   </u> T <u>   </u> R <u>   </u> |              |

RECEIVED FOR RECORD  
 LIBER NO. \_\_\_\_\_ PAGE NO. \_\_\_\_\_  
 FILE NO. # 99 Juniata  
 96 OCT 31 AM 10:39  
 JUNIATA COUNTY  
 REGISTER OF DEEDS

Register of Deeds Stamp & File Number

4. Lot No. \_\_\_\_\_, Recorded Plat \_\_\_\_\_  
 5. Private Claims \_\_\_\_\_

I, Kenneth D. Dunton, in a field survey on Oct. 21, 1995 do hereby state that under requirements of P.A. 74, Michigan P.A. of 1970, the corner points mentioned in lines 1 and 2 above were in conformance with regulations and rules therefore as required in the current manual of survey instructions of the United States Department of the Interior, Bureau of Land Management or by a decree of a Court of Law and/or that the corner points mentioned in lines 3, 4 and 5 above were in conformance with the rules of the Michigan Board of Land Surveyors or by a Decree of a Court of Law, established, re-established, monumented, recovered, found as expressed below:

NOTE: Not more than 2 corners, all in the same town and range, may be recorded on this certificate.

A	B	C	D	E	F	G	H	I	J	K	L	M
1												
2	6	5	4	3	2	1						
3												
4	7	8	9	10	11	12						
5												
6	19	17	16	15	14	13						
7												
8	19	20	21	22	23	24						
9												
10	30	29	28	27	26	25						
11												
12	31	32	33	34	35	36						
13												

A. Description of original monument and accessories and/or subsequent restoration:

1834 G.L.O. Notes  
 Orange Risdon  
 Set 1/4 Section Post  
 Beech 10 N20E 4L  
 Beech 10 S43W 46L  
 Corner M-2, T12N-R7E

October 25, 1973 Survey by David T. Rowe, R.L.S. #11192, recorded in Liber 436, Pages 257 & 258, Tuscola County records. 5/8" re-rod. S65°E 186.90' R.L.S. #11192 tag in N. leg o.h. power line. South 45.00' boat spike on centerline o.h. power lines East and West.  
 October, 1973 Act 74 form filed on Page 27 Denmark Township. Fnd. 5/8" rod. Same accessories as Liber 436, Pages 257 & 258.  
 Dec. 20, 1974 Act 74 form filed on Page 28, Denmark Township. Fnd. 5/8" rod. Same accessories as Liber 436, Pages 257 & 258.

B. Description of corner evidence found and/or method applied in restoring or reestablishing corner:

Fnd. P.K. Nail - and checked distances of 186.90' to #11192 tag in W. face p.p. & 45'+ to centerline o.h. H-towers. Northwest 4.55' found 1/2 of cast iron stove lid, bricks & ironstone china around 4" square wood post. Post hacked to point. Accepted wood post as the proper position of Corner A-2, T12N-R7E.

C. Description of monument for corner and accessories established to perpetuate locating the position of the corner:

Removed wood post and placed concrete monument with standard brass cap stamped Corner M-2, T12N-R7E. Set 11-18-95.  
 Placed monument box over monument.  
 S35°16'W 23.00' set 1/2" x 18" re-rod in road shoulder.  
 N56°30'W 17.70' set 1/2" x 18" re-rod in road shoulder.  
 N58°28'E 19.42' set 1/2" x 18" re-rod in road shoulder.  
 S77°55'E 189.70' found #11192 tag & nail in West face N. leg "H" tower.  
 S26°19'E 4.55' spike at previous position of P.K. nail found.  
 S49'+ centerline "H" towers E & W.

Note: This corner is common with M-2, T12N-R7E.

Signed by [Signature] Date \_\_\_\_\_  
 Surveyor's Michigan License No. 23503



APPROVED  
10-23-96  
[Signature]

FORM APPROVED BY MICHIGAN STATE BOARD OF PROFESSIONAL SURVEYORS, JAN. 28, 1971  
 REVISED MAY 14, 1975  
 REVISED JAN. 1983  
 REVISED OCT., 1985

COPY

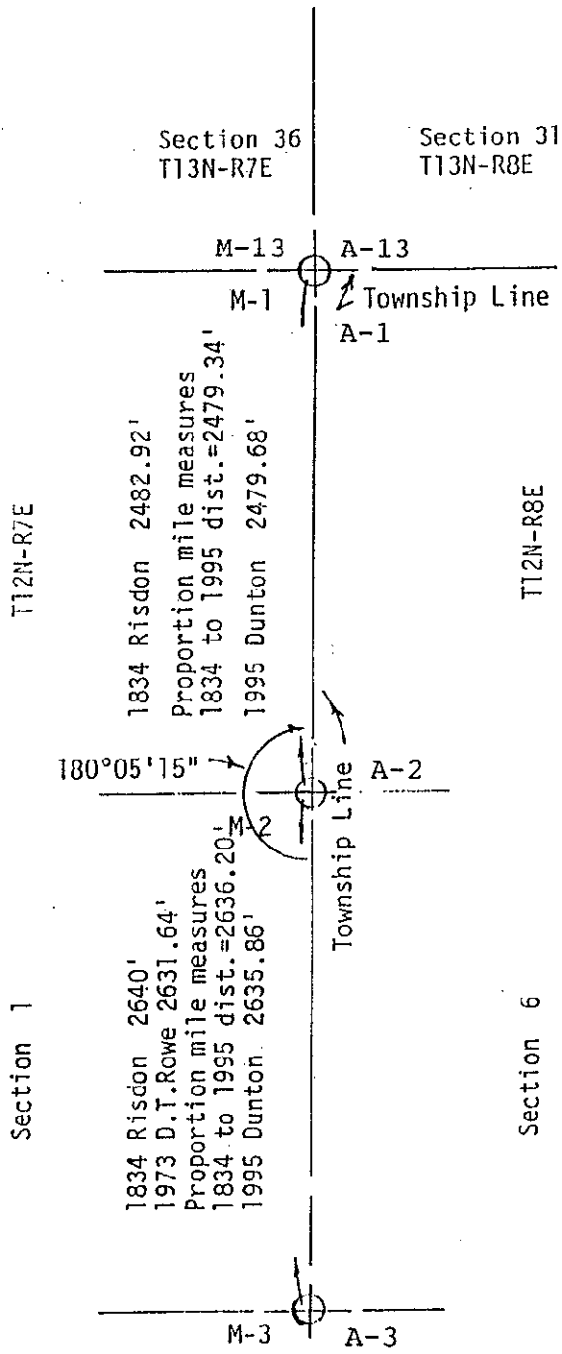

COPY