

SURVEY & REMONUMENTATION

MAY 05 1997

1996 REMONUMENTATION PROGRAM

COMMISSION

LAND CORNER RECORDATION CERTIFICATE
Filing Requirement of Act 74, Mich. P.A. 1970

For corners in Juniata Township

TUSCOLA
(County)

Located In:

Corner Code #

- | | | |
|------------------------------------|--|------------|
| 1. Public Land Survey | T <u>12N</u> R <u>8E</u> | <u>A-5</u> |
| | T <u> </u> R <u> </u> | <u> </u> |
| | T <u>12N</u> R <u>7E</u> | <u>M-5</u> |
| | T <u> </u> R <u> </u> | <u> </u> |
| 2. Property Controlling in Section | S <u> </u> T <u> </u> R <u> </u> | <u> </u> |
| | S <u> </u> T <u> </u> R <u> </u> | <u> </u> |
| 3. Miscellaneous Property in Sec. | S <u> </u> T <u> </u> R <u> </u> | <u> </u> |
| | S <u> </u> T <u> </u> R <u> </u> | <u> </u> |

RECEIVED FOR RECORD
LIBER NO. _____ PAGE NO. _____
FILE NO. # 86 Juniata
96 OCT 31 AM 10:39
TUSCOLA COUNTY REGISTER OF DEEDS
Register of Deeds Stamp & File Number

4. Lot No. _____, Recorded Plat _____
5. Private Claims _____

I, Kenneth D. Dunton, in a field survey on Oct. 21, 1996 do hereby state that under requirements of P.A. 74, Michigan P.A. of 1970, the corner points mentioned in lines 1 and 2 above were in conformance with regulations and rules therefore as required in the current manual of survey instructions of the United States Department of the Interior, Bureau of Land Management or by a decree of a Court of Law and /or that the corner points mentioned in lines 3, 4 and 5 above were in conformance with the rules of the Michigan Board of Land Surveyors or by a Decree of a Court of Law; established, re-established, monumented, recovered, found as expressed below:

NOTE: Not more than 2 corners, all in the same town and range, may be recorded on this certificate.

1	A	B	C	D	E	F	G	H	I	J	K	L	M
2		6		5		4		3		2		1	
3													
4		7		8		9		10		11		12	
5													
6		18		17		16		15		14		13	
7													
8		19		20		21		22		23		24	
9													
10		30		29		28		27		26		25	
11													
12		31		32		33		34		35		36	
13													

A. Description of original monument and accessories and/or subsequent restoration:

1834 G.L.O. Notes 1928 M.S.H.D. plans. Iron pin in wagon hub. Tel. pole
Orange Risdon, D.S. N58°45'E 37.6', fence corner N41°00'W 43.1', tel. pole
Set Post Corner of S56°15'W 40.6'.
Section 12 & 13 May 22, 1971 Survey by David T. Rowe, L.S. #11192, recorded
Sugar 2 S46W 41L in Liber 1, Page 47 Tuscola County Records. Fnd. 1" bolt
Beech 12 N19W 42L in mon. box. S40°E 55.24' nail in p.p., S35°W 76.34' nail
Corner M-5, T12N-R7E in l.p.
Section A continued on back of form. May 28, 1971 Survey by Richard L. Sides, L.S. #13042 re-
witnesses.

B. Description of corner evidence found and/or method applied in restoring or reestablishing corner:

Found 1" boat spike in monument box. Accepted as the proper location of Corner A-5.

C. Description of monument for corner and accessories established to perpetuate locating the position of the corner:

Placed standard brass cap stamped Corner M-5, T12N-R7E over 1" spike and encased cap & spike in concrete in monument box. Set 11-18-95.
S28°39'W 49.30' North cor. iron frame of catch basin.
S47°44'W 76.10' center 4" iron lamp post.
N55°02'W 63.35' top SE corner conc. base tele ped.
N38°39'W 56.25' center 3" iron post in concrete.
S35°38'E 55.29' fnd. dbl. headed nail & M.S.H.D. tag in NE face p. pole.
Also, #11192 tag in NE face & nail & bottle cap in NW face.

Note: This corner is common with M-5, T12N-R7E.

Signed by [Signature] Date 10-23-96
Surveyor's Michigan License No. 23503

APPROVED [Signature]
10-23-96

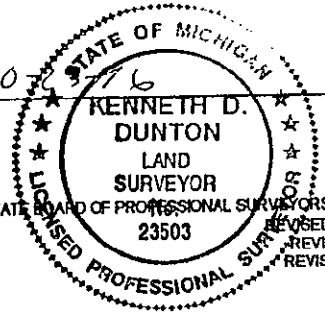

FORM APPROVED BY MICHIGAN STATE BOARD OF PROFESSIONAL SURVEYORS, JAN. 28, 1971
REVISED MAY 14, 1975
REVISED JAN. 1983
REVISED OCT., 1995

CADV

Section A continued:

- Oct. 18, 1971 Survey by Richard L. Sides, L.S. #13042, recorded in Liber 1, Page 205 Tuscola County Records. NW 58.9' utility pole, NE 55.1' utility pole, SW 57.0' sign post.
- Dec. 6, 1972 Act '74 form filed by David T. Rowe, R.L.S. #11192, filed on Page 13 Denmark Twp. Fnd. 1" bar. N35°W 58.35' nail & cap in t.p., S40°E 55.24' nail & cap in p.p., S35°W 76.34' nail & cap in l.p., S35°E 52' rd. sign post, South 14.1' centerline 24' asph. surface.
- Oct. 2, 1972 Survey by Stephen Soltis, Jr., R.L.S. #19007, recorded in Liber 2, Page 72 Tuscola County Records. No mention of iron found or set or accessories.
- Oct. 2, 1972 Act 74 form filed by Stephen Soltis, Jr., L.S. #19007 filed on Page 8 of Denmark Township, Northwest 58.9' utility pole, Northeast 55.1' utility pole, Southwest 57.0' sign post.
- Aug. 16, 1973 Act 74 form filed by David T. Rowe, R.L.S. #11192, filed on Page 21, Denmark Township. Fnd. 1" bar. N35°W 58.35' nail & cap in t.p., S40°E 55.24' nail & cap in p.p., S35°E 52' rd. sign post.
- Aug. 6, 1974 Survey by David T. Rowe, R.L.S. #11192 recorded in Liber 445, Page 752 Tuscola County Records. Fnd. 1" bolt in mon. box. S35°W 76.34' nail in l.p., S40°E 55.24' nail in p.p., South 14.1' center line of 24' asph. surface.
- June 10, 1976 Survey by Robert G. Kay, R.L.S. #14096 recorded in Liber 460, Page 597 Tuscola County Records. Found mon. box. S45°E 55.23' nail in p.p., S45°W 49.33' N. cor. C.B., N50°W 63.93' SE cor. concrete pad.
- Mar. 29, 1985 Survey by Lionel Roy Emery, L.S. #24593 recorded in Liber 544, Page 376 Tuscola County Records. Fnd. iron in mon. box. S40°E 55.24' N. & C. in pwr. pole, S35°E 52' road sign post, S35°W 76.34' N. & C. in l.p., N35°W 58.35' N. & C. in tele. pole.
- April 27, 1987 Survey by Jack N. Owens, L.S. #20709, recorded in Liber 571 on Page 1355 Tuscola County Records. Found 1" bar in mon. box. S40°E 55.24' nail & cap in p.p., S35°W 76.34' nail & cap in l.p., S35°E 52' road sign post, South 14.1' C/L of pavement.
- June 4, 1990 Survey by Kenneth D. Dunton, L.S. #23503 recorded in Liber 608, Pages 1137 & 1138, Tuscola County Records. No mention of object found or set or accessories.

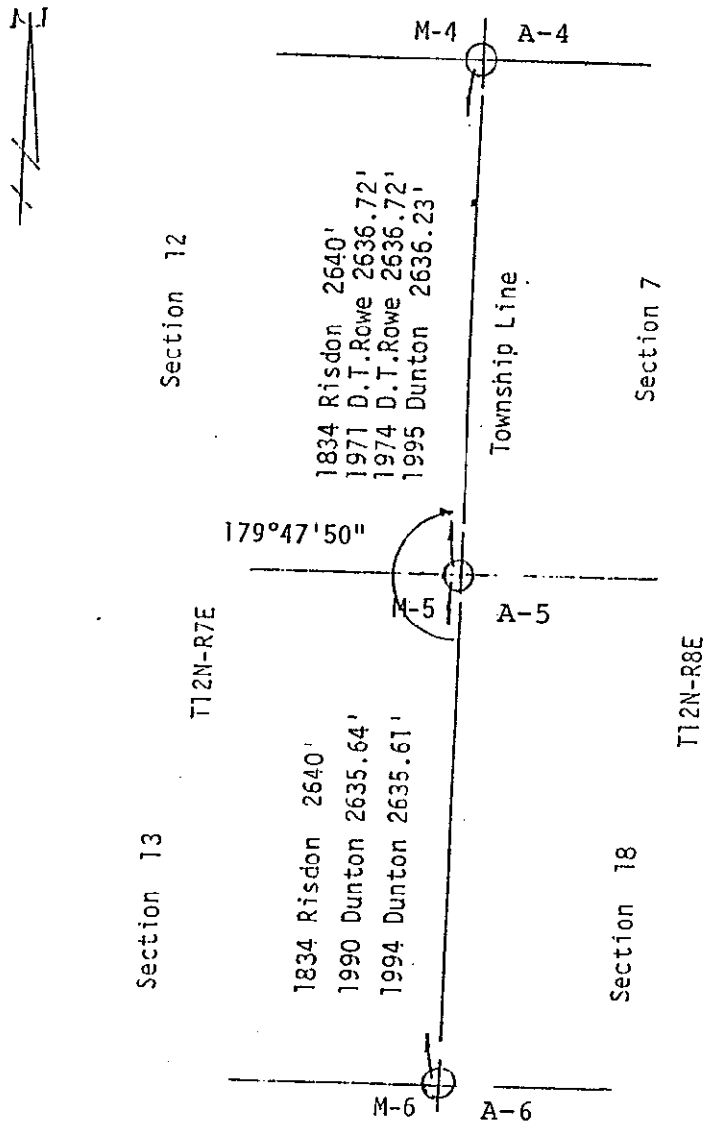

COPY