

**SURVEY &
REMONUMENTATION**

MAY 05 1997

1996 REMONUMENTATION PROGRAM

COMMISSION

LAND CORNER RECORDATION CERTIFICATE
Filing Requirement of Act 74, Mich. P.A. 1970

For corners in Juniata Township

<u>TUSCOLA</u> (County)	Located In:	Corner Code #
1. Public Land Survey.	T <u>T12NR 8E</u>	<u>A-7</u>
	T <u> </u> R <u> </u>	
	T <u>T12N R7E</u>	<u>M-7</u>
	T <u> </u> R <u> </u>	
2. Property Controlling in Section	S <u> </u> T <u> </u> R <u> </u>	
	S <u> </u> T <u> </u> R <u> </u>	
3. Miscellaneous Property in Sec.	S <u> </u> T <u> </u> R <u> </u>	
	S <u> </u> T <u> </u> R <u> </u>	

RECEIVED FOR RECORD
LIBER NO. _____ PAGE NO. _____
FILE NO. # 84 Juniata
96 OCT 31 AM 10:38
TUSCOLA COUNTY
REGISTER OF DEEDS
Register of Deeds Stamp & File Number

4. Lot No. _____, Recorded Plat _____
5. Private Claims _____

I, Kenneth D. Dunton, in a field survey on Oct. 20, 1995, do hereby state that under requirements of P.A. 74, Michigan P.A. of 1970, the corner points mentioned in lines 1 and 2 above were in conformance with regulations and rules therefore as required in the current manual of survey instructions of the United States Department of the Interior, Bureau of Land Management or by a decree of a Court of Law and /or that the corner points mentioned in lines 3, 4 and 5 above were in conformance with the rules of the Michigan Board of Land Surveyors or by a Decree of a Court of Law, established, re-established, monumented, recovered, found as expressed below:

A	B	C	D	E	F	G	H	I	J	K	L	M
1												
2	6		5		4		3		2		1	
3												
4	7		8		9		10		11		12	
5												
6	18		17		16		15		14		13	
7												
8	19		20		21		22		23		24	
9												
10	30		29		28		27		26		25	
11												
12	31		32		33		34		35		36	
13												

NOTE: Not more than 2 corners, all in the same town and range, may be recorded on this certificate.

A. Description of original monument and accessories and/or subsequent restoration:

1834 G.L.O. Notes
Orange Risdon
Set post corner of Section 13 & 24
Sugar 12 S58W 15L
Hickory 9 N25W 31L
Corner M-7, T12N-R7E

Aug. 30, 1971 Survey by Richard L. Sides, L.S. #13042, recorded in Liber 1 Page 205, Tuscola County Records. SW 56' utility pole, SE 108.30' 40" maple tree, E 29.75' sign post.

Nov. 10, 1980 Survey by Kenneth D. Dunton, L.S. #23503, recorded in Liber 509, Page 1329, Tuscola County Records. Fnd. 5/8" rod. S55°W 56.27' p.k. nail in p.p. S20°E 108.80' p.k. nail in 30" maple. East 3.0' centerline of pavement.

Section A continued on back of form.

B. Description of corner evidence found and/or method applied in restoring or reestablishing corner:

Found 1/2" re-rod in place. Accepted as the proper position of Corner A-7.

C. Description of monument for corner and accessories established to perpetuate locating the position of the corner:

Removed 1/2" re-rod and placed concrete monument with standard brass cap stamped Corner M-7, T12N-R7E. Placed monument box over monument. Set 11-19-95.
S59°13'W 58.24' fnd. #11192 tag & spike in SE face p. pole.
S16°56'E 108.73' set T. C. Remon. tag & spike above P.K. nail found in West face 42" maple.
N37°52'W 39.88' set 1/2" x 18" re-rod in road shoulder.
N47°25'E 26.62' set 1/2" x 18" re-rod in road shoulder.
S57°28'E 24.24' set 1/2" x 18" re-rod in road shoulder.

Note: This corner is common to M-7, T12N-R7E.

Signed by [Signature]
Surveyor's Michigan License No. 23503

Date [Signature]

APPROVED
10-23-96

[Signatures]

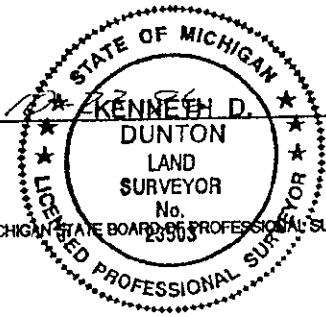

FORM APPROVED BY MICHIGAN STATE BOARD OF PROFESSIONAL SURVEYORS, JAN. 28, 1971
REVISED MAY 14, 1975
REVISED JAN., 1983
REVISED OCT., 1985

COPY

Section A continued:

Sept. 17, 1982 Act 74 form filed by Kenneth D. Dunton, L.S. #23503 on Page 43 Juniata Township. Same accessories as Survey Liber 509, Page 1329.

Apr. 9, 1985 Survey by Lionel Roy Emery, L.S. #24593 recorded in Liber 549, Page 376 Tuscola County Records. Accessories same as Survey Liber 509 Page 1329.

June 24, 1988 Act 74 form filed by Paul A. Brown L.S. #33134, filed on Page 49, Juniata Township. Fnd. 5/8" rod. S50°W 50.50' C/L of galv. st. sign post, S55°W 58.27' set tag #11192 in ESE face of p.p., S20°E 108.78' fnd. p.k. & flag in W. face of 30" maple.

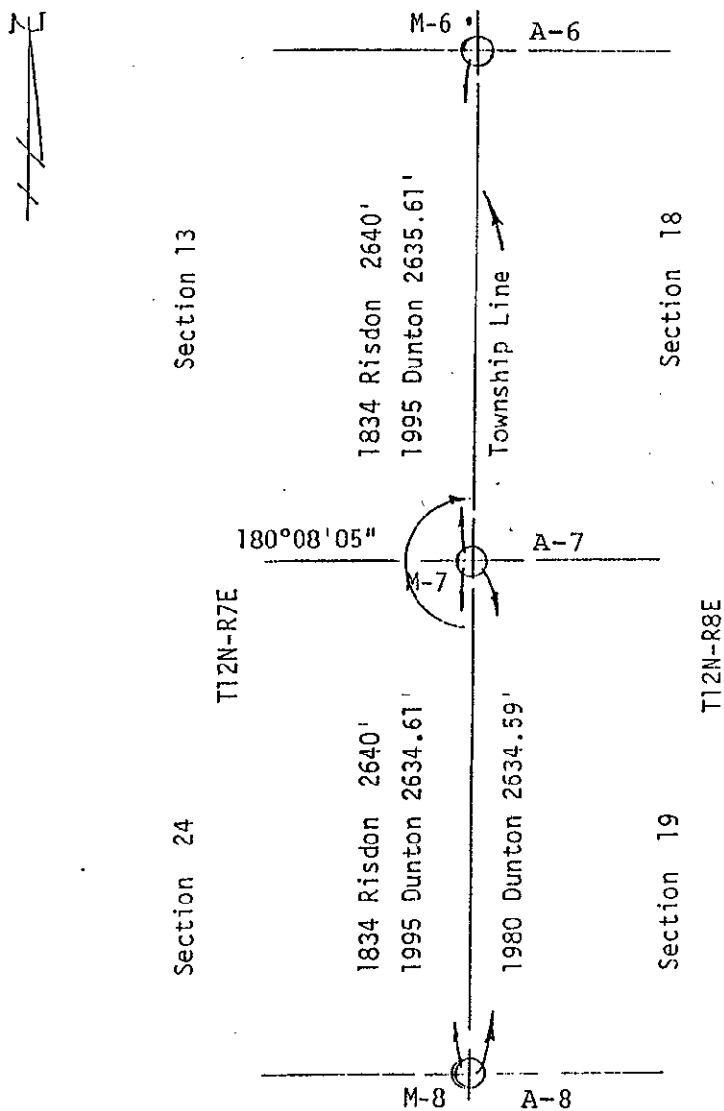

COPY