

SURVEY & REMONUMENTATION

MAR 02 1999

1998 REMONUMENTATION PROGRAM

RECEIVED FOR RECORD

LIBER NO. _____ PAGE NO. _____

FILE NO. #100

INDIANFIELDS TWP
98 NOV 12 PM 4:13

SECTION

LAND CORNER RECORDATION CERTIFICATE
Filing Requirement of Act 74, Mich. P.A. 1970

For corners in Indianfields Township

Tuscola (County)	Located In:	Corner Code #
1. Public Land Survey	T12N R 9E	M-5
	T _____ R _____	_____
	T _____ R _____	_____
	T _____ R _____	_____
2. Property Controlling in Section	S _____ T _____ R _____	_____
	S _____ T _____ R _____	_____
3. Miscellaneous Property in Sec.	S _____ T _____ R _____	_____
	S _____ T _____ R _____	_____

Gregory M. Dunton
TUSCOLA COUNTY
REGISTER OF DEEDS

Register of Deeds Stamp & File Number

4. Lot No. _____, Recorded Plat _____
5. Private Claims _____

I, Kenneth D. Dunton, in a field survey on May 30, 1998 do hereby state that under requirements of P.A. 74, Michigan P.A. of 1970, the corner points mentioned in lines 1 and 2 above were in conformance with regulations and rules therefore as required in the current manual of survey instructions of the United States Department of the Interior, Bureau of Land Management or by a decree of a Court of Law and/or that the corner points mentioned in lines 3, 4 and 5 above were in conformance with the rules of the Michigan Board of Land Surveyors or by a Decree of a Court of Law, established, re-established, monumented, recovered, found as expressed below:

NOTE: Not more than 2 corners, all in the same town and range, may be recorded on this certificate.

	A	B	C	D	E	F	G	H	I	J	K	L	M
1													
2		6		5		4		3		2		1	
3													
4		7		8		9		10		11		12	
5													
6		18		17		16		15		14		13	
7													
8		19		20		21		22		23		24	
9													
10		30		29		28		27		26		25	
11													
12		31		32		33		34		35		36	
13													

A. Description of original monument and accessories and/or subsequent restoration:

G.L.O. notes Nov. 17, 1834 by H. Parke, D.S., set post corner Sections 12 & 13, Birch 15" S56°W 36 links, Elm 9" N48°W 12 links. May 1972 L.C.R.C. #6 by David T. Rowe, L.S. #11192, set P.K. nail as-occupied in centerline-centerline roads, S40°E 34.35' road sign post, S45°E 30.95' P.K. nail in 20" Maple, S50°W 95.81' P.K. nail in P. pole. Feb. 2, 1972 Survey L-1, P-351 by David T. Rowe, L.S. #11192. Same object and accessories as L.C.R.C. #6. Dec. 15, 1975 L.C.R.C. #26 by Robt. J. Tommer, Jr. L.S. #22444. Set "T" iron, re-established M-5 according to G.L.O. notes and on same line as A-5 and A-6, South 6.60' to P.K. nail (NW corner Sec. 18, T12N-R10E), S45°E 36.00' nail in NW face of 24" Maple, S60°W 98.31' to nail in E. face P. pole.

B. Description of corner evidence found and/or method applied in restoring or reestablishing corner:

Found 1/2" iron rod & accepted as the best evidence of the original corner.
I agree with the 1976 note by Rowe Engineering that Tommer set Corner A-5, T12N-R10E, incorrectly.
Corner M-5, T12N-R9E is common with Corner A-5, T12N-R10E.

C. Description of monument for corner and accessories established to perpetuate locating the position of the corner:

Removed 1/2" rod & perpetuated with standard monument stamped M-5, T12N-R9E. Placed monument box.
S70°W 96.23' set remon. tag & spike in SE face utility pole.
S45°E 32.14' set remon. tag & spike in NE face 20" Maple.
North 26.96' set remon. tag & spike in West face railroad tie corner post.
North 6.56' found "T" iron.
S35°E 34.54' center of road sign post.

Signed by *Kenneth D. Dunton*
Surveyor's Michigan License No. 23503

Date 11-2-98

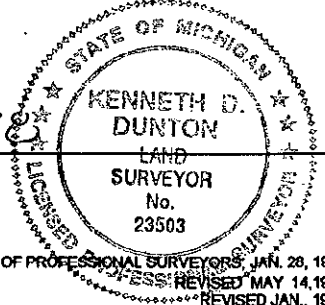

APPROVED
11-2-98 *J.M.T.*

Section A con't.

Jan. 13, 1976 the following note appears on the back side of a Rowe Engineering, Inc. witness card; G.L.O. notes for T12N-R10E say West random between Sections 7 & 18, intersected West boundary 10 links South (6.60') East corrected between 7 & 18, therefore Tommer set this "T" iron incorrectly. March 19, 1980 Survey L-508, P-1091 by James A. Beck, L.S. #21559, fnd. P.K. nail, same accessories as L.C.R.C. Page 6. *Nov. 8, 1988 Surveys L-589, P-949 & 950 and L-587, P-1085 & 1086 by Russell L. Brown, L.S. #24588, fnd. "T" iron, S60°W 98.1' P.K. nail in P. pole, N40°W 36.0' spike in 12" Ash, S30°E 36.9' spike in 24" Maple. Dec. 18, 1992 Survey L-644, P-326 & 327 by Jonathan M. Field, P.S. #37276, set 1/2" rod with cap #37276, S50°W 95.81' fnd. P.K. in E. face P. pole, S45°E 30.95' fnd. P.K. in NW face 25" Maple, North 26.95' set P.K. & tag #37276 in W. face wood fence post, N50°W 36.54' set P.K. & tag #37276 in SW face 12" Elm, S40°E 34.41' fnd. NW face road sign post.

*March 9, 1988 Survey L-587, P-76,77,78 & 79 by Kenneth D. Dunton PS #23503, no object or accessories mentioned. 1988 and 1998 distances measured to corner M-4 would indicate that corner A-5 by Tommer was held for this survey.

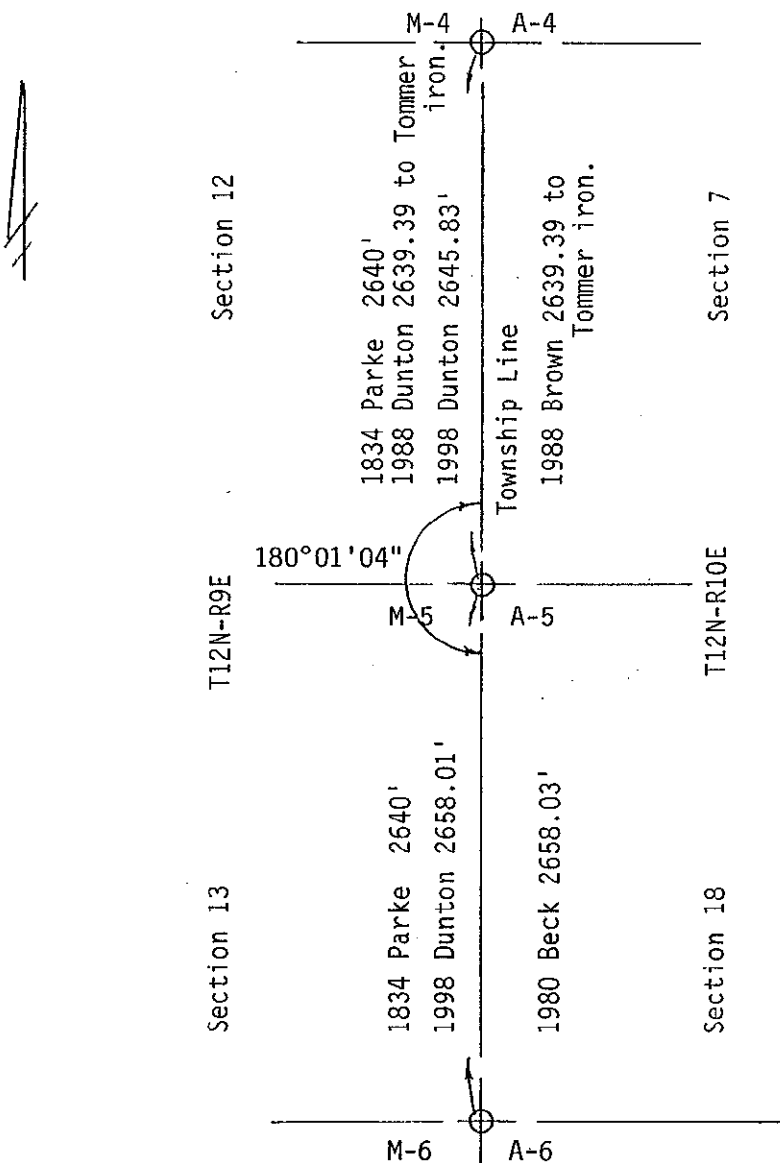

SURVEY &
REMONUMENTATION

MAR 02 1999

SECTION