

MAR 02 1999

SECTION

1998 REMONUMENTATION PROGRAM
LAND CORNER RECORDATION CERTIFICATE
Filing Requirement of Act 74, Mich. P.A. 1970

For corners in Wells Township

<u>Tuscola</u> (County)	Located In:	Corner Code #
1. Public Land Survey	T12N R10E	M-12
	T ___ R ___	_____
	T ___ R ___	_____
	T ___ R ___	_____
2. Property Controlling in Section	S ___ T ___ R ___	_____
	S ___ T ___ R ___	_____
3. Miscellaneous Property in Sec.	S ___ T ___ R ___	_____
	S ___ T ___ R ___	_____

RECEIVED FOR RECORD
LIBER NO. _____ PAGE NO. _____
FILE NO. #61
WELLS TWP
98 DEC 10 PM 4:12
JAMES M. DUNTON
TUSCOLA COUNTY
REGISTER OF DEEDS
Register of Deeds Stamp & File Number

4. Lot No. _____, Recorded Plat _____
5. Private Claims _____

I, Kenneth D. Dunton, in a field survey on April 18 19 98 do hereby state that under requirements of P.A. 74, Michigan P.A. of 1970, the corner points mentioned in lines 1 and 2 above were in conformance with regulations and rules therefore as required in the current manual of survey instructions of the United States Department of the Interior, Bureau of Land Management or by a decree of a Court of Law and /or that the corner points mentioned in lines 3, 4 and 5 above were in conformance with the rules of the Michigan Board of Land Surveyors or by a Decree of a Court of Law; established, re-established, monumented, recovered, found as expressed below:

NOTE: Not more than 2 corners, all in the same town and range, may be recorded on this certificate.

1	A	B	C	D	E	F	G	H	I	J	K	L	M
2		6		5		4		3		2		1	
3													
4		7		8		9		10		11		12	
5													
6		18		17		16		15		14		13	
7													
8		19		20		21		22		23		24	
9													
10		30		29		28		27		26		25	
11													
12		31		32		33		34		35		36	
13													

A. Description of original monument and accessories and/or subsequent restoration:

G.L.O. Notes Nov. 17, 1834 by H. Parke, D.S., set 1/4 section post, Beech 12" S16°W 46 links, Pine 40" N69 1/2°W 39 links. June 24, 1895 Survey Pages 272 & 273 of Sec. 36, T12N-R10E by Edward L. Teskey, County Surveyor, previously established by Palmer from B.T., perpetuated by stake, no accessories given.

B. Description of corner evidence found and/or method applied in restoring or reestablishing corner:

Found 1/2" iron rod surrounded by circle of rocks & 1' ± NW of 4" wood post. Accepted found 1/2" rod as the best evidence of the original corner:

Corner M-12, T12N-R10E is common with Corner A-12, T12N-R11E.

C. Description of monument for corner and accessories established to perpetuate locating the position of the corner:

Removed 1/2" rod and perpetuated with standard monument stamped M-12, T12N-R10E. Placed carsonite post at monument.
N78°E 25.75' fnd. spike in South face 30" Maple.
S68°E 32.48' fnd. spike in North face 8" wood cor. post, fence E & S.
N45°W 18.97' fnd. spike in SW face 15" Ash (S. Ash of two).
N21°W 45.55' fnd. spike in East face 24" Hemlock.
East 10.5' ± centerline N-S trail.

Signed by [Signature]
Surveyor's Michigan License No. 23503

Date 11-25-98

APPROVED
11-25-98
[Signatures]

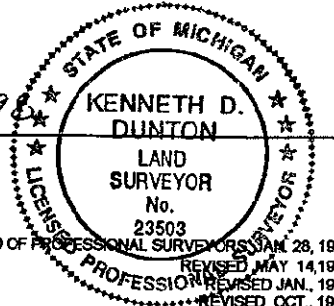

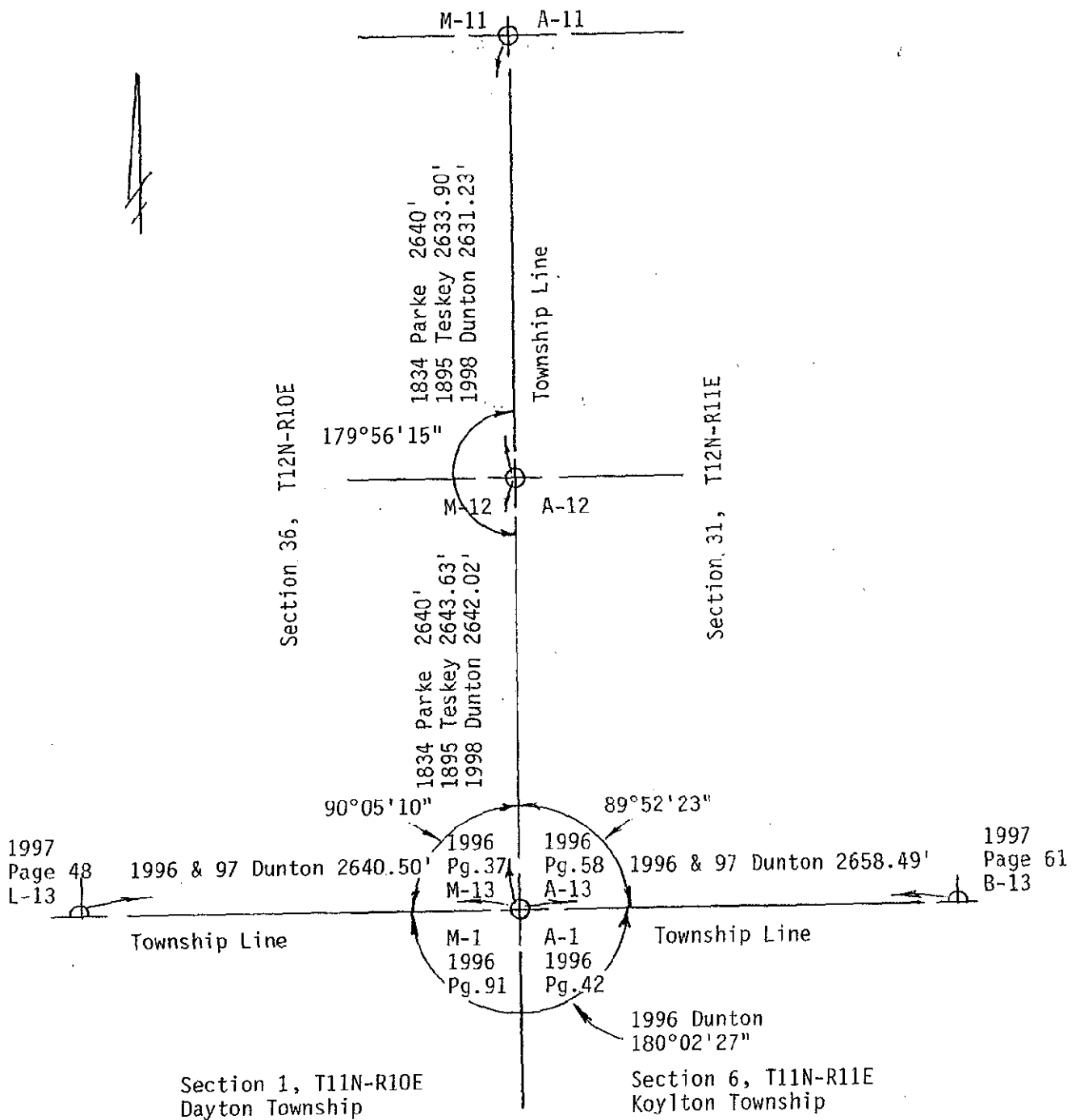

**SURVEY &
REMONUMENTATION**

MAR 02 1999

SECTION