

1996 REMONUMENTATION PROGRAM
 LAND CORNER RECORDATION CERTIFICATE
 Filing Requirement of Act 74, Mich. P.A. 1970

For corners in Wells Twp.

Tuscola Located In: _____ Corner Code # _____
 (County)

1. Public Land Survey T12NR 10E M-13 ✓
~~T12NR 11E~~ ~~A-13~~
~~T11N R 11E~~ ~~A-1~~
~~T11N R 10E~~ ~~M-1~~
2. Property Controlling _____ S _____ T _____ R _____
 in Section _____ S _____ T _____ R _____
3. Miscellaneous _____ S _____ T _____ R _____
 Property in Sec. _____ S _____ T _____ R _____

4. Lot No. _____, Recorded Plat _____
 5. Private Claims _____

I, Kenneth D. Dunton, in a field survey on May 11, 1996 do hereby state that under requirements of P.A. 74, Michigan P.A. of 1970, the corner points mentioned in lines 1 and 2 above were in conformance with regulations and rules therefore as required in the current manual of survey instructions of the United States Department of the Interior, Bureau of Land Management or by a decree of a Court of Law and/or that the corner points mentioned in lines 3, 4 and 5 above were in conformance with the rules of the Michigan Board of Land Surveyors or by a Decree of a Court of Law; established, re-established, monumented, recovered, found as expressed below:

NOTE: Not more than 2 corners, all in the same town and range, may be recorded on this certificate.

A. Description of original monument and accessories and/or subsequent restoration:

GLO 1834, M-1, T11N-R10E Nov. 3, 1882
 Harvey Parke, D.S. John A. Teskey, Co. Surveyor
 Set town corner Sec. 1 T11N-R10E, Pages 28 & 29
 Pine 48 N35E 19 Limestone marked +
 Beech 10 S50W 42 1/2 Maple 1 N 60E 78 1/2
 Beech 9 N63E 35 Pine 48 N35E 19
 Beech 7 N18W 5
 Beech 10 S15E 46

Apr. 14, 1886
 John A. Teskey, Co. Surveyor. Sec. 6, T11N-R11E, Pages 46 & 47. See N.E. Sec. 1 of Dayton, Page 28.

Note: Section A continued on back of form.

B. Description of corner evidence found and/or method applied in restoring or reestablishing corner:

Found 3/4" pipe in monument box. Held pipe as the best evidence of the original corner.

C. Description of monument for corner and accessories established to perpetuate locating the position of the corner:

Placed standard brass cap & 5/8" rod in 3/4" pipe. Encased cap, rod & pipe in concrete in monument box. Stamped cap M-1, T11N-R10E.
 N47°W 45.79' chiseled notch atop W. end of 30' of 12" CSP.
 N07°W 31.67' chiseled notch atop E. end of 30' of 12" CSP.
 N02°W 72.00' S. face of concrete highway R/W marker post.
 N55°E 128.43' set T.C. Remon. tag & spike in S. face P. pole.
 South 2.35' physical E-W centerline concrete pavement.

Note: This corner is common with M-1, T11N-R10E; A-1, T11N-R11E and A-13, T12N-R11E.

Signed by [Signature] Date 12-4-96
 Surveyor's Michigan License No. 23503

'APPROVED'
12-4-96
 RRB
 J.P.B.

RECEIVED FOR RECORD
 LIBER NO. _____ PAGE NO. 37
 FILE NO. Wells
 96 DEC 10 PM 4:50
 TUSCOLA COUNTY
 REGISTER OF DEEDS
 Register of Deeds Stamp & File Number

	A	B	C	D	E	F	G	H	I	J	K	L	M
1													
2	6		5		4		3		2		1		
3													
4	7		8		9		10		11		12		
5													
6	18		17		16		15		14		13		
7													
8	19		20		21		22		23		24		
9													
10	30		29		28		27		26		25		
11													
12	31		32		33		34		35		36		
13													

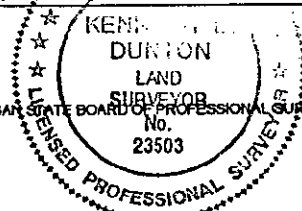

FORM APPROVED BY MICHIGAN STATE BOARD OF PROFESSIONAL SURVEYORS, JAN. 28, 1971
 REVISED MAY 14, 1975
 REVISED JAN. 1983
 REVISED OCT., 1995

REMONUMENTATION
 MAY 20 1997

JUNE 24, 1893
 Edward Teskey, County Surveyor.
 Sec. 36 T12N-R10E, Pages 272 & 273.
 Limestone set by J. A. Teskey

July 1963 M.S.H.D. witness card by H. G. McManus, Survey Chief.
 3/4" iron.
 N70°E 85.50' 14" Walnut.
 S85°W 140.58' 26" Maple.
 S30°E 71.93' T. Pole.

April 20, 1979
 Survey by Charles S. Getz, Land Surveyor #25843, Liber 304-Pages 1069 & 1070.
 Fnd. mon. box.
 South 2.36' to centerline of M-46.
 N05°E 23.65' W. leg of arrow sign.
 S30°E 49.05' face road sign.
 S60°W 84.0' nail guard post.

Dec. 1, 1983
 Survey by Richard R. Boldt, Land Surveyor #28405, Liber 539-Pages 851 & 852.
 Fnd. 1" pipe in mon. box (corner common to all 4 twps.)
 S01°30'11"E 22.00' P.K. on E. sec. line.
 South 2.35' psy. centerline M-46.
 S45°W 84.01' fnd. nail on top wood guard post.
 S40°E 49.04' road sign post.

Dec. 22, 1983
 L.C.R.C. form filed by Richard R. Boldt, Land Surveyor #28405, Page 46,
 Dayton Twp.
 Object & accessories same as Survey L-539, Pages 851 & 852.

Sept. 13, 1995
 Jonathan M. Field, Land Surveyor #37276, Liber 683-Pages 22, 23 & 24.
 Fnd. 1" pipe in mon. box.
 South 2.35' phy's. centerline of M-46.
 S50°W 83.95' fnd. nail in wood post.
 S55°E 28.63' S. edge of conc. at joint.
 N70°E 26.48' N. edge of conc. at joint.

