

**SURVEY & REMONUMENTATION**

MAR 02 1999

1998 REMONUMENTATION PROGRAM

**LAND CORNER RECORDATION CERTIFICATE**  
Filing Requirement of Act 74, Mich. P.A. 1970

SECTION  
For corners in Kingston Township

Tuscola \_\_\_\_\_ Located In: \_\_\_\_\_ Corner Code # \_\_\_\_\_  
(County)

1. Public Land Survey	T <u>12</u> N R <u>11</u> E	A-5
	T _____ R _____	_____
	T _____ R _____	_____
	T _____ R _____	_____
2. Property Controlling in Section	S _____ T _____ R _____	_____
	S _____ T _____ R _____	_____
3. Miscellaneous Property in Sec.	S _____ T _____ R _____	_____
	S _____ T _____ R _____	_____

RECEIVED FOR RECORD  
LIBER NO. \_\_\_\_\_ PAGE NO. \_\_\_\_\_  
FILE NO. #79  
KINGSTON TWP  
98 DEC 10 PM 4:14  
*Gregory Johnson*  
TUSCOLA COUNTY  
REGISTER OF DEEDS  
**Register of Deeds Stamp & File Number**

4. Lot No. \_\_\_\_\_, Recorded Plat \_\_\_\_\_  
5. Private Claims \_\_\_\_\_

I, Kenneth D. Dunton, in a field survey on April 12 19 98 do hereby state that under requirements of P.A. 74, Michigan P.A. of 1970, the corner points mentioned in lines 1 and 2 above were in conformance with regulations and rules therefore as required in the current manual of survey instructions of the United States Department of the Interior, Bureau of Land Management or by a decree of a Court of Law and /or that the corner points mentioned in lines 3, 4 and 5 above were in conformance with the rules of the Michigan Board of Land Surveyors or by a Decree of a Court of Law, established, re-established, monumented, recovered, found as expressed below:

NOTE: Not more than 2 corners, all in the same town and range, may be recorded on this certificate.

	A	B	C	D	E	F	G	H	I	J	K	L	M
1													
2		6		5		4		3		2		1	
3													
4		7		8		9		10		11		12	
5													
6		18		17		16		15		14		13	
7													
8		19		20		21		22		23		24	
9													
10		30		29		28		27		26		25	
11													
12		31		32		33		34		35		36	
13													

A. Description of original monument and accessories and/or subsequent restoration:

G.L.O. Notes Nov. 17, 1834 by H. Parke, D.S., set post corner Sections 12 & 13, Birch 15" S56°W 36 links, Elm 9" N48°W 12 links. Pages 105 & 105 undated survey of Section 12, T12N-R10E by John A. Teskey, County Surveyor (J.A. Teskey was County Surveyor 1886 to 1890) cedar stake previously set, no accessories. Feb. 28, 1995 L.C.R.C. page 57 by Earl E. Gravlin, P.S. #23510, found nothing, no record of surveys, extended centerline of road from West 1/4 corner and extended fence line from North. Set R.R. spike. North 11.50' W. leg of sign, S52°W 47.31' wood corner post, S41°E 52.93' wood post tele. riser. Feb. 28, 1995 Survey L-681, P-1382, 1383 & 1384 by Earl E. Gravlin, P.S. #23510, same object & accessories as L.C.R.C. Page 57.

B. Description of corner evidence found and/or method applied in restoring or reestablishing corner:

Dug & found no evidence other than the railroad spike by Gravlin. Measurement north to Corner M-4 checked J.A. Teskey's measure relatively well. Accepted railroad spike as the best evidence of the original corner.

Corner A-5, T12N-R11E is common with Corner M-5, T12N-R10E.

C. Description of monument for corner and accessories established to perpetuate locating the position of the corner:

Removed R.R. spike and perpetuated with standard monument stamped M-5, T12N-R10E. Placed circle stones & pieces of iron around base of monument.  
S50°W 47.38' fnd. spike in E. face 4" x 6" wood cor. post.  
S42°E 52.95' fnd. spike in SW face T. pole stub.  
N75°E 136.15' set T.C. Remon. tag & spike in NW face P. pole.  
S20°E 68.80' set T.C. Remon. tag & spike in W. face 15" Apple.  
North 25'± centerline E-W drain.

Signed by *Kenneth D. Dunton* Date 12-2-98  
Surveyor's Michigan License No. 23503

APPROVED 12-2-98  
*J.P.E.*  
*R.R.B.*  
*J.M.T.*

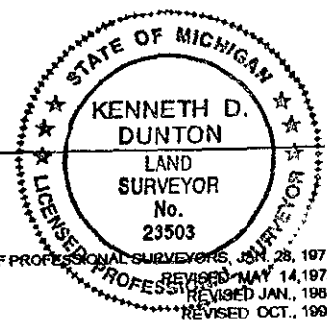

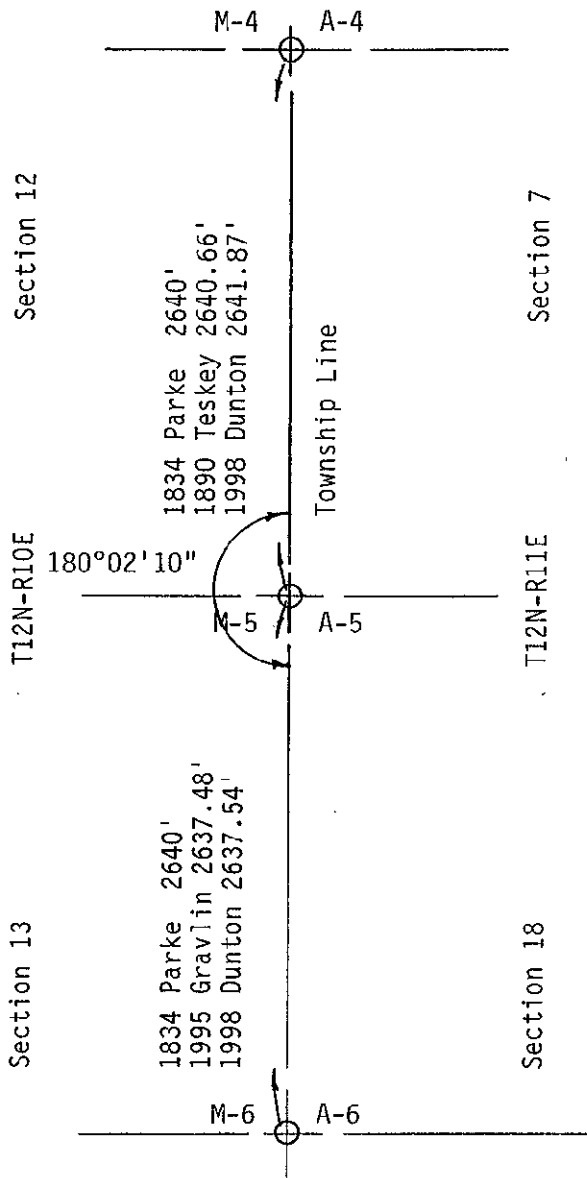

SURVEY &  
REMCALUMENTATION

MAR 02 1999

SECTION