

MAR 02 1999

1998 REMONUMENTATION PROGRAM

LAND CORNER RECORDATION CERTIFICATE
Filing Requirement of Act 74, Mich. P.A. 1970

SECTION
For corners in Kingston Township

<u>Tuscola</u> (County)	Located In:	Corner Code #
1. Public Land Survey	T <u>12N</u> R <u>11E</u>	<u>A-10</u>
	T ___ R ___	_____
	T ___ R ___	_____
	T ___ R ___	_____
2. Property Controlling in Section	S ___ T ___ R ___	_____
	S ___ T ___ R ___	_____
3. Miscellaneous Property in Sec.	S ___ T ___ R ___	_____
	S ___ T ___ R ___	_____

RECEIVED FOR RECORD
LIBER NO. _____ PAGE NO. _____
FILE NO. #74
KINGSTON TWP.
98 DEC 10 PM 4:13
Spencer
TUSCOLA COUNTY
REGISTER OF DEEDS

Register of Deeds Stamp & File Number

4. Lot No. _____, Recorded Plat _____
5. Private Claims _____

I, Kenneth D. Dunton, in a field survey on April 12, 1998 do hereby state that under requirements of P.A. 74, Michigan P.A. of 1970, the corner points mentioned in lines 1 and 2 above were in conformance with regulations and rules therefore as required in the current manual of survey instructions of the United States Department of the Interior, Bureau of Land Management or by a decree of a Court of Law and/or that the corner points mentioned in lines 3, 4 and 5 above were in conformance with the rules of the Michigan Board of Land Surveyors or by a Decree of a Court of Law; established, re-established, monumented, recovered, found as expressed below:

	A	B	C	D	E	F	G	H	I	J	K	L	M
1													
2	6		5		4		3		2		1		
3													
4	7		8		9		10		11		12		
5													
6	18		17		16		15		14		13		
7													
8	19		20		21		22		23		24		
9													
10	30		29		28		27		26		25		
11													
12	31		32		33		34		35		36		
13													

NOTE: Not more than 2 corners, all in the same town and range, may be recorded on this certificate.

A. Description of original monument and accessories and/or subsequent restoration:

G.L.O. Notes Nov. 17, 1834 by H. Parke, D.S., set 1/4 section post, Cedar 14" S6°W .35, Cedar 8" N 2 1/2°W .26. August 22, through 29, 1904 Surveys Pages 30, 31, 60 & 61 and loose leaf copy, Sec. 25, T12N-R10E by L.M. Brumley, County Surveyor, pointed stone 28" x 18" x 9", identified from stake set by A. J. Teskey. Sept. 1906 Survey Pages 96 & 97 of Sec. 30, T12N-R11E by L. M. Brumley, County Surveyor, see Sec. 25, T12N-R10E. Feb. 1973 L.C.R.C. Page 10 by David T. Rowe, P.S. #11192, found nothing, set railroad spike with cross from occupation centerline road east, fence line west and centerline road and ditch right of way, N65°E 99.57' RLS 11192 tag in P.P., S55°W 41.94' RLS 11192 tag in P.P., N60°E 20.9' N. end 40.5' of 60" CMP.

Sec. A con't on back of form.

B. Description of corner evidence found and/or method applied in restoring or reestablishing corner:

Found 1/2" iron rod & cap #24593 along side of large pointed stone (stone approx. 30" x 15" x 10"). Accepted found 1/2" rod and stone as the best evidence of the original corner.

Corner A-10, T12N-R11E is common with Corner M-10, T12N-R10E.

C. Description of monument for corner and accessories established to perpetuate locating the position of the corner:

Removed 1/2" rod & cap and perpetuated with standard monument stamped M-10, T12N-R10E. (Dug around stone, unable to remove, moved ^{stone} 1.5' ± north).
West 66.27' set T.C. Remon. tag & spike in N. face 10" Poplar.
N75°E 73.11' set T.C. Remon. tag & spike in S. face cor. post (old power pole).
N55°E 38.40' fnd. notch atop N. end 40' of 60" CSP.
S60°E 38.18' fnd. notch atop S. end 40' of 60" CSP.
East 4' ± physical centerline N-S gravel road.

Signed by *Kenneth D. Dunton*
Surveyor's Michigan License No. 23503

Date 12-2-98

APPROVED
12-2-98
J.P.E.
J.M.F.

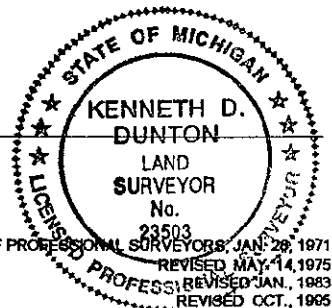

Section A con't.

Feb. 16, 1973 Survey L-2, P-349 by David T. Rowe, P.S. #11192, object and accessories same as L.C.R.C. Page 10. Oct. 14, 1993 Survey L-656, P-327 & 328 by Earl E. Gravlin, P.S. #23510, found 1/2 re-rod, N65°E 7.51' railroad spike, N85°E 73.05' nail in fence post, S50°E 38.17' S. end CMP. Aug. 3, 1995 Survey L-681, P-1378 & 1379 by Earl E. Gravlin, P.S. #23510, same object and accessories as Survey L-656, P-327 & 328.

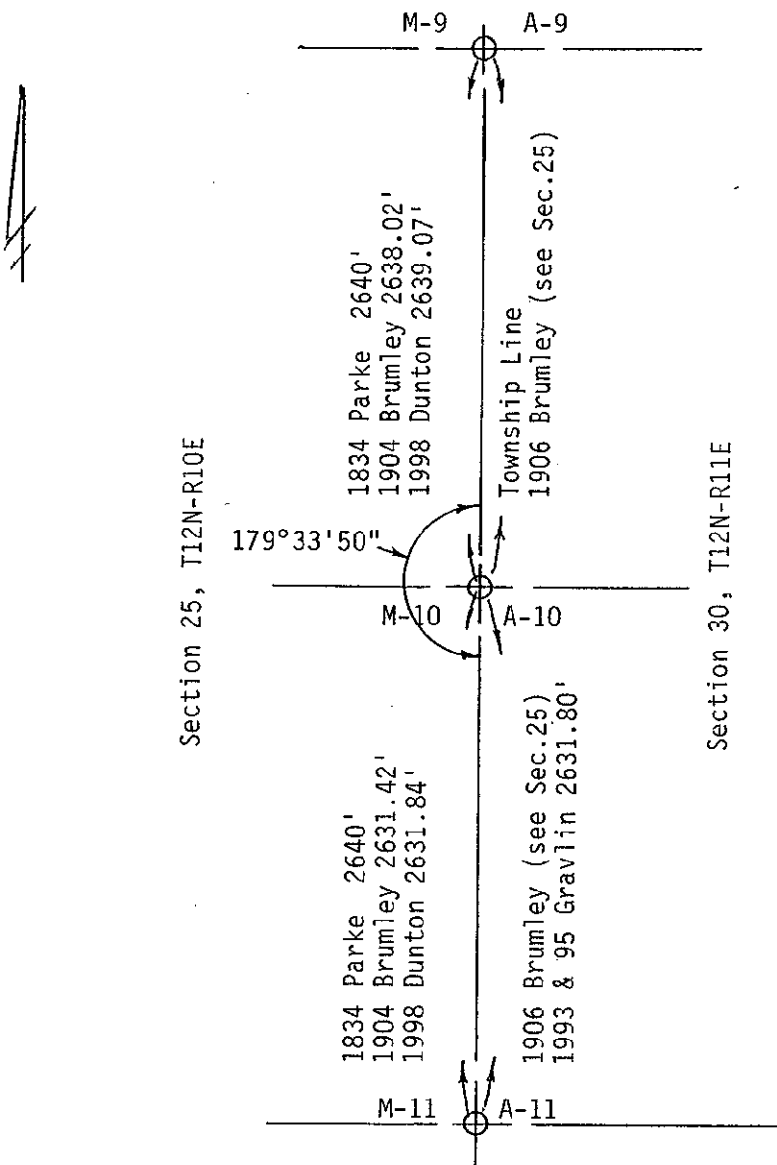

SURVEY &
REMONUMENTATION

MAR 02 1999

SECTION