

MAR 05 1998

SECTION

1997 REMONUMENTATION PROGRAM
LAND CORNER RECORDATION CERTIFICATE
Filing Requirement of Act 74, Mich. P.A. 1970

For corners in Kingston Township

Tuscola
(County)

Located In:

Corner Code #

- | | | | |
|------------------------------------|---|-----------|------|
| 1. Public Land Survey | T | T12NR 11E | E-13 |
| | T | R | |
| | T | R | |
| | T | R | |
| 2. Property Controlling in Section | S | T | R |
| | S | T | R |
| 3. Miscellaneous Property in Sec. | S | T | R |
| | S | T | R |

RECEIVED FOR RECORD
LIBER NO. _____ PAGE NO. _____
FILE NO. #64
57 NOV 12 PM 3:12
TUSCOLA COUNTY REGISTER OF DEEDS
COPY
Register of Deeds Stamp & File Number

4. Lot No. _____, Recorded Plat _____
5. Private Claims _____

I, Kenneth D. Dunton, in a field survey on Sept. 28 1997 do hereby state that under requirements of P.A. 74, Michigan P.A. of 1970, the corner points mentioned in lines 1 and 2 above were in conformance with regulations and rules therefore as required in the current manual of survey instructions of the United States Department of the Interior, Bureau of Land Management or by a decree of a Court of Law and for that the corner points mentioned in lines 3, 4 and 5 above were in conformance with the rules of the Michigan Board of Land Surveyors or by a Decree of a Court of Law; established, re-established, monumented, recovered, found as expressed below:

A	B	C	D	E	F	G	H	I	J	K	L	M
1												
2	6		5		4		3		2		1	
3												
4	7		8		9		10		11		12	
5												
6	18		17		16		15		14		13	
7												
8	19		20		21		22		23		24	
9												
10	30		29		28		27		26		25	
11												
12	31		32		33		34		35		36	
13												

NOTE: Not more than 2 corners, all in the same town and range, may be recorded on this certificate.

A. Description of original monument and accessories and/or subsequent restoration:

March 18, 1834 Hervey Parke, D.S. Set post corner Sections 32 & 33 Hemlock 34" N53°W 2 1/2 links, Beech 10" N86°E 28 links. July 1963 M.S.H.D. witness card, H. G. McManus, Survey Chief, 1" iron. S45°E 44.90' p.p., N55°E 48.75' cor. h.w. store, S30°W 44.95' NW cor. rest. Sept. 9, 1968 M.S.H.D. witness card, R. Fosdick, Survey Chief, 1" iron in monument box. Same accessories as 1963 witness card. Sept. 31, 1971 survey L-1, P-219 by Kay, L.S. #14096. Fnd. iron in Hwy. Dept. mon. box. No accessories given. April 24, 1973 survey L-433, P-166 & 167 by Rowe, L.S. #11192. 1" iron in mon. box. N53°E 48.75' to SW cor. hardware, S45°E 52.40' p.p., S30°W 44.95' NW cor. rest. May 16, 1975 survey L-450, P-475 by Kay, L.S. #14096.

B. Description of corner evidence found and/or method applied in restoring or reestablishing corner:

Found monument box (empty). Found "+" chiseled atop center lug of mon. box cover and two accessories that indicate the "+" found is in the same position as the 1963 witness card. Accepted "+" as the best evidence of the original corner.

C. Description of monument for corner and accessories established to perpetuate locating the position of the corner:

Placed 5/8" iron rod and standard brass cap in mon. box. Stamped cap E-13, T12N-R11E. Encased rod & cap in concrete in mon. box. North 33.08' fnd. 1/2" rod in concrete. N50°E 48.88' SW corner of bottom brick of Barden Hardware store. S35°E 47.69' NE corner of brick building. S25°W 44.87' NW corner of brick building. West 261.98' fnd. 3/4" iron rod in mon. box at apparent cor. E-1, T11N-R11E.

Signed by [Signature]
Surveyor's Michigan License No. 23503

Date 11-10-97

APPROVED
11-10-97
[Signatures]

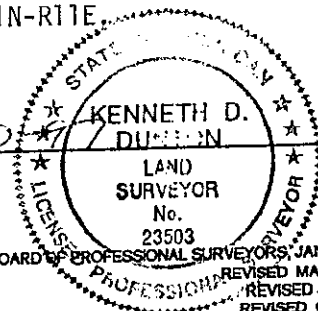

Section A con't from front of form:

Fnd. pipe in mon. box. N45°E 48.72' SW cor. brick building, N45°W 42.07' cor. sign footing, S40°E 47.70' NE cor. store. June 23, 1975 survey L-452, P-598 by Beck, L.S. #21559. 1" iron in mon. box. Same accessories as survey L-433, P-166 & 167. Sept. 23, 1981 survey L-520, P-312 & 313 by Fokens, L.S. #21567. 3" pipe in mon. box. Same accessories as survey L-450, P-475. Dec. 6, 1988 L.C.R.C. Page 43 by Owens, L.S. #20709. Fnd. 3" pipe in monument box. N01°31'49"W 33.00' 4" conc. mon. on E. line Sec. 32, N01°31'49"W 112.98' 4" conc. mon. on E. line Sec. 32, N01°31'49"W 2620.82' cor. E-12, S88°17'36"W 269.96' cor. E-1, T11N-R11E, S88°36'46"W 2643.03' cor. D-13. Sept. 8, 1994 survey L-670, P-1288 & 1289 by Gravin, L.S. #23510. Fnd. 1" iron in mon. box. Accessories same as survey L-452, P-598.

