

SURVEY & REMONUMENTATION

DEC 02 1993

COMMISSION

1993 REMONUMENTATION PROGRAM
LAND CORNER RECORDATION CERTIFICATE
 Filing Requirement of Act 74, Mich. P.A. 1970
 FAIRGROVE TOWNSHIP

For corners in
TUSCOLA
(County)

Located In: Corner Code //

- 1. Public Land Survey T 13N R 8E M-4
 T _____ R _____
 T _____ R _____
 T _____ R _____
- 2. Property Controlling S _____ T _____ R _____
 in Section S _____ T _____ R _____
- 3. Miscellaneous S _____ T _____ R _____
 Property in Sec. S _____ T _____ R _____

- 4. Lot No. _____, Recorded Plat _____
- 5. Private Claims _____

RECEIVED FOR RECORD
 LIBER NO. _____ PAGE NO. 16
 FILING NO. Fairgrove, Mich.
 93 NOV -2 PM 3:55
 VIRGINIA H. MULLER
 TUSCOLA COUNTY
 REGISTER OF DEEDS

Register of Deeds Stamp & File Number

	A	B	C	D	E	F	G	H	I	J	K	L	M
2	6	5	4	3	2	1							
3													
4	7	8	9	10	11	12							
5													
6	18	17	16	15	14	13							
7													
8	19	20	21	22	23	24							
9													
10	30	29	28	27	26	25							
11													
12	31	32	33	34	35	36							
13													

I, Kenneth D. Dunton in a field survey on Aug. 29, 1993, do hereby certify that under requirements of P.A. 74, Michigan P.A. of 1970, the corner points mentioned in lines 1 and 2 above were in conformance with regulations and rules therefore as required in the current manual of survey instructions of the United States Department of the Interior, Bureau of Land Management or by a decree of a Court of Law and/or that the corner points mentioned in lines 3, 4 and 5 above were in conformance with the rules of the Michigan Board of Land Surveyors or by a Decree of a Court of Law; established, re-established, monumented, re-monumented, recovered, found as expressed below:

NOTE: Not more than 4 corners, all in the same town and range, may be recorded on this certificate.

A. Description of original monument and accessories and/or subsequent restoration:

1821 G.L.O. Notes Joseph Wampler, D.S. Set 1/2 mile post Sugar 8" N11°W Sugar 9" S65°E	Nov., 1969 Witness card - source unknown Found large stone 1.6' below surface, replaced with 3/4" rod, set mon. box. No witnesses (about 3' E. of existing centerline). Aug. 5, 1988 Witness Card, Rowe Engineering East 6.70' E. edge pavement West 4.10' centerline pavement S50°E 111.0' MSHD tag in p.p. 3/4" rod in mon. box
--	---

B. Description of corner evidence found and/or method applied in restoring or reestablishing corner:

Found and accepted 7/8" diameter rod & remains of mon. box.
 Found 8" stone at 16" depth with cedar stake along South side of stone.
 East 6.8' E. edge pavement.
 West 3.5' centerline pavement.

C. Description of monument for corner and accessories established to perpetuate locating the position of the corner:

Removed rod, & cedar stake, placed 2" diameter brass cap & 5/8" x 12" rod in new mon. box.
 Encased rod & cap in concrete. Stamped brass cap corner M-4, T13N-R8E.

N16°33'E 163.97' set T. C. Re-mon. tag & spike in NW face t. pole.
 N90°00'E 17.00' set 1/2" x 18" rod & cap #23503.
 S25°17'E 110.88' set T. C. Re-mon. tag & spike over MSHD tag in SW face p. pole.
 S16°56'E 109.31' set T. C. Re-mon. tag & spike in SW corner 4" x 4" wood post.

Signed by _____

Date Oct. 25, 1993

Surveyor's Michigan License No. 23503

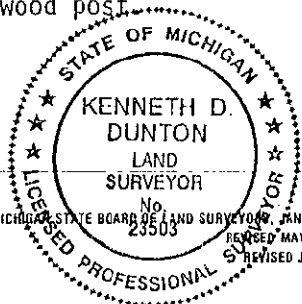

APPROVED
10-25-93
[Signature]

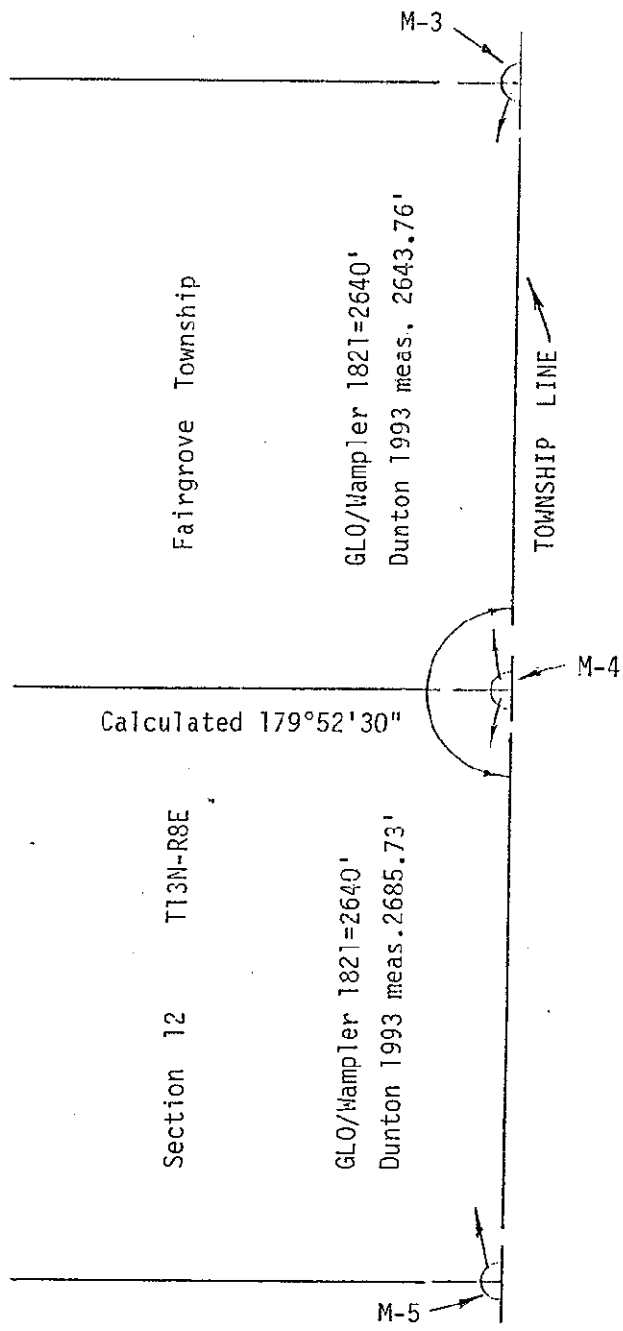

NORTH

NO Scale