

SURVEY & REMONUMENTATION

MAR 02 1999

1998 REMONUMENTATION PROGRAM

SECTION

LAND CORNER RECORDATION CERTIFICATE
Filing Requirement of Act 74, Mich. P.A. 1970

For corners in Almer Twp.

<u>Tuscola</u> (County)	Located In:	Corner Code #
1. Public Land Survey	T13N R9E	M-12
	T___ R___	_____
	T___ R___	_____
	T___ R___	_____
2. Property Controlling in Section	S___ T___ R___	_____
	S___ T___ R___	_____
3. Miscellaneous Property in Sec.	S___ T___ R___	_____
	S___ T___ R___	_____

4. Lot No. _____, Recorded Plat _____
5. Private Claims _____

I, Kenneth D. Dunton, in a field survey on June 5, 1998 do hereby state that under requirements of P.A. 74, Michigan P.A. of 1970, the corner points mentioned in lines 1 and 2 above were in conformance with regulations and rules therefore as required in the current manual of survey instructions of the United States Department of the Interior, Bureau of Land Management or by a decree of a Court of Law and/or that the corner points mentioned in lines 3, 4 and 5 above were in conformance with the rules of the Michigan Board of Land Surveyors or by a Decree of a Court of Law; established, re-established, monumented, recovered, found as expressed below:

NOTE: Not more than 2 corners, all in the same town and range, may be recorded on this certificate.

A. Description of original monument and accessories and/or subsequent restoration:

G.L.O. notes Dec. 28, 1834 by H. Parke, D.S. Set 1/4 section post, Hemlock 26" N16°W 24 links, Hemlock 26" S59°W 19 links. June 15, 1978 Survey L-488, P-884, 885 & 886 by Kenneth D. Dunton, P.S. #23503 with Rowe Engineering, no mention of object found or set or accessories. June 19, 1978, L.C.R.C. Page 30, T13N-R9E by Kenneth D. Dunton, P.S. #23503 set by single proportion, East 66.00' set iron #11192, West 2.08' #11192 tag in 3" Poplar, N05°W 11.47' #11192 tag in 12" Poplar, S05°E 25.40' #11192 tag in 4" Maple clump, East 20'± centerline trail north & south, traces old fence west. June 19, 1978 L.C.R.C. Page 28, T13N-R10E, same accessories as Page 30, T13N-R9E.

Section A con't on back of form.

B. Description of corner evidence found and/or method applied in restoring or reestablishing corner:

Found 1/2" iron rod with cap #11192 & accepted as the best evidence of the original corner.
Corner M-12, T13N-R9E is common with Corner A-12, T13N-R10E.

C. Description of monument for corner and accessories established to perpetuate locating the position of the corner:

Removed 1/2" rod & perpetuated with standard monument stamped M-12, T13N-R9E. Placed carsonite post at monument.
East 66.05' fnd. 1/2" iron rod with cap #11192.
West 20.27' set remon. tag & spike in North face 3" Ironwood.
South 25.38' set remon. tag & spike over #11192 tag fnd. in W. face clump of 5-6" Maples.
West 2.03' set remon. tag & spike over #11192 tag fnd. in N. face 4" Poplar.
N10°W 11.49' set remon. tag & spike over #11192 tag fnd. in West face 12" Poplar.
East 20'± centerline of N-S trail.

Signed by [Signature]
Surveyor's Michigan License No. 23503

Date 11-23-98

APPROVED
11-23-98
J.P.E.
RLB
J.M.A.

RECEIVED FOR RECORD
LIBER NO. _____ PAGE NO. #716
FILE NO. ALMER TWP.
98 NOV 30 PM 3:58
[Signature]
TUSCOLA COUNTY
REGISTER OF DEEDS

Register of Deeds Stamp & File Number

	A	B	C	D	E	F	G	H	I	J	K	L	M
1													
2	6		5		4		3		2		1		
3													
4	7		8		9		10		11		12		
5													
6	18		17		16		15		14		13		
7													
8	19		20		21		22		23		24		
9													
10	30		29		28		27		26		25		
11													
12	31		32		33		34		35		36		
13													

STATE OF MICHIGAN
KENNETH D. DUNTON
LAND SURVEYOR
No. 23503
FORM APPROVED BY MICHIGAN STATE BOARD OF PROFESSIONAL SURVEYORS, JAN. 23, 1971
REVISED MAY 14, 1975
REVISED JAN. 1983
REVISED OCT., 1985

Section A Con't.

June 11, 1979 Survey L-499, P-631, 632 & 633 by James L. Quist, P.S. #25868, no mention of object found or set or accessories. March 31, 1980 survey L-505, P-702 & 703 by Jan S. Fokens, P.S. #21567, no mention of object or accessories. May 25, 1984 survey, L-542, P-377 & 378 by David T. Rowe, P.S. #11192, found 1/2" re-rod #11192, accessories same as L.C.R.C. Page 28, T13N-R10E. Aug. 18, 1995 surveys L-695, P-483 & 484 & 503, through 507 by Jonathan M. Field, P.S. #37276, found 1/2" re-rod with cap #11192, accessories same as survey L-542, P-377 & 378.

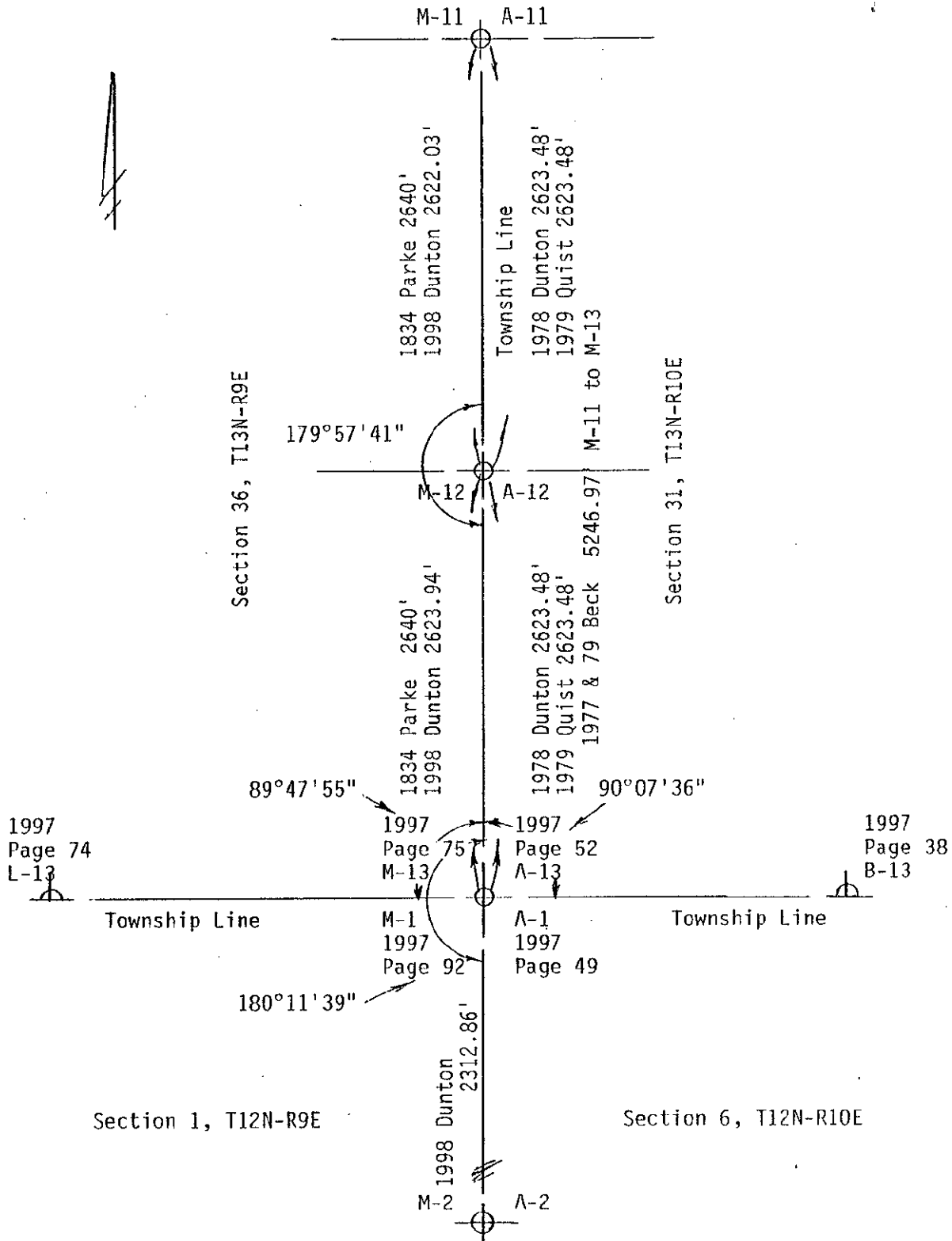

SURVEY &
REMONUMENTATION

MAR 02 1999

SECTION