

DEC 23 2000

COPY

SECTION

1994 REMONUMENTATION PROGRAM  
LAND CORNER RECORDATION CERTIFICATE  
Filing Requirement of Act 74, Mich. P.A. 1970

For corners in NOVESTA TOWNSHIP

TUSCOLA (County)	Located In:	Corner Code #
1. Public Land Survey	T 13N R 11E	M-12
	T _____ R _____	_____
	T _____ R _____	_____
	T _____ R _____	_____
2. Property Controlling in Section	S _____ T _____ R _____	_____
	S _____ T _____ R _____	_____
3. Miscellaneous Property in Sec.	S _____ T _____ R _____	_____

RECEIVED FOR RECORD  
LIBER NO. \_\_\_\_\_ PAGE NO. \_\_\_\_\_  
FILING NO. # 43  
NOV 9 - 9 PM 2:18  
NOV 9 1994  
VIRGINIA H. McLAUREN  
TUSCOLA COUNTY  
REGISTER OF DEEDS

Register of Deeds Stamp & File Number

- 4. Lot No. \_\_\_\_\_, Recorded Plat \_\_\_\_\_
- 5. Private Claims \_\_\_\_\_

	A	B	C	D	E	F	G	H	I	J	K	L	M
2	6	5	4	3	2								
3													
4	7	8	9	10	11	12							
5													
6	18	17	16	15	14	13							
7													
8	19	20	21	22	23	24							
9													
10	30	29	28	27	26	25							
11													
12	31	32	33	34	35	36							
13													

I, Lionel Roy Emery, in a field survey on July 15, 1994, do hereby certify that under requirements of P.A. 74, Michigan P.A. of 1970, the corner points mentioned in lines 1 and 2 above were in conformance with regulations and rules theretofore as required in the current manual of survey instructions of the United States Department of the Interior, Bureau of Land Management or by a decree of a Court of Law and/or that the corner points mentioned in lines 3, 4 and 5 above were in conformance with the rules of the Michigan Board of Land Surveyors or by a Decree of a Court of Law; established, re-established, monumented, re-monumented, recovered, found as expressed below:

**NOTE: Not more than 4 corners, all in the same town and range, may be recorded on this certificate.**

- A. Description of original monument and accessories and/or subsequent restoration:  
 1834 (Gov't. Land Office Notes) Harvey Parke, D.S. -Set qr. Sec. post- Hemlock 8 N17W 23; Hemlock 5 S65W 12  
 1889 (Record of Resurvey of Evergreen Twp., T13N-R12E, Sanilac County) F.F. Rogers, Surveyor Set Vitriified Stone 'corner' 3 inches in diameter and 3 feet in the Earth- gives no accessories

- B. Description of corner evidence found and/or method applied in restoring or reestablishing corner:  
 Dug in roadway and found no remains of previously set markers.  
 Reestablished corner position by single proportion measure.

- C. Description of monument for corner and accessories established to perpetuate locating the position of the corner:  
 Placed Standard Tuscola County Concrete Monument with 2" Brass Cap stamped M12 T13N/R11E  
 N62°E, 47.58' -T.C. Re-mon. tag in Southeast face of 10" Apple  
 S30°E, 52.73' -T.C. Re-mon. tag in Southwest face of 5" Elm  
 S18°W, 22.66' -Set 1/2" Reinforcing rod  
 N43°W, 17.12' -Set 1/2" Reinforcing rod

Signed by Lionel Roy Emery Date Oct. 10, 1994  
 Surveyor's Michigan License No. 24593

APPROVED  
10-10-94  
 JMD  
 Jm7

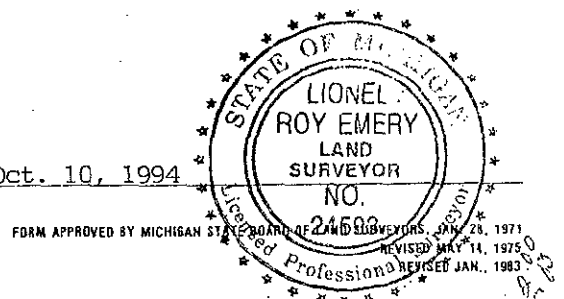

COPY

