

1993

1993 REMONUMENTATION PROGRAM
LAND CORNER RECORDATION CERTIFICATE
Filing Requirement of Act 74, Mich. P.A. 1970

COMMISSION

For corners in

TUSCOLA
(County)

Located In:

S. AKRON TOWNSHIP

Corner Code #/

1. Public Land Survey	T	<u>14N</u>	R	<u>8E</u>	<u>M-3</u>
	T		R		
	T		R		
	T		R		
2. Property Controlling in Section	S		T	R	
	S		T	R	
3. Miscellaneous Property in Sec.	S		T	R	
	S		T	R	

REGISTERED FOR RECORD
LIBRARY PAGE NO. 11
FILMING S. AKRON
99 DEC 10 PM 12:02
MICHIGAN STATE BOARD OF LAND SURVEYORS
TUSCOLA COUNTY
REGISTER OF DEEDS

Register of Deeds Stamp & File Number

4. Lot No. _____, Recorded Plat _____
5. Private Claims _____

	A	B	C	D	E	F	G	H	I	J	K	L	M
2	6	5	4	3	2	1							
3													
4	7	8	9	10	11	12							
5													
6	18	17	16	15	14	13							
7													
8	19	20	21	22	23	24							
9													
10	30	29	28	27	26	25							
11													
12	31	32	33	34	35	36							
13													

I, Kenneth D. Dunton, in a field survey on Sept. 5, 19 93, do hereby certify that under requirements of P.A. 74, Michigan P.A. of 1970, the corner points mentioned in lines 1 and 2 above were in conformance with regulations and rules therefore as required in the current manual of survey instructions of the United States Department of the Interior, Bureau of Land Management or by a decree of a Court of Law and/or that the corner points mentioned in lines 3, 4 and 5 above were in conformance with the rules of the Michigan Board of Land Surveyors or by a Decree of a Court of Law; established, re-established, monumented, re-monumented, recovered, found as expressed below:

NOTE: Not more than 4 corners, all in the same town and range, may be recorded on this certificate.

A. Description of original monument and accessories and/or subsequent restoration:

1821 G.L.O. Notes	April 20, 1970 Act 74, T14N-R8E, Page 12 by John D. Albright, R.L.S. #10057. 5/8" re-rod
Joseph Wampler, D.S.	N.E. cor. Sec. 12 5/8" re-rod
Set post corner Sec. 1 & 12	N.N.E. 97.60' M.S.H.D. tag in t. pole
Elm 11" N14°W 13.86'	East 51.43' M.S.H.D. tag in p. pole
Sugar 5" S35°E 1.32'	West 50.00' M.S.H.D. tag in p. pole
	North 55.0' centerline Ackerman Road

Note: Section A. continued on back of form.

B. Description of corner evidence found and/or method applied in restoring or reestablishing corner:

Found and accepted 5/8" re-rod in existing monument box per Act 74's of record.

COPY

C. Description of monument for corner and accessories established to perpetuate locating the position of the corner:

Placed 2" brass cap stamped corner M-3, T14N-R8E over 5/8" re-rod in existing mon. box. Encased 5/8" rod and cap in concrete.

N03°02'30"E 55.00' found 1/2" rod in mon. box at apparent cor. A-5, T14N-R9E.

S60°08'W 57.86' set T.C. Re-mon. tag & spike above #11192 tag & nail in E. face of p. pole.

N88°12'W 101.46' set T.C. Re-mon. tag & spike in N. face of p. pole.

N85°06'W 48.28' set T.C. Re-mon. tag & spike in N. face of p. pole.

N32°18'E 109.01' set T.C. Re-mon. tag & spike above #11192 tag & nail in W. face of p. pole.

N88°54'E 26.80' set 1/2" x 24" re-rod & cap #23503 at SE corner of conc. curb.

S88°01'30"E 22.00' set p. k. nail & 1" brass disc in asphalt pavement.

Signed by [Signature]

Date Nov. 22, 1993

Surveyor's Michigan License No. 23503

APPROVED
11577-92

FORM APPROVED BY MICHIGAN STATE BOARD OF LAND SURVEYORS, JAN. 28, 1971
REVISED MAY 14, 1975
2003
REVISED JAN., 1983

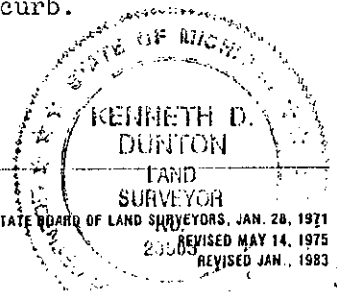

Section A. continued from front of form:

June 3, 1976 & Mar. 11, 1977 Act 74, T14N-R8E, Page 22 by David T. Rowe R.L.S. #11192.
 Found 5/8" re-rod.

North 55.0' to 1/2" re-rod over pipe @ NW cor., Sec. 18, T14N-R9E.

N35°E 97.60' MSHD tag in t.p.

N85°E 51.35' MSHD tag in t.p.

S30°E 91.45' R.L.S. #11192 tag in t.p.

S60°W 57.90' R.L.S. #11192 tag in p.p.

N88°W 48.20' R.L.S. #11192 tag in p.p.

S65°E 59.40' face road sign post.

May 19, 1980 Act 74, T14N-R8E, Page 43 by Douglas W. Hooth, R.L.S. #7966. 5/8" re-rod with R.L.S. tag #11192 as per L.C.R.C. of 3-11-77. 5/8" re-rod in mon. box.

N02°40'E NW cor. Sec. 18, T14N-R9E, 55.02'.

N35°E tele. pole 97.60'.

N85°E tele. pole 51.35'.

S30°E tele. pole 91.45'.

S60°W tele. pole 57.90'.

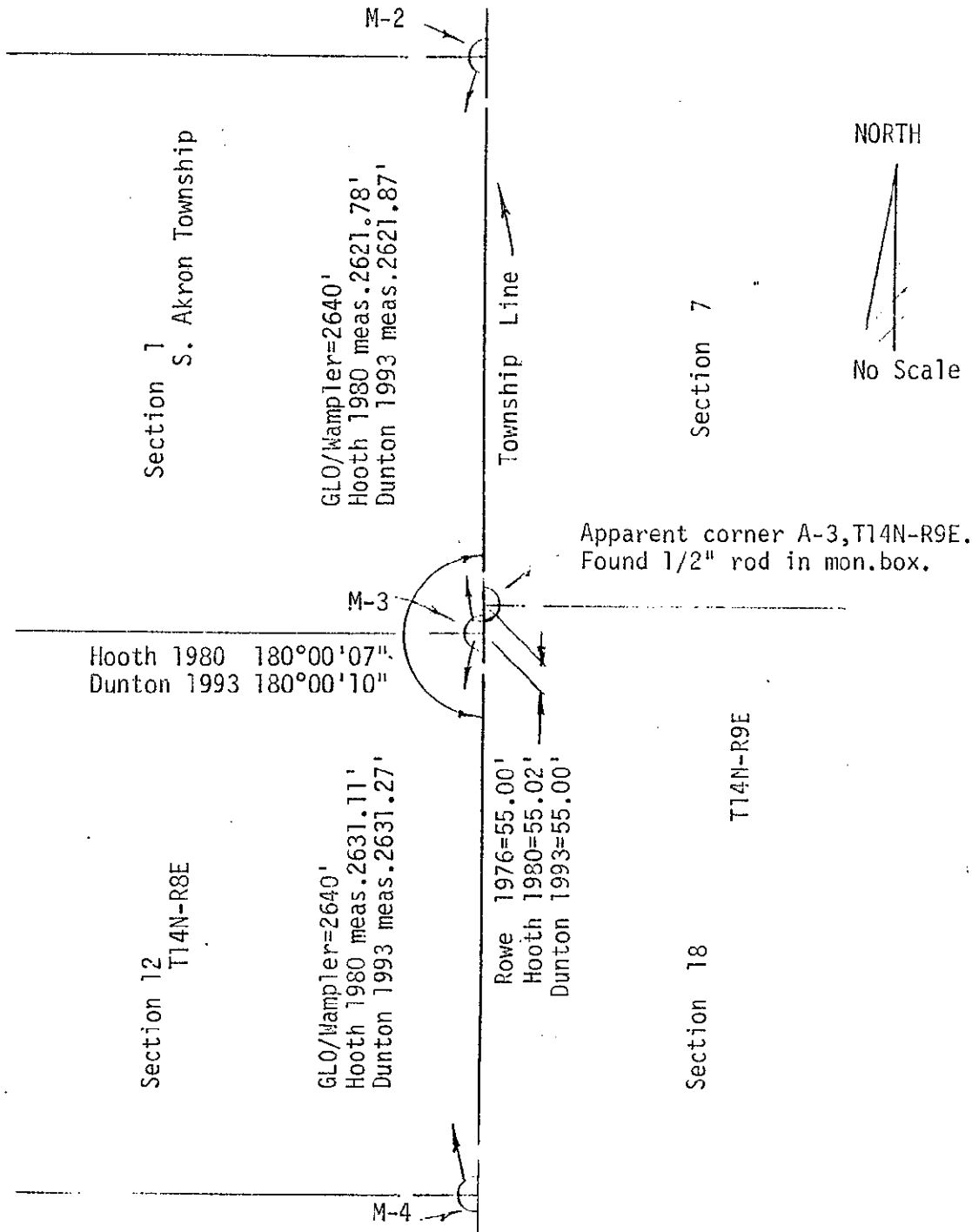

COPY