

1993

COMMISSION

1993 REMONUMENTATION PROGRAM
LAND CORNER RECORDATION CERTIFICATE
Filing Requirement of Act 74, Mich. P.A. 1970
S. AKRON TOWNSHIP

RECEIVED FOR RECORD
LIBER. NO. _____ PAGE NO. 13
FILING NO. S. Akron
03 DEC 10 PM 12:01
VIRGINIA L. HEDGECOCK
TUSCOLA COUNTY
REGISTER OF DEEDS

For corners in

TUSCOLA

(County)

Located In:

Corner Code #

- 1. Public Land Survey T 14N R 8E M-7
- T _____ R _____
- T _____ R _____
- T _____ R _____
- 2. Property Controlling S _____ T _____ R _____
- in Section S _____ T _____ R _____
- 3. Miscellaneous S _____ T _____ R _____
- Property in Sec. S _____ T _____ R _____

Register of Deeds Stamp & File Number

- 4. Lot No. _____, Recorded Plat _____
- 5. Private Claims _____

	A	B	C	D	E	F	G	H	I	J	K	L	M
2	6	5	4	3	2	1							
3													
4	7	8	9	10	11	12							
5													
6	18	17	16	15	14	13							
7													
8	19	20	21	22	23	24							
9													
10	30	29	28	27	26	25							
11													
12	31	32	33	34	35	36							
13													

I, Kenneth D. Dunton in a field survey on Sept. 4, 1993, do hereby certify that under requirements of P.A. 74, Michigan P.A. of 1970, the corner points mentioned in lines 1 and 2 above were in conformance with regulations and rules therefore as required in the current manual of survey instructions of the United States Department of the Interior, Bureau of Land Management or by a decree of a Court of Law and/or that the corner points mentioned in lines 3, 4 and 5 above were in conformance with the rules of the Michigan Board of Land Surveyors or by a Decree of a Court of Law; established, re-established, monumented, re-monumented, recovered, found as expressed below:

NOTE: Not more than 4 corners, all in the same town and range, may be recorded on this certificate.

A. Description of original monument and accessories and/or subsequent restoration:

1821 G.L.O. Notes Oct. 28 & 29, 1867 Survey of Section 24, S. Akron Township by D. E. Cranston, County Surveyor.
 Joseph Wampler, D.S. Measured East line of Section at 79 chains and 25 links (5230.50') NE corner of Section 24 B. Ash 18" Ash 9" N9°E 3.96' S55°W 72 links (47.52')
 Ash 14" S84°W 11.22' B.T. W. Oak 4" N34°W 11 3/4 links (7.755')

Note: Section A. continued on back of form.

B. Description of corner evidence found and/or method applied in restoring or reestablishing corner:

Found & accepted 1/2" re-rod in existing monument box per Act 74, Page 47, T14N-R8E.

C. Description of monument for corner and accessories established to perpetuate locating the position of the corner:

Placed 2" brass cap stamped corner M-7, T14N-R8E over 1/2" rod in existing mon. box.
 Encased rod & cap in concrete.
 S02°40'W 28.32' found 5/8" rod in mon. box at apparent Cor. A-9, T14N-R9E.
 N57°03'W 62.20' South point of concrete project marker.
 S31°28'W 66.95' set 1/2" x 18" rod & cap #23503 at back of conc. curb.
 N73°17'E 36.47' set 1/2" x 18" rod & cap #23503 at back of conc. curb.
 S37°20'E 63.09' set 1/2" x 18" rod & cap #23503 at back of conc. curb.

Signed by [Signature]
Surveyor's Michigan License No. 23503

Date Nov. 15, 1993

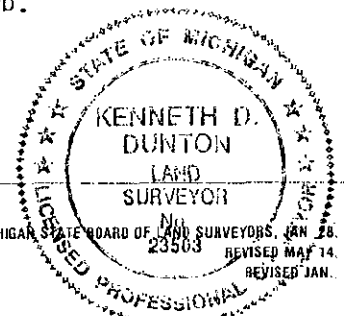

FORM APPROVED BY MICHIGAN STATE BOARD OF LAND SURVEYORS, JAN. 28, 1971
REVISED MAY 14, 1975
REVISED JAN. 1983

APPROVED
11-15-93
[Signature]

Section A. continued.

May 19, 1980 Act 74, Page 47, T14N-R8E by Douglas W. Hooth, R.L.S. #7966 with Mich. Dept. of Trans. Found 1/2" iron rod - agrees with Mich. State Highway Dept. witnesses of 9-15-66 and call for conc. nail & washer.

1/2" iron rod in mon. box.

S02°40'W NW cor. Sec. 30, Columbia Twp. 28.38'.

N65°W South cor. conc. project marker 62.00'.

S54°W wood fe. post 44.37'.

S38°E outside cor. PI conc. hdwl. 77.12'.

N67°E 22" Chinese elm 116.56'.

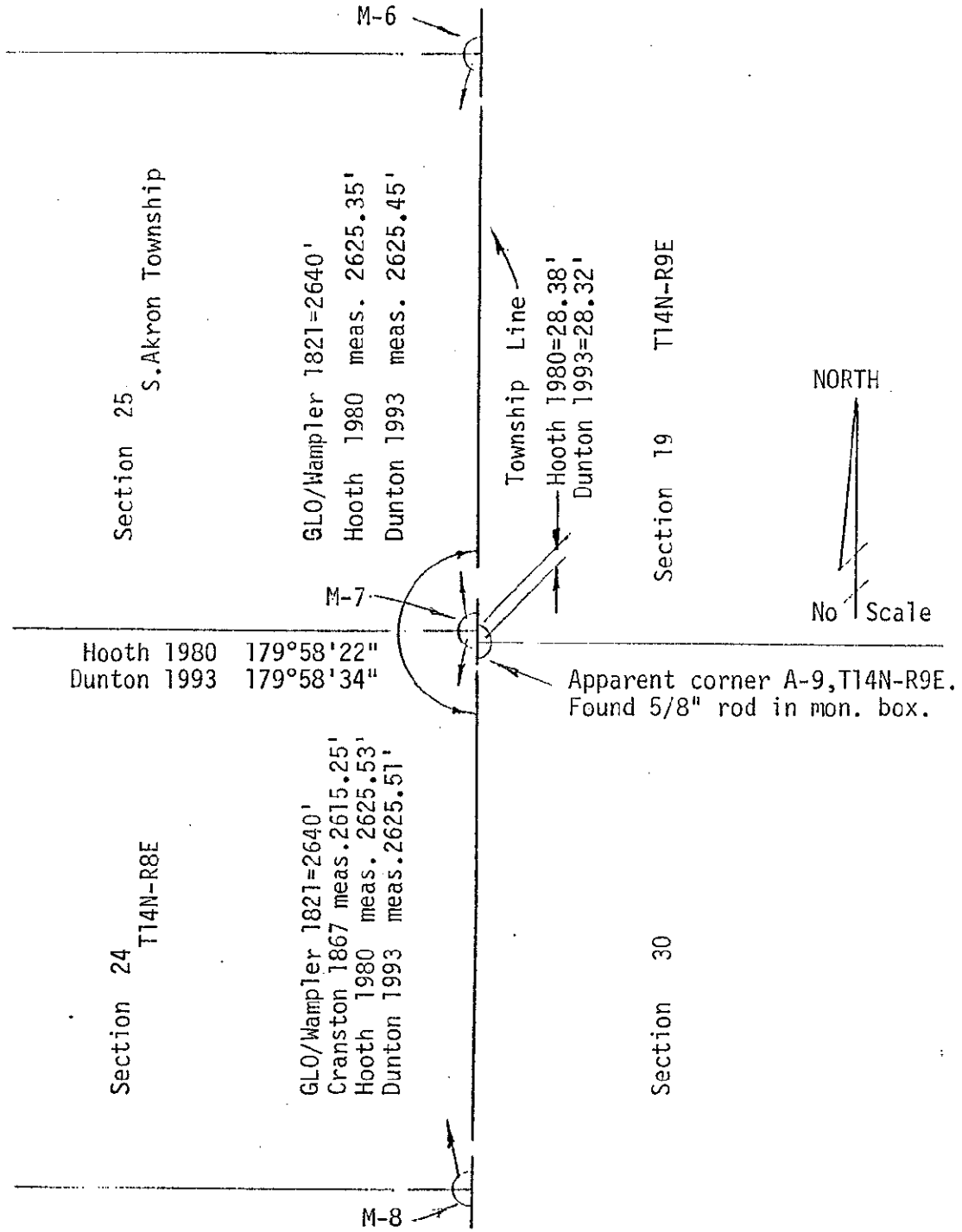

COPY