

1993

COMMISSION

1993 REMONUMENTATION PROGRAM
LAND CORNER RECORDATION CERTIFICATE
Filing Requirement of Act 74, Mich. P.A. 1970
S. AKRON TOWNSHIP

RECEIVED FOR RECORD
LIBER NO. _____ PAGE NO. 22
FILING NO. S. Akron
93 DEC 10 PM 12:01
VIRGINIA H. BALLEW
TUSCOLA COUNTY
REGISTER OF DEEDS

For corners in
TUSCOLA
(County)

Located In: Corner Code: 11

- 1. Public Land Survey T 14N R 8E M-8
T _____ R _____
T _____ R _____
T _____ R _____
- 2. Property Controlling S _____ T _____ R _____
in Section S _____ T _____ R _____
- 3. Miscellaneous S _____ T _____ R _____
Property in Sec. S _____ T _____ R _____

Register of Deeds Stamp & File Number

- 4. Lot No. _____, Recorded Plat _____
- 5. Private Claims _____

	A	B	C	D	E	F	G	H	I	J	K	L	M
2	6		5		4		3		2		1		
3													
4	7		8		9		10		11		12		
5													
6	18		17		16		15		14		13		
7													
8	19		20		21		22		23		24		
9													
10	30		29		28		27		26		25		
11													
12	31		32		33		34		35		36		
13													

I, Kenneth D. Dunton, in a field survey on Sept. 4, 1993, do hereby certify that under requirements of P.A. 74, Michigan P.A. of 1970, the corner points mentioned in lines 1 and 2 above were in conformance with regulations and rules therefore as required in the current manual of survey instructions of the United States Department of the Interior, Bureau of Land Management or by a decree of a Court of Law and/or that the corner points mentioned in lines 3, 4 and 5 above were in conformance with the rules of the Michigan Board of Land Surveyors or by a Decree of a Court of Law; established, re-established, monumented, re-monumented, recovered, found as expressed below:

NOTE: Not more than 4 corners, all in the same town and range, may be recorded on this certificate.

A. Description of original monument and accessories and/or subsequent restoration:

1821 G. L. O. Notes
Joseph Wampler, D.S.
Set 1/2 mile post
Beech 9" N17°W 5.94'
Beech 17" S41°E 8.58'

Oct. 28 & 29, 1867 Survey of Section 24, S. Akron Township by D. E. Cranston, County Surveyor. Measured East line of section at 79 chains & 25 links (5230.50') and the East-West 1/4 line at 79 chains & 47 links (5245.02').
East 1/4 post, Sugar 20" N52 1/2°W 43 1/2 links (28.71').

Note: Section A. continued on back of this form.

B. Description of corner evidence found and/or method applied in restoring or reestablishing corner:

Found and accepted 1" pipe in existing mon. box per Act 74, Page 48, T14N-R8E.

COPY

C. Description of monument for corner and accessories established to perpetuate locating the position of the corner:

Placed 2" brass cap stamped corner M-8, T14N-R8E, atop 1" pipe found in existing mon. box. Encased pipe and cap in concrete.
S02°41'W 50.83' found 3/4" rod in mon. box at apparent cor. A-10, T14N-R9E.
N87°49'W 20.00' set 1/2" x 18" rod & cap #23503 in road shoulder.
S87°49'E 25.00' set 1/2" x 18" rod in road shoulder.
N53°20'E 79.70' chisled notch atop North end C.S.P. culvert.
S69°04'E 96.40' set T. C. Re-mon. tag & spike above bolt found in NE root of 26" maple.
S62°25'E 133.50' NW corner footings of house #4746.

Signed by [Signature]
Surveyor's Michigan License No. 23503

Date Nov. 15, 1993

APPROVED
11-15-93

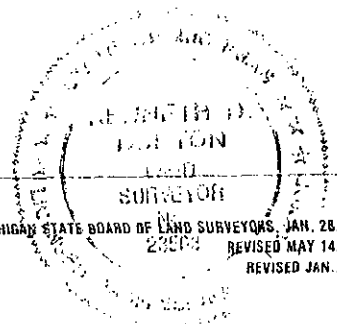

75071

Section A. continued:

May 21, 1980 Act 74, Page 48, T14N-R8E by Douglas W. Hooth, R.L.S. #7966 with Mich. Dept. of Transportation. Dug holes found no evidence of cor. Set cor. by proportionate measure and in line with the SE & NE Sec. corners of Sec. 24, Akron Twp., T14N-R8E.

Set 3/4" iron rod in mon. box.

S02°40'W W 1/4 cor. Sec. 30, T14N-R9E 50.82'.

N88°E cent. chis. □ W. end conc. hdwl. 54.09'.

S70°E 25" maple 98.09'.

S63°E NW cor. house 133.40'.

S78°W t. pole 19.94'.

West edge M-138 2.8'.

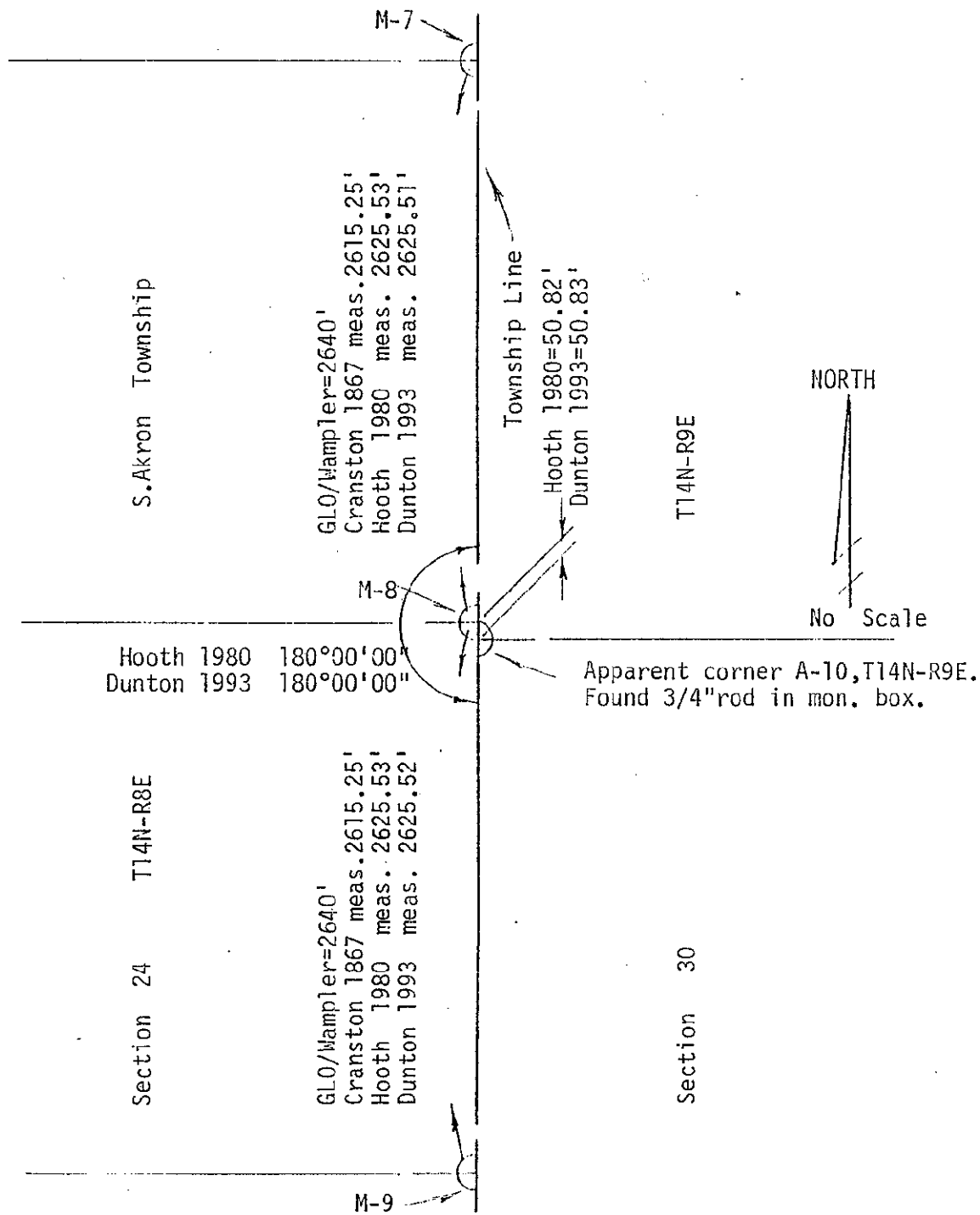

COPY