

1993

COMMISSION

1993 REMONUMENTATION PROGRAM
LAND CORNER RECORDATION CERTIFICATE
Filing Requirement of Act 74, Mich. P.A. 1970

For corners in
TUSCOLA
(County)

Located In:

Corner Code =#

- 1. Public Land Survey T 15N R 8E M-11
- T R _____
- T R _____
- T R _____
- 2. Property Controlling S T R _____
- in Section S T R _____
- 3. Miscellaneous S T R _____
- Property in Sec. S T R _____

RECEIVED FOR RECORD
 LIBERATION PAGE NO. 26
 FILED IN N. Akron
 93 DEC 10 AM 11:55
 MICHIGAN STATE BOARD OF LAND SURVEYORS
 TUSCOLA COUNTY
 REGISTER OF DEEDS

Register of Deeds Stamp & File Number

- 4. Lot No. _____, Recorded Plat _____
- 5. Private Claims _____

	A	B	C	D	E	F	G	H	I	J	K	L	M
2	6	5	4	3	2	1							
3													
4	7	8	9	10	11	12							
5													
6	18	17	16	15	14	13							
7													
8	19	20	21	22	23	24							
9													
10	30	29	28	27	26	25							
11													
12	31	32	33	34	35	36							
13													

I, Kenneth D. Dunton in a field survey on Sept. 6, 19 93
do hereby certify that under requirements of P.A. 74, Michigan P.A. of 1970, the corner points mentioned in lines 1 and 2 above were in conformance with regulations and rules therefore as required in the current manual of survey instructions of the United States Department of the Interior, Bureau of Land Management or by a decree of a Court of Law and/or that the corner points mentioned in lines 3, 4 and 5 above were in conformance with the rules of the Michigan Board of Land Surveyors or by a Decree of a Court of Law; established, re-established, monumented, re-monumented, recovered, found as expressed below:

NOTE: Not more than 4 corners, all in the same town and range, may be recorded on this certificate.

A. Description of original monument and accessories and/or subsequent restoration:

1821 G.L.O. Notes Joseph Wampler, D.S. Set post cor. Sec. 25 & 36 Beech 6" N15°E 13.20' Beech 12" S28°W 13.86'	Nov. 21, 1893 Survey of Section 25, T15N-R8E by G. B. Felton, County Surveyor. Set from cor. Towns 14 & 15N-R9E, said cor. having been set from B.T.'s by Huron County Surveyor. Maple 3" N23 3/4°W 81 links (35.28') Cedar post w. stone 14 x 16 x 18 in. cor.
--	--

Section A. continued on back of form.

B. Description of corner evidence found and/or method applied in restoring or reestablishing corner:

Found and accepted 1" O.D. pipe in existing mon. box per survey of record and MDOT plans.

COPY

C. Description of monument for corner and accessories established to perpetuate locating the position of the corner:

Placed 5/8" x 12" rod and 2" brass cap stamped corner M-11, T15N-R8E over 1" O.D. pipe in existing mon. box. Encased pipe, rod & cap in concrete.
 S40°43'E 111.19' set T.C. Re-mon. tag & spike over MDOT tag in SW face p. pole.
 S32°45'W 95.72' set T.C. Re-mon. tag & spike over MDOT tag in SE face p. pole.
 S02°52'30"W 110.80' found boat spike in mon. box apparent corner A-1, T14N-R9E.
 S70°56'E 34.86' found "+" chiseled atop westerly re-rod at top of conc. proj. marker.
 S86°57'E 20.00' set 1/2" x 24" re-rod & cap #23503 in road shoulder.

Signed by [Signature] Date Dec. 6, 1993
 Surveyor's Michigan License No. 23503

APPROVED
12-6-93 [Signature]

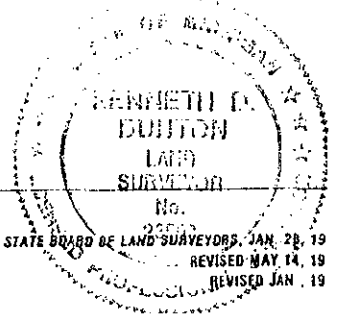

Section A. continued from front of form:

April 11, 1984 Survey Liber 548, Page 52 by Kenneth D. Dunton, R.L.S. #23503. Found 1" pipe in mon. box.

- S80°E 34.6' FAS road marker
- S35°W 95.72' p. k. in p.p.
- Centerline Loomis Rd. to West

1991 (approx.) MDOT plans Job #26700A, Sheet 12.

- 3/4" pipe in mon. box.
- S30°W 95.77' p. pole
- S70°E 34.83' chis. "x" on re-rod top of conc. proj. marker.
- S35°E 111.18' p. pole.
- S80°W 66.44' S. flange of steel stop sign post.

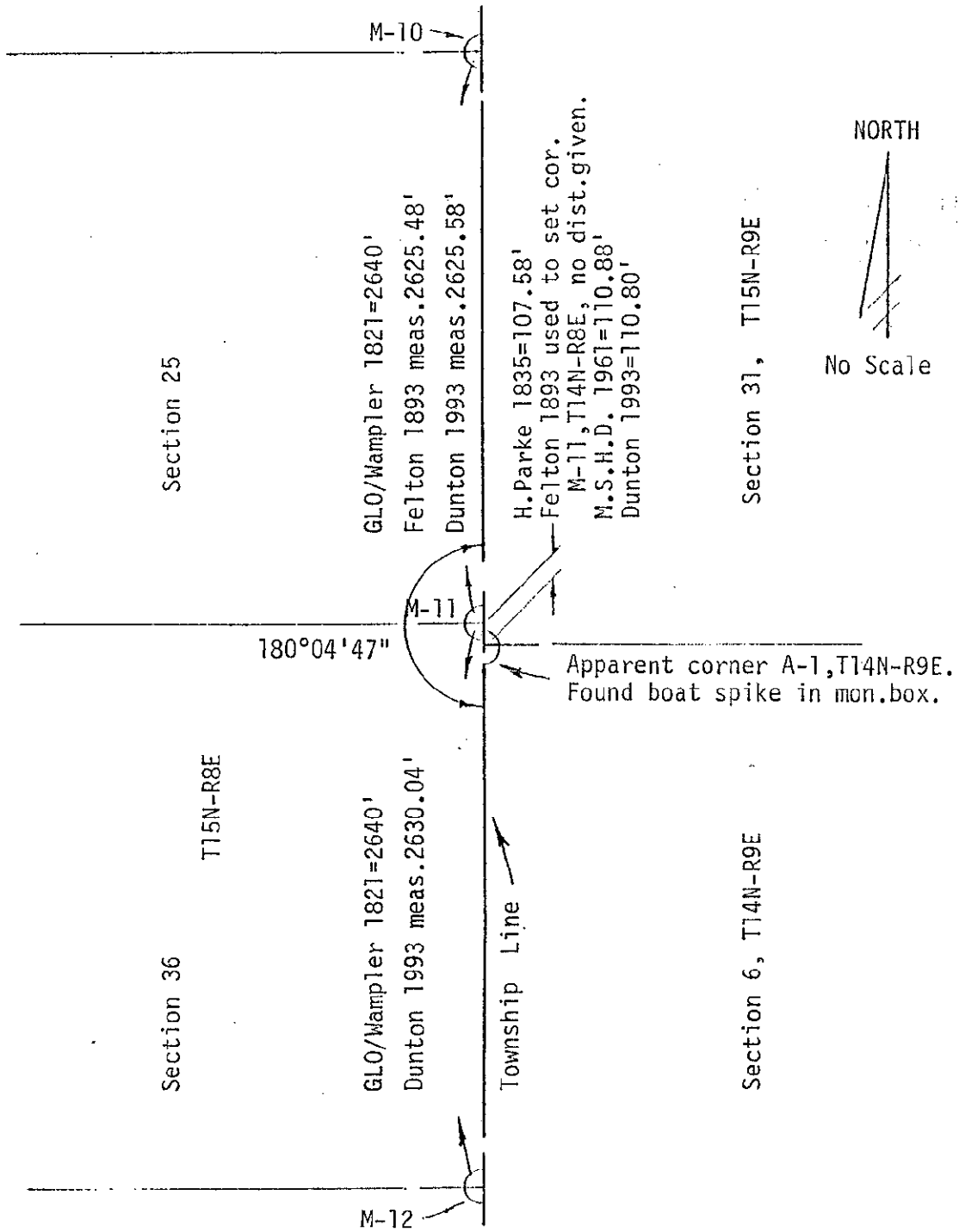

COPY