

JAN 14 1998

VAN BUREN COUNTY REMONUMENTATION LAND CORNER RECORDATION CERTIFICATE

Dec 16 12 00 PM '97

SECTION

Filing Requirement of Act 74, Mich. P.A. 1970

For corners in VAN BUREN COUNTY Located in: COLUMBIA TWP. E 1/4 COR. SEC 7 T1S,R15W Corner ID # W1/4 COR. SEC8 T1S,R15W

Mark A. Smith

- 1. Public Land Survey T 1S R 15W C-4
2. Property Controlling in Section S T R
3. Miscellaneous Property in Sec. S T R
4. Lot No. Recorded Plat
5. Private Claims

Liber 5 PAGE 53 Register of Deeds Stamp & File Number

I, Alan Bartlett in a field survey on November 25 1997 hereby certify that under requirements of P.A. 74, Michigan P.A. of 1970, the corner points mentioned in lines 1 and 2 above were in conformance with regulations and rules therefore as required in the current manual of survey instructions of the United States Department of the Interior, Bureau of Land Management or by a decree of a Court of Law and/or that the corner points mentioned in lines 3, 4 and 5 above were in conformance with the rules of the Michigan Board of Land Surveyors or by a Decree of a Court of Law; established, re-established, monumented, re-monumented, recovered, found as expressed below:

Grid table with columns A-M and rows 2-13. Cell 4,8 contains a star symbol.

NOTE: Not more than 4 corners, all in the same town and range, may be recorded on this certificate.

A. Description of original monument and accessories and/or subsequent restoration:

2/6/1830 NORTH BETWEEN SECTION 7 & 8 40.00 CHAINS SET 1/4 SEC. POST
10/15/1901 W.H. GOSS DEP. COUNTY SURVEYOR BOOK 1 PAGE 88 FOUND BOTTOM OF FENCE POST SAID BY BEN SMITH (AN OLD RESIDENT) TO BE ON CORNER STUMP OF PINE FOUND 5 LINKS SOUTH GOVT. NOTES.
WITNESSES HEMLOCK 13" SOUTH 5 LINKS PINE 11" N65°E 35 LINKS
4/2/1914 SET STAKE, STONE, AND BRICK BOOK 7 PAGE 194 WITNESS CHERRY 7" S84°E 40 1/2 LINKS
11/17/1997 LANDMARK TECH. ALAN BARTLETT RLS #35988 FOUND POINTED SQ. IRON WITH BROKEN BRICK. 3' WEST OF CENTER LINE, OCCUPATION E & W WITNESSES N85°E 27.65' DBL HEADED NAIL N SIDE TEL. POLE EAST 33.05' FOUND IRON PIPE 1/2" DIA WEST 33.09' FOUND CAPPED IRON #19618 N35°W 32.00' FOUND NAIL IN SW FACE 21" MAPLE

Ratified by Peer Group in accordance with P.A. 345 of 1990 Van Buren County Surveyor Date D. B. L. 12/16/97

B. Description of corner evidence found and/or method applied in restoring or reestablishing corner:

FOUND POINTED SQ. IRON WITH BROKEN BRICK AROUND. VERIFIED CORNER LOCATION USING EXISTING WITNESSES. THIS GOVERNMENT MONUMENT WAS RESTORED WITH APPROVAL OF THE VAN BUREN COUNTY REMONUMENTATION PEER GROUP OF SURVEYORS NOVEMBER 19, 1997

C. Description of monument for corner and accessories established to perpetuate locating the position of the corner:

SET 3 1/2" HARRISON MONUMENT IN GRAVEL ROAD 3' WEST OF CENTER LINE, AT OCCUPATION, DOWN 1.2' BELOW SURFACE. WITNESSES N85°E 27.65' DBL HEADED NAIL NORTH SIDE OF TELEPHONE POLE EAST 33.05' FOUND IRON PIPE 1/2" DIA WEST 33.09' FOUND CAPPED IRON #19618 N35°W 32.00' FOUND NAIL IN SW FACE OF 21" MAPLE

CORNER IS ACCEPTED AS A CAREFUL AND FAITHFUL PERPETUATION OF THE POSITION OF THE ORIGINAL CORNER

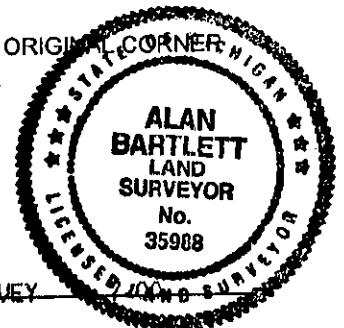

Signed by Alan B. Bartlett Surveyor's Michigan License No. 35988

Date 12/15/97