

JAN 14 1998

VAN BUREN COUNTY REMONUMENTATION LAND CORNER RECORDATION CERTIFICATE Filing Requirement of Act 74, Mich. P.A. 1970

Dec 16 12 00 PM '97

Mark A. Smith VAN BUREN COUNTY SURVEYOR

SECTION

For corners in VAN BUREN COUNTY Located in: GENEVA TWP. Corner ID # E 1/4 COR. SEC 13 T1S,R16W

- 1. Public Land Survey T 1S R 16W M-6
2. Property Controlling in Section S T R
3. Miscellaneous Property in Sec. S T R
4. Lot No., Recorded Plat
5. Private Claims

Liber 5 Page 50

Register of Deeds Stamp & File Number

Grid table with columns A-M and rows 2-13 containing numbers 1-36.

I, Alan Bartlett in a field survey on December 2 1997 hereby certify that under requirements of P.A. 74, Michigan P.A. of 1970, the corner points mentioned in lines 1 and 2 above were in conformance with regulations and rules therefore as required in the current manual of survey instructions of the United States Department of the Interior, Bureau of Land Management or by a decree of a Court of Law and/or that the corner points mentioned in lines 3, 4 and 5 above were in conformance with the rules of the Michigan Board of Land Surveyors or by a Decree of a Court of Law; established, re-established, monumented, re-monumented, recovered, found as expressed below:

NOTE: Not more than 4 corners, all in the same town and range, may be recorded on this certificate.

A. Description of original monument and accessories and/or subsequent restoration:

5/15/1827 WM. BROOKFIELD NORTH ON EAST BOUNDARY OF SECTION 13 40.00 SET QUARTER SECTION POST WITNESSES BEECH 13" S75 1/2 W 22 LINKS

4/15/1952 BOOK 54 NOTES SHOW 2606.2' NORTH TO NORTHEAST CORNER AND 2638.34' SOUTH TO SOUTHEAST CORNER NOTES SHOW ANGLE 89°54'30" FROM CENTER TO NORTHEAST CORNER. NOTES SHOW ANGLE 89°31'35" FROM SOUTHEAST CORNER TO CENTER

12/2/97 LANDMARK TECH. ALAN BARTLETT RLS #35988 FOUND 3/4" X 18" REBAR 2.0' WEST OF CENTER LINE OF COUNTY ROAD 681 WITNESSES S70°E 38.87' 1" ANGLE IRON FLUSH WITH GROUND S10°E 123.33' SET NAIL AND FLASHER IN 9" CEDAR SOUTH 25.59' WEST 1/4 OF SECTION 18 T1S,R15W S35°W 43.53' SET NAIL AND FLASHER IN 8" APPLE N90°W 33.69' 1" IRON PIPE W/CAP #2382

Ratified by Peer Group in accordance with P.A. 345 of 1990 Van Buren County Surveyor

Date D. R. G. 12/16/97

B. Description of corner evidence found and/or method applied in restoring or reestablishing corner:

FOUND 3/4" REBAR IN PAVEMENT. VERIFIED CORNER LOCATION USING EXISTING WITNESSES. THIS GOVERNMENT MONUMENT WAS RESTORED WITH APPROVAL OF THE VAN BUREN COUNTY REMONUMENTATION PEER GROUP OF SURVEYORS NOVEMBER 19 1997.

C. Description of monument for corner and accessories established to perpetuate locating the position of the corner:

SET 2 1/2" HARRISON MONUMENT AND MONUMENT BOX 34.2' NORTH OF DRIVE EAST, 50.5' NORTH OF DRIVE WEST AND 2.0' WEST OF CENTER LINE OF COUNTY ROAD 681. WITNESSES S70°E 38.87' 1" ANGLE IRON FLUSH WITH GROUND S10°E 123.33' SET NAIL AND FLASHER IN 9" CEDAR SOUTH 25.59' WEST 1/4 CORNER OF SECTION 18 T1S,R15W S35°W 43.53' SET NAIL AND FLASHER IN 8" APPLE N90°W 33.69' 1" IRON PIPE W/CAP #2382

CORNER IS ACCEPTED A CAREFUL AND FAITHFUL PERPETUATION OF THE POSITION OF THE ORIGINAL CORNER

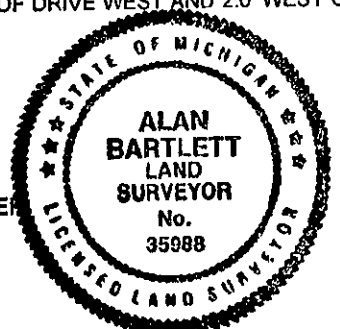

Signed by Alan K. Bartlett Surveyor's Michigan License No. 35988

Date 12/15/97 1478 12/16 0101 10 SURVEY 7-00