

FILED

LAND CORNER RECORDATION CERTIFICATE

FILING REQUIREMENT OF ACT 74, MICH. P.A. 1970

Dec 16 9 20 AM '99

SW CORNER SEC 13, ARLINGTON TWP.

FOR CORNERS OF: LOCATED IN: CORNER CODE NUMBER
1. PUBLIC LAND SURVEY T. 2 S., R. 15 W. X X K-7
2. PROPERTY CONTROLLING IN SECTION N. E.
3. MISCELLANEOUS PROPERTY IN SECTION N. E.
4. LOT NO. RECORDED PLA.
5. PRIVATE CLAIMS

REGISTER OF DEEDS STAMP AND FILING NUMBER
Van Buren Co. REGISTER OF DEEDS
MAY 1999

I, Charles D. Lossie, in a field survey on 09-Dec, 19 99 do hereby state that under requirements of P.A. 74, Michigan P.A. of 1970, the corner points mentioned in lines 1 and 2 above were in conformance with regulations and rules therefore as required in the current manual of survey instructions of the United States Department of the Interior, Bureau of Land Management or by a decree of a Court of Law and/or that the corner points mentioned in lines 3, 4 and 5 above were in conformance with the rules of the Michigan Board of Land Surveyors or by a Decree of a Court of Law; established, re-established, monumented, recovered, found as expressed below:

Grid table with columns A-M and rows 1-13. A dot is marked at row 7, column J.

NOTE: Not More than 2 corners, all in the same town and range may be recorded on this certificate.

A. Description of original monument and accessories and/or subsequent restoration:

1/1830 - GOVERNMENT - G.W. HARRISON, D.S.
Ran North between Sections 23 and 24 a distance of 80.00 chs. (5280.00') and set post corner.
Witnesses:
8" Beech - S. 50° W., 12 lks (7.92')
5" Beech 0 N. 68° E., 5 lks. Or 15 lks?
Distance West is 80.19 chs (5292.54')
Distance East is 79.88 chs. (5272.08')

See Back for additional History.

B. Description of corner evidence found and/or method applied in restoring or re-establishing corner:

Found drag tooth and 2 stones. The position of this Government Monument was accepted and restored with the approval of the Van Buren County Remonumentation Peer Group of Surveyor's on 5/26/99 as the best available evidence of the position of the original corner.

Ratified by Peer Group in accordance with P.A. 345 of 1990
Van Buren County Surveyor
Date 12-16-99 D. R. S.

C. Description of monument for corner and accessories established to perpetuate locating the position of the corner:

Set Harrison Marker at the position of the drag tooth and stones.
32" Maple S. 30° E., 86.94' to PK and Washer.
6" Maple S. 80° W., 106.86' to PK and Washer.
Power Pole, N. 20° W., 107.06' to PK and Washer.
SW corner house, N. 45° E., 85.67'.
USGS standard bass marker Set in concrete. Stamped PT STA# 6191926
N. 45° E., 36.15'.

Signed by Charles D. Lossie
CHARLES D. LOSSIE, P.S.

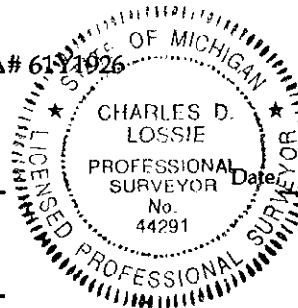

Surveyor's Michigan License No. 44291

FORM APPROVED BY MICHIGAN STATE BOARD OF PROFESSIONAL SURVEYORS, JAN. 23, 1971
REVISED MAY. 3, 1975
REVISED JAN., 1983
REVISED OCT., 1996

Lib 5 Ag. 280

*L. Lee S PG 281*

**SW Corner, Sec 13  
T2S, R15W, Arlington Twp., (K-7)**

**5/2/1907 - W. H. GOSS, C.S.**

Section 23  
Red Book and Goss Notes.  
Stones & iron.

**Witnesses:**

5" Cherry - SE 101.5 lks. (66.99')  
House - NE 129.5 lks. (85.47').  
Distance West is 39.88 chs. (2632.08') - Mile is 79.76 chs. (5264.16')

**5/21/1940 - T.A. SMITH, C.S.**

Section 24  
Drawings shows Eighth Post to the East and distance East is 1308.25' and continuing East 2616.5'.

**3/15/1957 - W.Q. SMITH, C.S.**

Section 23  
Drawing shows corner.  
Distance West is 1314.55' and continuing West 1314.55' for a total of 2629.10'.  
Distance South is 2626.00'.

**3/2/1976- ALTON HOWARD, R.L.S.**

Section 23  
Drawing shows corner.  
Distance West is 1314.04' and continuing West 1314.55' for a total of 2629.10'.  
Distance South is 2626.00'.

**3/16/1992 - J.C. HUNT, P.S.**

Section 24  
Recorded Survey (Liber 9 - Page 300).  
Found 1 1/4" iron bar 2.5' South of Centerline of East and West Road in line with Centerline of Road to North and 6' West of Centerline of Road to South.

**Witnesses:**

N. 45° E., 85.50' to Southwest corner of foundation of house.  
S. 45° W., 28.40' to South end of 42" C.M.P.  
N. 30° W., 34.00' to North end of 42" C.M.P.  
S. 25° E., 86.78' to nail in West face of 30" Maple.

6/10/1992 - Recordation Certificate (Liber 3 - Page 229)

Same as above.

**SURVEY &  
RECORDATION**

**1992**

**1992**